



# J.M. O'REILLY & ASSOCIATES, INC.

PROFESSIONAL ENGINEERING, LAND SURVEYING & ENVIRONMENTAL SERVICES

Site Development • Property Line • Subdivision • Sanitary • Land Court • Environmental Permitting

November 8, 2021

JMO-4249A

Harwich Conservation Commission  
732 Main Street  
Harwich, MA 02645

RE: **Notice of Intent – Proposed Seasonal Dock**  
0 Pleasant Lake Ave (Parcel ID: 101-P1-0)  
Applicants & Owners: Jonathan & Maureen Ellis, Trs  
Bruce & Mary Catherine Ring, Trs

Dear Commission Members,

On behalf of our clients Jonathan and Maureen Ellis and Bruce and Mary Catherine Ring, J.M. O'REILLY & ASSOCIATES, INC. is submitting the attached Notice of Intent, Site Plan for the installation and maintenance of a seasonal dock within the waters of Long Pond, at the above referenced property.

## **Wetland Resource:**

The property abuts Long Pond (a Great Pond) to the north and also contains a vegetated wetland area, adjacent to the back side of the beach area. The upper boundary of the vegetated wetland has been flagged in the field and is as shown on the attached site plan. Please refer to the Plan for the location of the 50' and 100' Buffer Zones.

## **Narrative:**

The purpose of the Notice of Intent is to seek and obtain the local approval of a seasonal dock structure within Long Pond. The Harwich approval will be followed by an application to the MA DEP Waterways for the license of the proposed structure.

Long Pond is the common boundary between Harwich and Brewster. The Pond is the largest freshwater pond within both the towns. Long Pond is the only pond within the two towns which allows for the larger and faster boats which allows for water skiing and tubing activities. The Pond also is enjoyed by small sailing boats, canoes and kayaks activities. The Pond's bottom within the area of the dock is sandy with little vegetation.

The proposed dock is constructed out of aluminum. The Dock consists of "H" bracket posts which sit on 10" x 10" aluminum pads, which in turn rest on the pond's bottom. No pile or support is proposed to be jetted or drilled into the pond's bottom. A total of 26 alum. pads are proposed to support the dock (18 sf +/-). The entire frame and support posts of the dock will be aluminum. The decking for the dock will be wooden. The spacing between the decking is proposed to 3/8". Please refer to the enclosed pictures of the existing structure.

The dock extends into the waters of Long Pond about 78 feet from the shore. The end of the dock consists of an "L" shape landing which is about 12 feet by 8 feet (96 sf). The area of the proposed dock is about 288 sf +/- (not including the 12' x 8' landing). The depth of the water at the end of the dock is about 5 feet. The water within the pond is higher than can be anticipated during the summer months. The 5 feet of depth at the end of the dock will most likely be about 3 ½ to 4 feet of water depth during the summer months. The water depth also provides sufficient depth for the boat to motor (no wake) to and from the dock.

**Variance:**

The existence of the dock within the waters of Long Pond requires that the Applicant seek and obtain a variance from the Town of Harwich Wetland Regulations. The variance is required due to the activity within a wetland resource. The proposed dock is designed to be within compliance with the regulations governing freshwater a dock.

A representative from our office will be present at your December 1, 2021 meeting so as to discuss the project in greater detail and to answer any questions the Commission may have. Please contact my office directly if you have any questions or need any additional information.

Very truly yours,  
J.M. O'REILLY & ASSOCIATES, INC.



John M. O'Reilly, P.E., P.L.S.  
Principal

CC: MA DEP, NHESP, Client



Massachusetts Department of Environmental Protection  
Bureau of Resource Protection - Wetlands

# WPA Form 3 – Notice of Intent

Massachusetts Wetlands Protection Act M.G.L. c. 131, §40

Provided by MassDEP:

MassDEP File Number

Document Transaction Number

Harwich

City/Town

**Important:**  
When filling out forms on the computer, use only the tab key to move your cursor - do not use the return key.



**Note:**  
Before completing this form consult your local Conservation Commission regarding any municipal bylaw or ordinance.

## A. General Information

1. Project Location (**Note:** electronic filers will click on button to locate project site):

0 Pleasant Lake Avenue	Harwich	02645
a. Street Address	b. City/Town	c. Zip Code
Latitude and Longitude:	41.717320	-70.086350
	d. Latitude	e. Longitude
101	P1-1	
f. Assessors Map/Plat Number	g. Parcel /Lot Number	

2. Applicant:

Jonathan & Maureen Ellis	Bruce & Mary Catherine Ring, Trs	
a. First Name	b. Last Name	
c. Organization		
1 Clark Road		
d. Street Address		
Milton	MA	02186
e. City/Town	f. State	g. Zip Code
781-424-9234	mfellis@comcast.net	
h. Phone Number	i. Fax Number	j. Email Address

3. Property owner (required if different from applicant):  Check if more than one owner

Same		
a. First Name	b. Last Name	
c. Organization		
d. Street Address		
e. City/Town	f. State	g. Zip Code
h. Phone Number	i. Fax Number	j. Email address

4. Representative (if any):

John	O'Reilly	
a. First Name	b. Last Name	
J.M. O'Reilly & Associates, Inc.		
c. Company		
1573 Main Street		
d. Street Address		
Brewster	MA	02631
e. City/Town	f. State	g. Zip Code
508-896-6601	508-896-6602	joreilly@jmoreillyassoc.com
h. Phone Number	i. Fax Number	j. Email address

5. Total WPA Fee Paid (from NOI Wetland Fee Transmittal Form):

288.00	131.50	156.50
a. Total Fee Paid	b. State Fee Paid	c. City/Town Fee Paid



Massachusetts Department of Environmental Protection  
Bureau of Resource Protection - Wetlands

**WPA Form 3 – Notice of Intent**

Massachusetts Wetlands Protection Act M.G.L. c. 131, §40

Provided by MassDEP:

MassDEP File Number

Document Transaction Number

Harwich

City/Town

**A. General Information (continued)**

6. General Project Description:

Install and maintain a seasonal dock in the waters of Long Pond

7a. Project Type Checklist: (Limited Project Types see Section A. 7b.)

- 1.  Single Family Home
- 2.  Residential Subdivision
- 3.  Commercial/Industrial
- 4.  Dock/Pier
- 5.  Utilities
- 6.  Coastal engineering Structure
- 7.  Agriculture (e.g., cranberries, forestry)
- 8.  Transportation
- 9.  Other

7b. Is any portion of the proposed activity eligible to be treated as a limited project (including Ecological Restoration Limited Project) subject to 310 CMR 10.24 (coastal) or 310 CMR 10.53 (inland)?

- 1.  Yes  No      If yes, describe which limited project applies to this project. (See 310 CMR 10.24 and 10.53 for a complete list and description of limited project types)

2. Limited Project Type

If the proposed activity is eligible to be treated as an Ecological Restoration Limited Project (310 CMR10.24(8), 310 CMR 10.53(4)), complete and attach Appendix A: Ecological Restoration Limited Project Checklist and Signed Certification.

8. Property recorded at the Registry of Deeds for:

Barnstable

a. County

31879

c. Book

b. Certificate # (if registered land)

38

d. Page Number

**B. Buffer Zone & Resource Area Impacts (temporary & permanent)**

- 1.  Buffer Zone Only – Check if the project is located only in the Buffer Zone of a Bordering Vegetated Wetland, Inland Bank, or Coastal Resource Area.
- 2.  Inland Resource Areas (see 310 CMR 10.54-10.58; if not applicable, go to Section B.3, Coastal Resource Areas).

Check all that apply below. Attach narrative and any supporting documentation describing how the project will meet all performance standards for each of the resource areas altered, including standards requiring consideration of alternative project design or location.



**Massachusetts Department of Environmental Protection**  
 Bureau of Resource Protection - Wetlands

**WPA Form 3 – Notice of Intent**

Massachusetts Wetlands Protection Act M.G.L. c. 131, §40

Provided by MassDEP:

MassDEP File Number

Document Transaction Number

Harwich

City/Town

**B. Buffer Zone & Resource Area Impacts (temporary & permanent) (cont'd)**

For all projects affecting other Resource Areas, please attach a narrative explaining how the resource area was delineated.

Resource Area	Size of Proposed Alteration	Proposed Replacement (if any)
a. <input type="checkbox"/> Bank	1. linear feet	2. linear feet
b. <input checked="" type="checkbox"/> Bordering Vegetated Wetland	0	2. square feet
	1. square feet	0 sf - seasonal application
c. <input checked="" type="checkbox"/> Land Under Waterbodies and Waterways	16.5 sf	2. square feet
	1. square feet	
	N/A	
	3. cubic yards dredged	

Resource Area	Size of Proposed Alteration	Proposed Replacement (if any)
d. <input checked="" type="checkbox"/> Bordering Land Subject to Flooding	0	2. square feet
	1. square feet	
	0	
	3. cubic feet of flood storage lost	4. cubic feet replaced
e. <input type="checkbox"/> Isolated Land Subject to Flooding	1. square feet	
	2. cubic feet of flood storage lost	3. cubic feet replaced

- f.  Riverfront Area
1. Name of Waterway (if available) - specify coastal or inland
2. Width of Riverfront Area (check one):
- 25 ft. - Designated Densely Developed Areas only
  - 100 ft. - New agricultural projects only
  - 200 ft. - All other projects

3. Total area of Riverfront Area on the site of the proposed project: \_\_\_\_\_ square feet

4. Proposed alteration of the Riverfront Area:

a. total square feet \_\_\_\_\_ b. square feet within 100 ft. \_\_\_\_\_ c. square feet between 100 ft. and 200 ft. \_\_\_\_\_

5. Has an alternatives analysis been done and is it attached to this NOI?  Yes  No

6. Was the lot where the activity is proposed created prior to August 1, 1996?  Yes  No

3.  Coastal Resource Areas: (See 310 CMR 10.25-10.35)

**Note:** for coastal riverfront areas, please complete **Section B.2.f.** above.



Massachusetts Department of Environmental Protection  
Bureau of Resource Protection - Wetlands

**WPA Form 3 – Notice of Intent**

Massachusetts Wetlands Protection Act M.G.L. c. 131, §40

Provided by MassDEP:

MassDEP File Number

Document Transaction Number

Harwich

City/Town

**B. Buffer Zone & Resource Area Impacts (temporary & permanent) (cont'd)**

Check all that apply below. Attach narrative and supporting documentation describing how the project will meet all performance standards for each of the resource areas altered, including standards requiring consideration of alternative project design or location.

Online Users:  
Include your document transaction number (provided on your receipt page) with all supplementary information you submit to the Department.

<u>Resource Area</u>	<u>Size of Proposed Alteration</u>	<u>Proposed Replacement (if any)</u>
a. <input type="checkbox"/> Designated Port Areas	Indicate size under Land Under the Ocean, below	
b. <input type="checkbox"/> Land Under the Ocean	_____ 1. square feet _____ 2. cubic yards dredged	
c. <input type="checkbox"/> Barrier Beach	Indicate size under Coastal Beaches and/or Coastal Dunes below	
d. <input type="checkbox"/> Coastal Beaches	_____ 1. square feet	_____ 2. cubic yards beach nourishment
e. <input type="checkbox"/> Coastal Dunes	_____ 1. square feet	_____ 2. cubic yards dune nourishment

	<u>Size of Proposed Alteration</u>	<u>Proposed Replacement (if any)</u>
f. <input type="checkbox"/> Coastal Banks	_____ 1. linear feet	
g. <input type="checkbox"/> Rocky Intertidal Shores	_____ 1. square feet	
h. <input type="checkbox"/> Salt Marshes	_____ 1. square feet	_____ 2. sq ft restoration, rehab., creation
i. <input type="checkbox"/> Land Under Salt Ponds	_____ 1. square feet _____ 2. cubic yards dredged	
j. <input type="checkbox"/> Land Containing Shellfish	_____ 1. square feet	
k. <input type="checkbox"/> Fish Runs	Indicate size under Coastal Banks, inland Bank, Land Under the Ocean, and/or inland Land Under Waterbodies and Waterways, above  _____ 1. cubic yards dredged	
l. <input type="checkbox"/> Land Subject to Coastal Storm Flowage	_____ 1. square feet	

4.  Restoration/Enhancement  
If the project is for the purpose of restoring or enhancing a wetland resource area in addition to the square footage that has been entered in Section B.2.b or B.3.h above, please enter the additional amount here.

\_\_\_\_\_  
a. square feet of BVW

\_\_\_\_\_  
b. square feet of Salt Marsh

5.  Project Involves Stream Crossings

\_\_\_\_\_  
a. number of new stream crossings

\_\_\_\_\_  
b. number of replacement stream crossings



Massachusetts Department of Environmental Protection  
Bureau of Resource Protection - Wetlands

## WPA Form 3 – Notice of Intent

Massachusetts Wetlands Protection Act M.G.L. c. 131, §40

Provided by MassDEP:

MassDEP File Number

Document Transaction Number

Harwich

City/Town

### C. Other Applicable Standards and Requirements

- This is a proposal for an Ecological Restoration Limited Project. Skip Section C and complete Appendix A: Ecological Restoration Limited Project Checklists – Required Actions (310 CMR 10.11).

#### Streamlined Massachusetts Endangered Species Act/Wetlands Protection Act Review

1. Is any portion of the proposed project located in **Estimated Habitat of Rare Wildlife** as indicated on the most recent Estimated Habitat Map of State-Listed Rare Wetland Wildlife published by the Natural Heritage and Endangered Species Program (NHESP)? To view habitat maps, see the *Massachusetts Natural Heritage Atlas* or go to [http://maps.massgis.state.ma.us/PRI\\_EST\\_HAB/viewer.htm](http://maps.massgis.state.ma.us/PRI_EST_HAB/viewer.htm).

- a.  Yes  No **If yes, include proof of mailing or hand delivery of NOI to:**

Natural Heritage and Endangered Species Program  
Division of Fisheries and Wildlife  
1 Rabbit Hill Road  
Westborough, MA 01581

MA GIS 11-3-21

b. Date of map

If yes, the project is also subject to Massachusetts Endangered Species Act (MESA) review (321 CMR 10.18). To qualify for a streamlined, 30-day, MESA/Wetlands Protection Act review, please complete Section C.1.c, and include requested materials with this Notice of Intent (NOI); *OR* complete Section C.2.f, if applicable. *If MESA supplemental information is not included with the NOI, by completing Section 1 of this form, the NHESP will require a separate MESA filing which may take up to 90 days to review (unless noted exceptions in Section 2 apply, see below).*

- c. Submit Supplemental Information for Endangered Species Review\*
1.  Percentage/acreage of property to be altered:
 

(a) within wetland Resource Area	0.0004 ac (8.0 x EE-9)
	percentage/acreage
(b) outside Resource Area	n/a
	percentage/acreage
  2.  Assessor's Map or right-of-way plan of site
2.  Project plans for entire project site, including wetland resource areas and areas outside of wetlands jurisdiction, showing existing and proposed conditions, existing and proposed tree/vegetation clearing line, and clearly demarcated limits of work \*\*
- (a)  Project description (including description of impacts outside of wetland resource area & buffer zone)
  - (b)  Photographs representative of the site

\* Some projects not in Estimated Habitat may be located in Priority Habitat, and require NHESP review (see <https://www.mass.gov/mas-endangered-species-act-mesa-regulatory-review>).

Priority Habitat includes habitat for state-listed plants and strictly upland species not protected by the Wetlands Protection Act.

\*\* MESA projects may not be segmented (321 CMR 10.16). The applicant must disclose full development plans even if such plans are not required as part of the Notice of Intent process.



Massachusetts Department of Environmental Protection  
Bureau of Resource Protection - Wetlands

**WPA Form 3 – Notice of Intent**

Massachusetts Wetlands Protection Act M.G.L. c. 131, §40

Provided by MassDEP:

MassDEP File Number

Document Transaction Number

Harwich

City/Town

**C. Other Applicable Standards and Requirements (cont'd)**

(c)  MESA filing fee (fee information available at <https://www.mass.gov/how-to/how-to-file-for-a-mesa-project-review>).

Make check payable to "Commonwealth of Massachusetts - NHESP" and **mail to NHESP** at above address

*Projects altering 10 or more acres of land, also submit:*

(d)  Vegetation cover type map of site

(e)  Project plans showing Priority & Estimated Habitat boundaries

(f) OR Check One of the Following

1.  Project is exempt from MESA review. Attach applicant letter indicating which MESA exemption applies. (See 321 CMR 10.14, <https://www.mass.gov/service-details/exemptions-from-review-for-projectsactivities-in-priority-habitat>; the NOI must still be sent to NHESP if the project is within estimated habitat pursuant to 310 CMR 10.37 and 10.59.)

2.  Separate MESA review ongoing. a. NHESP Tracking # \_\_\_\_\_ b. Date submitted to NHESP \_\_\_\_\_

3.  Separate MESA review completed. Include copy of NHESP "no Take" determination or valid Conservation & Management Permit with approved plan.

3. For coastal projects only, is any portion of the proposed project located below the mean high water line or in a fish run?

a.  Not applicable – project is in inland resource area only      b.  Yes     No

If yes, include proof of mailing, hand delivery, or electronic delivery of NOI to either:

South Shore - Cohasset to Rhode Island border, and the Cape & Islands:

North Shore - Hull to New Hampshire border:

Division of Marine Fisheries -  
Southeast Marine Fisheries Station  
Attn: Environmental Reviewer  
836 South Rodney French Blvd.  
New Bedford, MA 02744  
Email: [dmf.envreview-south@mass.gov](mailto:dmf.envreview-south@mass.gov)

Division of Marine Fisheries -  
North Shore Office  
Attn: Environmental Reviewer  
30 Emerson Avenue  
Gloucester, MA 01930  
Email: [dmf.envreview-north@mass.gov](mailto:dmf.envreview-north@mass.gov)

Also if yes, the project may require a Chapter 91 license. For coastal towns in the Northeast Region, please contact MassDEP's Boston Office. For coastal towns in the Southeast Region, please contact MassDEP's Southeast Regional Office.

c.  Is this an aquaculture project?      d.  Yes     No

If yes, include a copy of the Division of Marine Fisheries Certification Letter (M.G.L. c. 130, § 57).





**Massachusetts Department of Environmental Protection**  
Bureau of Resource Protection - Wetlands

**WPA Form 3 – Notice of Intent**

Massachusetts Wetlands Protection Act M.G.L. c. 131, §40

Provided by MassDEP:

MassDEP File Number

Document Transaction Number

Harwich

City/Town

**C. Other Applicable Standards and Requirements (cont'd)**

4. Is any portion of the proposed project within an Area of Critical Environmental Concern (ACEC)?  
a.  Yes  No If yes, provide name of ACEC (see instructions to WPA Form 3 or MassDEP Website for ACEC locations). **Note:** electronic filers click on Website.  
b. ACEC
5. Is any portion of the proposed project within an area designated as an Outstanding Resource Water (ORW) as designated in the Massachusetts Surface Water Quality Standards, 314 CMR 4.00?  
a.  Yes  No
6. Is any portion of the site subject to a Wetlands Restriction Order under the Inland Wetlands Restriction Act (M.G.L. c. 131, § 40A) or the Coastal Wetlands Restriction Act (M.G.L. c. 130, § 105)?  
a.  Yes  No
7. Is this project subject to provisions of the MassDEP Stormwater Management Standards?  
a.  Yes. Attach a copy of the Stormwater Report as required by the Stormwater Management Standards per 310 CMR 10.05(6)(k)-(q) and check if:  
1.  Applying for Low Impact Development (LID) site design credits (as described in Stormwater Management Handbook Vol. 2, Chapter 3)  
2.  A portion of the site constitutes redevelopment  
3.  Proprietary BMPs are included in the Stormwater Management System.  
b.  No. Check why the project is exempt:  
1.  Single-family house  
2.  Emergency road repair  
3.  Small Residential Subdivision (less than or equal to 4 single-family houses or less than or equal to 4 units in multi-family housing project) with no discharge to Critical Areas.

**D. Additional Information**

- This is a proposal for an Ecological Restoration Limited Project. Skip Section D and complete Appendix A: Ecological Restoration Notice of Intent – Minimum Required Documents (310 CMR 10.12).

Applicants must include the following with this Notice of Intent (NOI). See instructions for details.

**Online Users:** Attach the document transaction number (provided on your receipt page) for any of the following information you submit to the Department.

1.  USGS or other map of the area (along with a narrative description, if necessary) containing sufficient information for the Conservation Commission and the Department to locate the site. (Electronic filers may omit this item.)
2.  Plans identifying the location of proposed activities (including activities proposed to serve as a Bordering Vegetated Wetland [BVW] replication area or other mitigating measure) relative to the boundaries of each affected resource area.

**Online Users:**  
Include your document transaction number (provided on your receipt page) with all supplementary information you submit to the Department.



Massachusetts Department of Environmental Protection  
Bureau of Resource Protection - Wetlands

Provided by MassDEP:

**WPA Form 3 – Notice of Intent**

Massachusetts Wetlands Protection Act M.G.L. c. 131, §40

MassDEP File Number

Document Transaction Number

Harwich

City/Town

**D. Additional Information (cont'd)**

3.  Identify the method for BVW and other resource area boundary delineations (MassDEP BVW Field Data Form(s), Determination of Applicability, Order of Resource Area Delineation, etc.), and attach documentation of the methodology.

4.  List the titles and dates for all plans and other materials submitted with this NOI.

**PROPOSED DOCK PLAN**

a. Plan Title

J.M. O'REILLY & ASSOCIATES, INC

John M. O'Reilly, P.E., P.L.S.

b. Prepared By

c. Signed and Stamped by

11-3-2021

1" = 20'

d. Final Revision Date

e. Scale

f. Additional Plan or Document Title

g. Date

5.  If there is more than one property owner, please attach a list of these property owners not listed on this form.

6.  Attach proof of mailing for Natural Heritage and Endangered Species Program, if needed.

7.  Attach proof of mailing for Massachusetts Division of Marine Fisheries, if needed.

8.  Attach NOI Wetland Fee Transmittal Form

9.  Attach Stormwater Report, if needed.

**E. Fees**

1.  Fee Exempt: No filing fee shall be assessed for projects of any city, town, county, or district of the Commonwealth, federally recognized Indian tribe housing authority, municipal housing authority, or the Massachusetts Bay Transportation Authority.

Applicants must submit the following information (in addition to pages 1 and 2 of the NOI Wetland Fee Transmittal Form) to confirm fee payment:

2. Municipal Check Number  
11484

3. Check date  
11-8-21

4. State Check Number  
11485

5. Check date  
11-8-21

6. Payor name on check: First Name  
J.M. O'Reilly & Associates, Inc.

7. Payor name on check: Last Name



Massachusetts Department of Environmental Protection  
Bureau of Resource Protection - Wetlands

Provided by MassDEP:

## WPA Form 3 – Notice of Intent

Massachusetts Wetlands Protection Act M.G.L. c. 131, §40

MassDEP File Number

Document Transaction Number

City/Town

### F. Signatures and Submittal Requirements

I hereby certify under the penalties of perjury that the foregoing Notice of Intent and accompanying plans, documents, and supporting data are true and complete to the best of my knowledge. I understand that the Conservation Commission will place notification of this Notice in a local newspaper at the expense of the applicant in accordance with the wetlands regulations, 310 CMR 10.05(5)(a).

I further certify under penalties of perjury that all abutters were notified of this application, pursuant to the requirements of M.G.L. c. 131, § 40. Notice must be made by Certificate of Mailing or in writing by hand delivery or certified mail (return receipt requested) to all abutters within 100 feet of the property line of the project location.

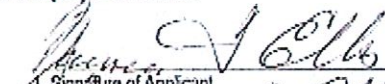
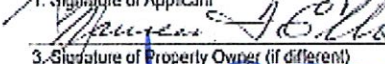
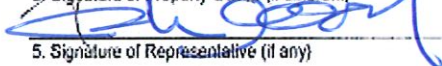
<p> 1. Signature of Applicant</p> <p> 3. Signature of Property Owner (if different)</p> <p> 5. Signature of Representative (if any)</p>	<p>2. Date <u>11/3/2021</u></p> <p>4. Date <u>11/3/2021</u></p> <p>6. Date <u>11/8/2021</u></p>
--	---

**For Conservation Commission:**

Two copies of the completed Notice of Intent (Form 3), including supporting plans and documents, two copies of the NOI Wetland Fee Transmittal Form, and the city/town fee payment, to the Conservation Commission by certified mail or hand delivery.

**For MassDEP:**

One copy of the completed Notice of Intent (Form 3), including supporting plans and documents, one copy of the NOI Wetland Fee Transmittal Form, and a copy of the state fee payment to the MassDEP Regional Office (see Instructions) by certified mail or hand delivery

**Other:**

If the applicant has checked the "yes" box in any part of Section C, Item 3, above, refer to that section and the Instructions for additional submittal requirements.

The original and copies must be sent simultaneously. Failure by the applicant to send copies in a timely manner may result in dismissal of the Notice of Intent.



# WPA Form 3 – Notice of Intent

Massachusetts Wetlands Protection Act M.G.L. c. 131, §40

MassDEP File Number

Document Transaction Number

City/Town

## F Signatures and Submittal Requirements

I hereby certify under the penalties of perjury that the foregoing Notice of Intent and accompanying plans, documents, and supporting data are true and complete to the best of my knowledge. I understand that the Conservation Commission will place notification of this Notice in a local newspaper at the expense of the applicant in accordance with the wetlands regulations, 310 CMR 10.05(5)(a).

I further certify under penalties of perjury that all abutters were notified of this application, pursuant to the requirements of M.G.L. c. 131 § 40. Notice must be made by Certificate of Mailing or in writing by hand delivery or certified mail (return receipt requested) to all abutters within 100 feet of the property line of the project location.

1. Signature of Applicant

*Bruce L Rung*

2. Date

*11/3/21*

3. Signature of Property Owner (if different)

*[Signature]*

4. Date

*11.9.2021*

5. Signature of Representative (if any)

6. Date

### For Conservation Commission:

Two copies of the completed Notice of Intent (Form 3), including supporting plans and documents, two copies of the NOI Wetland Fee Transmittal Form, and the city/town fee payment, to the Conservation Commission by certified mail or hand delivery.

### For MassDEP:

One copy of the completed Notice of Intent (Form 3), including supporting plans and documents, one copy of the NOI Wetland Fee Transmittal Form, and a **copy** of the state fee payment to the MassDEP Regional Office (see Instructions) by certified mail or hand delivery.

### Other:

If the applicant has checked the "yes" box in any part of Section C, Item 3, above, refer to that section and the Instructions for additional submittal requirements.

The original and copies must be sent simultaneously. Failure by the applicant to send copies in a timely manner may result in dismissal of the Notice of Intent.



Massachusetts Department of Environmental Protection  
 Bureau of Resource Protection - Wetlands  
**NOI Wetland Fee Transmittal Form**  
 Massachusetts Wetlands Protection Act M.G.L. c. 131, §40

**Important:** When filling out forms on the computer, use only the tab key to move your cursor - do not use the return key.



**A. Applicant Information**

1. Location of Project:

0 Pleasant Lake Avenue

a. Street Address

11485

c. Check number

Harwich

b. City/Town

131.50

d. Fee amount

2. Applicant Mailing Address:

Jonathan & Maureen Ellis

a. First Name

Bruce & Mary Catherine Ring

b. Last Name

c. Organization

1 Clark Road

d. Mailing Address

Milton

e. City/Town

781-424-9234

h. Phone Number

i. Fax Number

MA

f. State

02186

g. Zip Code

mfellis@comcast.net

j. Email Address

3. Property Owner (if different):

a. First Name

b. Last Name

c. Organization

d. Mailing Address

e. City/Town

f. State

g. Zip Code

h. Phone Number

i. Fax Number

j. Email Address

**B. Fees**

Fee should be calculated using the following process & worksheet. **Please see Instructions before filling out worksheet.**

**Step 1/Type of Activity:** Describe each type of activity that will occur in wetland resource area and buffer zone.

**Step 2/Number of Activities:** Identify the number of each type of activity.

**Step 3/Individual Activity Fee:** Identify each activity fee from the six project categories listed in the instructions.

**Step 4/Subtotal Activity Fee:** Multiply the number of activities (identified in Step 2) times the fee per category (identified in Step 3) to reach a subtotal fee amount. Note: If any of these activities are in a Riverfront Area in addition to another Resource Area or the Buffer Zone, the fee per activity should be multiplied by 1.5 and then added to the subtotal amount.

**Step 5/Total Project Fee:** Determine the total project fee by adding the subtotal amounts from Step 4.

**Step 6/Fee Payments:** To calculate the state share of the fee, divide the total fee in half and subtract \$12.50. To calculate the city/town share of the fee, divide the total fee in half and add \$12.50.

To calculate filing fees, refer to the category fee list and examples in the instructions for filling out WPA Form 3 (Notice of Intent).



**Massachusetts Department of Environmental Protection**  
 Bureau of Resource Protection - Wetlands  
**NOI Wetland Fee Transmittal Form**  
 Massachusetts Wetlands Protection Act M.G.L. c. 131, §40

**B. Fees** (continued)

Step 1/Type of Activity	Step 2/Number of Activities	Step 3/Individual Activity Fee	Step 4/Subtotal Activity Fee
INLAND DOCK	72	4	288.00
_____	_____	_____	_____
_____	_____	_____	_____
_____	_____	_____	_____
_____	_____	_____	_____
_____	_____	_____	_____
_____	_____	_____	_____
_____	_____	_____	_____

**Step 5/Total Project Fee:** 288.00

**Step 6/Fee Payments:**

Total Project Fee:	<u>288.00</u>
State share of filing Fee:	<u>131.50</u>
City/Town share of filling Fee:	<u>156.50</u>
	a. Total Fee from Step 5
	b. 1/2 Total Fee less \$12.50
	c. 1/2 Total Fee plus \$12.50

**C. Submittal Requirements**

a.) Complete pages 1 and 2 and send with a check or money order for the state share of the fee, payable to the Commonwealth of Massachusetts.

Department of Environmental Protection  
 Box 4062  
 Boston, MA 02211

b.) **To the Conservation Commission:** Send the Notice of Intent or Abbreviated Notice of Intent; a copy of this form; and the city/town fee payment.

**To MassDEP Regional Office** (see Instructions): Send a copy of the Notice of Intent or Abbreviated Notice of Intent; a copy of this form; and a copy of the state fee payment. (E-filers of Notices of Intent may submit these electronically.)

**AFFIDAVIT OF SERVICE**

Under the Massachusetts Wetland Protection Act

(To be submitted to the Massachusetts Department of Environmental Protection and the Conservation Commission when filing a Notice of Intent.)

I, John M. O'Reilly, P.E., P.L.S. hereby certify under the pains  
Name of Person Making the Affidavit

and Penalties of Perjury that on 11/8/21 I gave notification to abutters in compliance with the second paragraph of Massachusetts General Laws Chapter 131, Section 40, and the DEP Guide to Abutter Notification dated April 8, 1994 in connection with the following matter:

A Notice of Intent filed under the Massachusetts Wetlands Protection Act by:

Jonathan and Maureen Ellis & Bruce & Mary Catherine Ring - Co-owners

Name of Applicant

With the Town of Harwich Conservation Commission,

On 11/8/21 for property located at:  
Date

0 Pleasant Lake Ave (Parcel ID: 101-P1-0)

Land where work is proposed

The form of the notification and a list of abutters to whom it was given and their addresses are attached to this Affidavit of Service.

John M. O'Reilly, P.E., P.L.S.  
Name:



11/8/21  
Date

NOTIFICATION TO ABUTTERS

Under the Town of Harwich Wetlands Protection Bylaw

In accordance with the first paragraph of section 5 of the Town of Harwich Wetlands Protection Bylaw you are hereby notified of the following:

A. The name of the applicant is Jonathan & Maureen Ellis/Bruce & Mary Catherine Ring and the address is 0 Pleasant Lake Avenue

B. The applicant has filed a **Notice of Intent** with the Harwich Conservation Commission and is seeking permission to perform work in an area subject to protection under the Wetland Protection Act (MGL Chapter 131, Section 40).

The activity is The project proposes to install and maintain a seasonal dock in the waters of Long Pond.

\_\_\_\_\_  
\_\_\_\_\_  
\_\_\_\_\_

C. The date of the hearing is 12/1/2021 at 6:30 p.m. Hybrid Hearing

D. Copies of the Notice of Intent and the plan may be examined at the Harwich Town Hall during business hours. For more information call 508-430-7538.

You may also contact the firm or representative that provide you with this notice.

Firm name J.M. O'Reilly & Associates, Inc. phone # 508-896-6601

Notice of the public hearing, including date, time and place will be published at least five days in advance in the Cape Cod Chronicle.

Notice of the public hearing, including date, time and place will be posted at Harwich Town Hall at least 48 hours in advance.

You may also contact the nearest Department of Environmental Protection Regional Office for more information about this application or the Wetlands Protection Act.

Southeast Regional Office: 508-946-2800





TOWN OF HARWICH, MA  
 BOARD OF ASSESSORS  
 732 Main Street, Harwich, MA 02645

Abutters List Within 100 feet of Parcel 101/P1/0

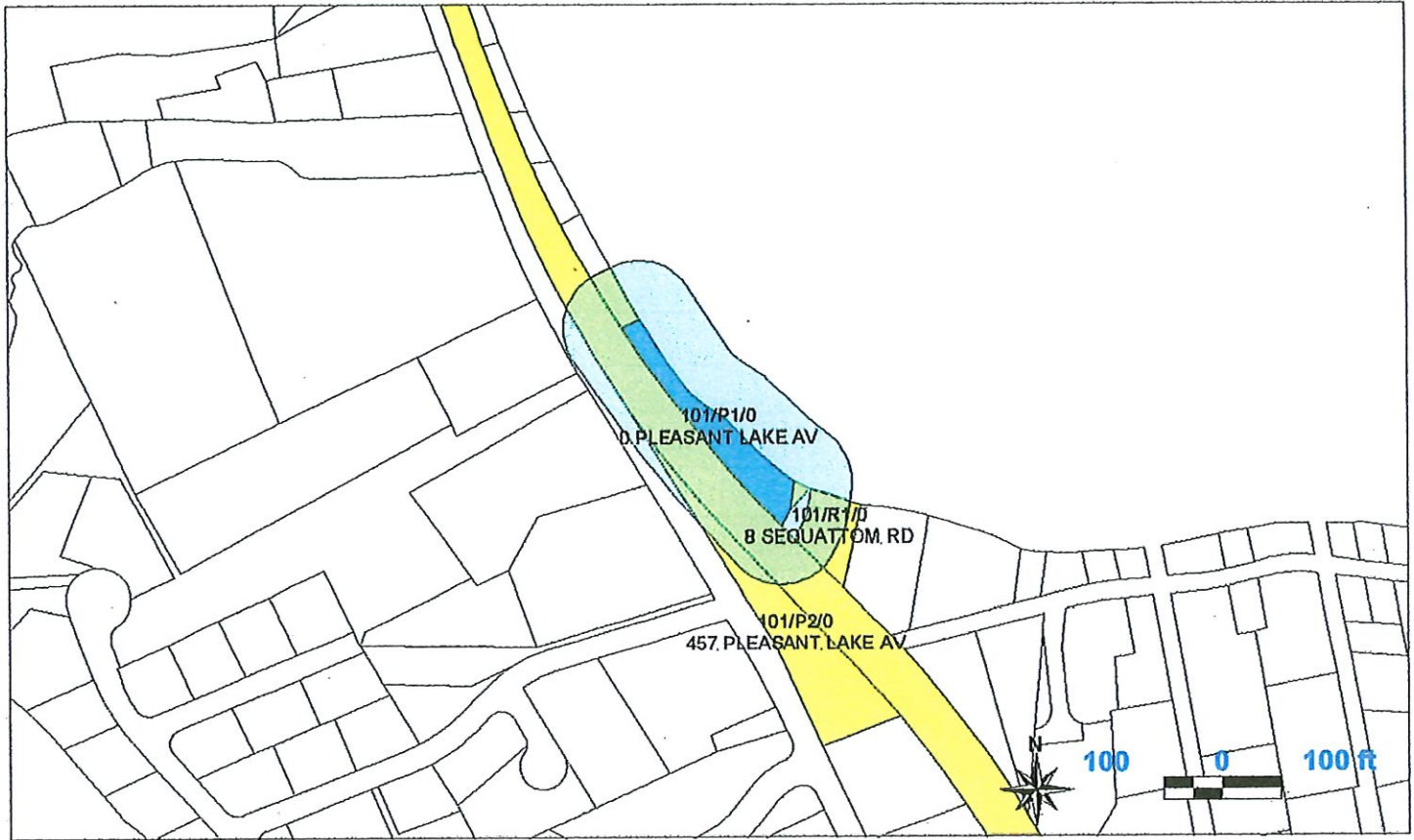

Key	Parcel ID	Owner	Location	Mailing Street	Mailing City	ST	ZipCd/Country
10651	39-K4-0-E	MASSACHUSETTS COMMONWEALTH OF DEPT OF ENVIRONMENTAL MANAGEMEN	0 BIKE PTH	100 CAMBRIDGE ST	BOSTON	MA	02202
9899	100-K4-4-0-R	GREENE FRANKLIN & GREENE LINDA	0 PLEASANT LAKE AV	42 FLICKER LN	W YARMOUTH	MA	02673
7476	101-P1-0-R	ELLIS JONATHAN TRS MAUREEN TRS RING BRUCE, MARY CATHERINE ET AL	0 PLEASANT LAKE AV	1 CLARK RD	MILTON	MA	02186
9905	101-P2-0-R	BYRON DAVID M & BYRON SUSAN H	457 PLEASANT LAKE AV	457 PLEASANT LAKE AV	HARWICH	MA	02645
20461	101-P3-0-R	BURKE CYRIL M TRS ETAL BURKE CATHERINE A TRS	0 PLEASANT LAKE AV	222 PROSPECT ST	MIDLAND PARK	NJ	07432
9906	101-R1-0-R	BURKE CYRIL M TRS ETAL BURKE CATHERINE A TRS	8 SEQUATTOM RD	222 PROSPECT ST	MIDLAND PARK	NJ	07432

39-K4-0-E

MASSACHUSETTS COMMONWEALTH OF  
DEPT OF ENVIRONMENTAL MANAGEMEN  
100 CAMBRIDGE ST  
BOSTON, MA 02202

100-K4-4-0-R

GREENE FRANKLIN &  
GREENE LINDA  
42 FLICKER LN  
W YARMOUTH, MA 02673

101-P1-0-R

ELLIS JONATHAN TRS MAUREEN TRS  
RING BRUCE, MARY CATHERINE ET  
1 CLARK RD  
MILTON, MA 02186

101-P2-0-R

BYRON DAVID M &  
BYRON SUSAN H  
457 PLEASANT LAKE AV  
HARWICH, MA 02645

101-P3-0-R

BURKE CYRIL M TRS ETAL  
BURKE CATHERINE A TRS  
222 PROSPECT ST  
MIDLAND PARK, NJ 07432

101-R1-0-R

BURKE CYRIL M TRS ETAL  
BURKE CATHERINE A TRS  
222 PROSPECT ST  
MIDLAND PARK, NJ 07432

**Oliver** OLIVER: MassGIS's Online Mapping Tool Try [MassMapper](#), OLIVER's replacement (OLIVER will work through 2021)

474 Pleasant Lake, Harwich

Zoom to a town



0 m

Basemaps

**Available Data Layers**

Search data layers

- Tiled Layers
- Census 1990
- Census 2000
- Census 2010
- Census 2020
- Coastal and Marine Features
- Conservation / Recreation
- Cultural Resources
- Environmental Monitoring (testing/monitorin
- Images
- Index (arrids/filino .schemes for certain layers

**Active Data Layers**

Check all Uncheck all R

- Tax Parcels for Query
- Detailed Features
- Tax Parcels for Display
- Structures

**Legend**

Tax Parcels for Query

**OLIVER** OLIVER: MassGIS's Online Mapping Tool Try [MassMapper](#), OLIVER's replacement (OLIVER will work through 2021)

474 Pleasant Lake, Harwich

Zoom to a town

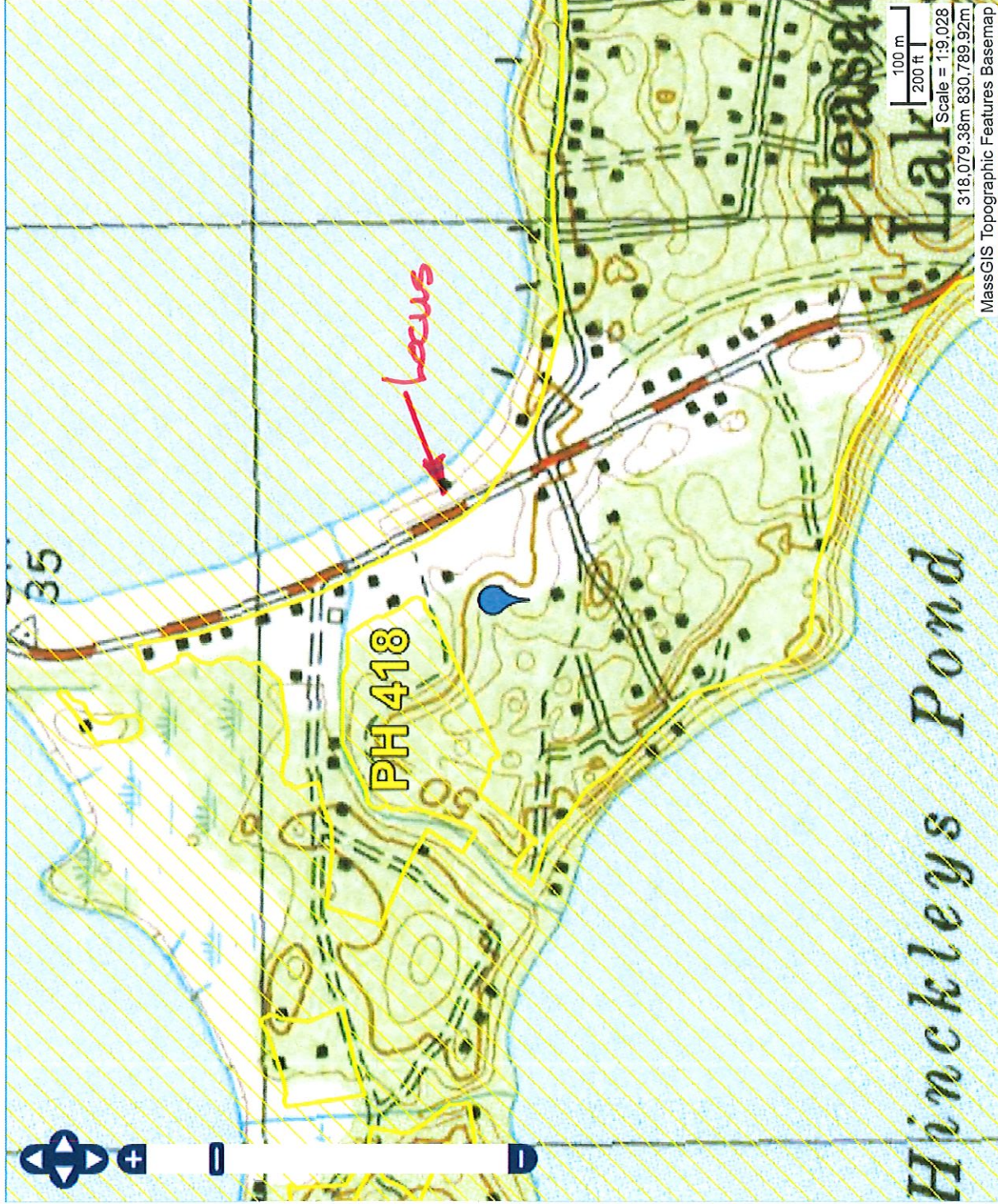

0 m

Basemaps

**Available Data Layers**

Search data layers

- Natural Heritage Data
- BioMap2
- NHESP Ecoregions
- NHESP Certified Vernal Pools
- NHESP Estimated Habitats of Rare V
- NHESP Natural Communities
- NHESP Priority Habitats of Rare Spe
- Potential Vernal Pools
- Office of Fishing and Boating Access Sit
- Openspace
- Trails

**Active Data Layers**

- Check all Uncheck all R
- NHESP Priority Habitats of Rare Spe
- USGS Topographic Maps
- Tax Parcels for Query
- Detailed Features

**Legend**

NHESP Priority Habitats of Rare Species



Tax Parcels for Query



