

PLAN BOOK 386 DEED BOOK 28455 ASSESSORS' MAP 100
 PAGE 86 PAGE 55 PARCEL K4-3

ELEVATION SCALE: 1" = 10'

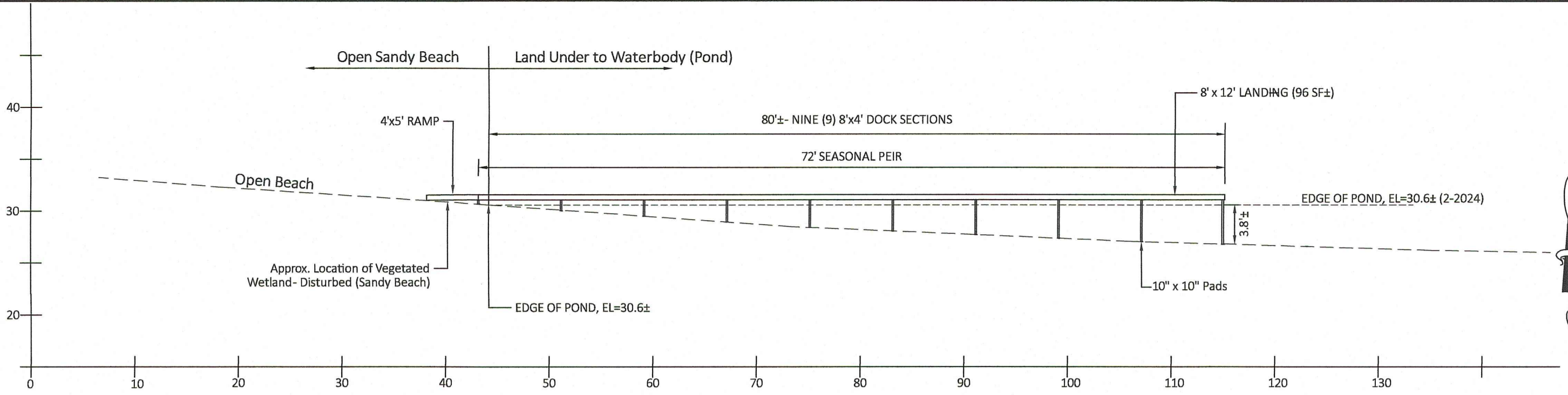

SECTION A- 'A' SCALE: 1" = 10'

LEGEND

[32]	EXISTING CONTOUR
— 32	PROPOSED CONTOUR
x 12.34	EXISTING SPOT GRADE
24x5	PROPOSED SPOT GRADE
— W	WATER SERVICE LINE
— O	OVERHEAD UTILITY SERVICE
— U	UNDERGROUND UTILITY SERVICE
— G	GAS SERVICE LINE
⊕	TEST HOLE / BORING LOCATION
ST	SEPTIC TANK
DB	DISTRIBUTION BOX
SAS	SOIL ABSORPTION SYSTEM
Reserve	RESERVED FOR FUTURE
⊕	UTILITY POLE
⊕	CATCH BASIN
⊕	FIRE HYDRANT
⊕	WELL
⊕	DRAINAGE MANHOLE
■	CONCRETE BOUND, FOUND
—	TOP OF BANK
—	LIMIT OF WORK
—	FENCE
—	EDGE OF CLEARING

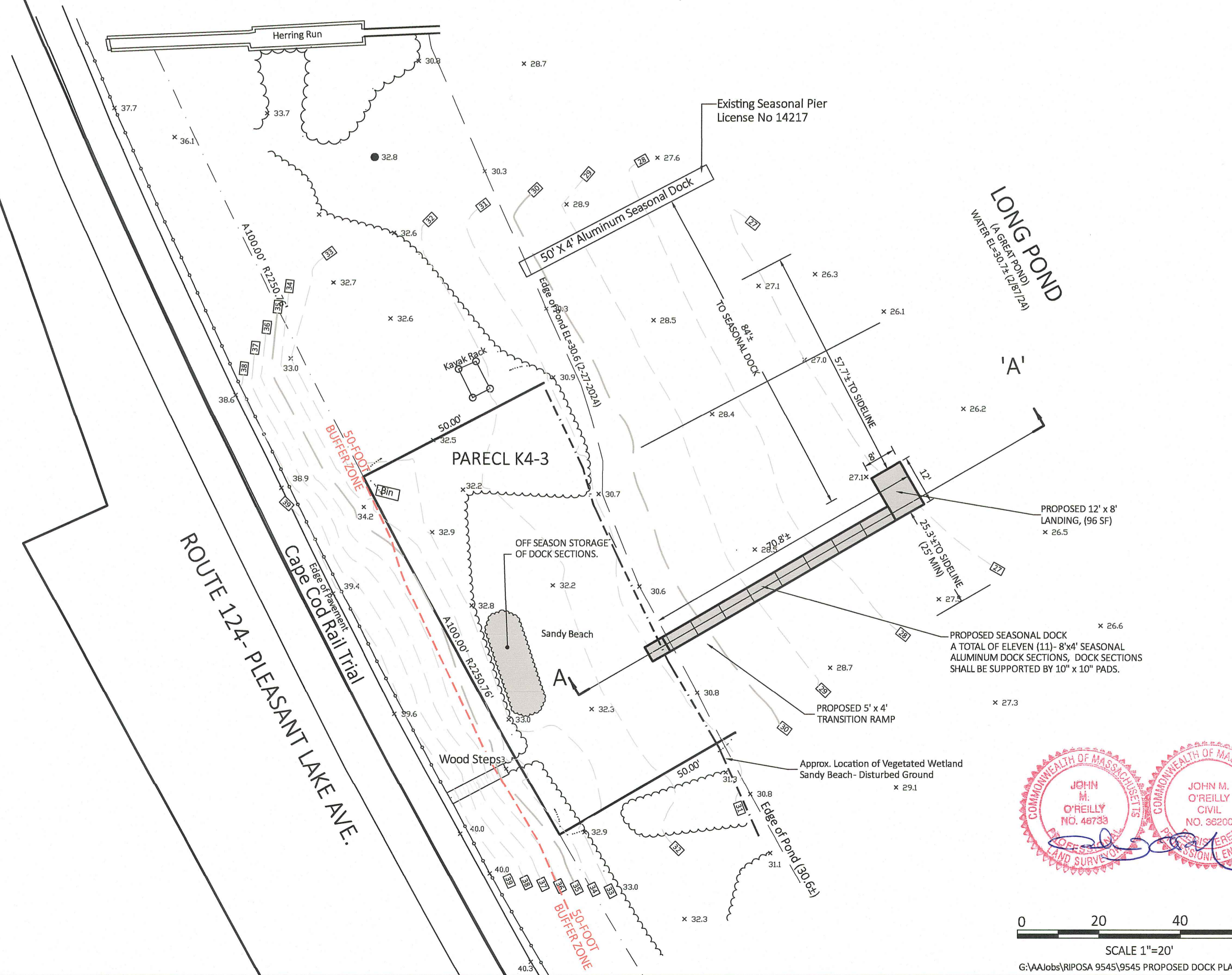

CONSERVATION NOTES:

- 1.) THE SEASONAL DOCK SHALL BE A PREFABRICATED ALUMINUM DOCK PRODUCT. THE "H" SUPPORT BRACKETS SHALL BE EQUIPPED WITH 10"x10" ALUM. PADS SO AS TO SUPPORT THE DOCK ON THE POND'S BOTTOM. A TOTAL OF 24 PADS ARE PROPOSED (16.5 SF±)
- 2.) THE DECKING SURFACE SHALL BE WOODEN OR AS APPROVED. THE DECKING SHALL HAVE 3/8" GAPS BETWEEN THE BOARDS SO AS TO ALLOW SUNLIGHT BELOW THE DOCK STRUCTURE.
- 3.) THE POSTS FOR THE THE "H" BRACKETS ARE NOT TO BE DRIVEN OR JETTED INTO THE POND'S BOTTOM.
- 4.) THE PROPOSAL DOES NOT CALL FOR ANY DREDGING OR ALTERATION OF THE POND'S BOTTOM.
- 5.) THE OFF SEASON STORAGE OF THE DOCK SECTIONS SHALL STORED ADJACENT TO THE BEACH AREA, REFER TO PLAN VIEW FOR LOCATION.

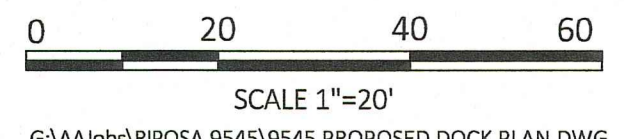
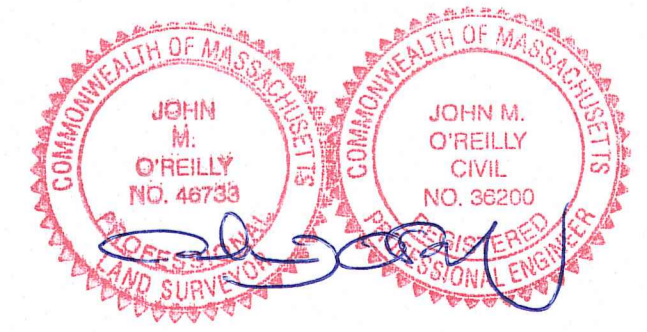

RIPOSA- POND FRONT PARCEL
 482 PLEASANT LAKE AVE- ROUTE 124, HARWICH, MA

PROPOSED DOCK PLAN
 PARCEL K4-3 SHOREFRONT- PLEASANT LAKE AVE., HARWICH, MA

J.M. O'REILLY & ASSOCIATES, INC.
 Professional Engineering & Land Surveying Services

1573 Main Street - Route 6A
 P.O. Box 1773
 Brewster, MA 02631 (508)896-6602 Fax

DATE: 3-1-2024	SCALE: As Noted	BY: gmb	CHECK: JMO	JOB NUMBER: JMO-9545
----------------	-----------------	---------	------------	----------------------