

ELEVATION
SCALE: 1" = 10'

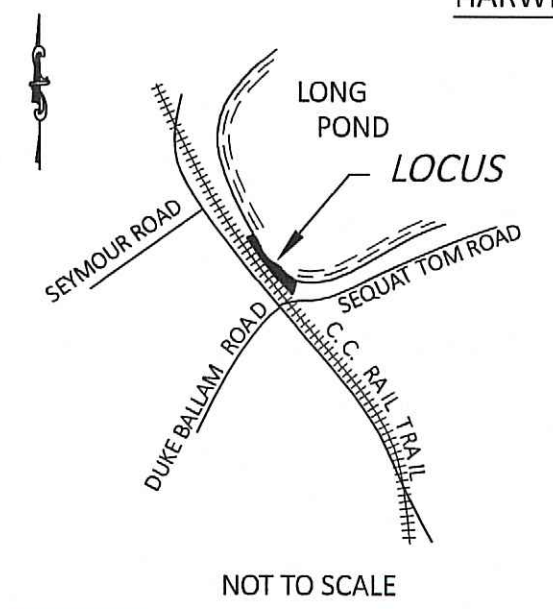

SECTION A- 'A'
SCALE: 1" = 10'

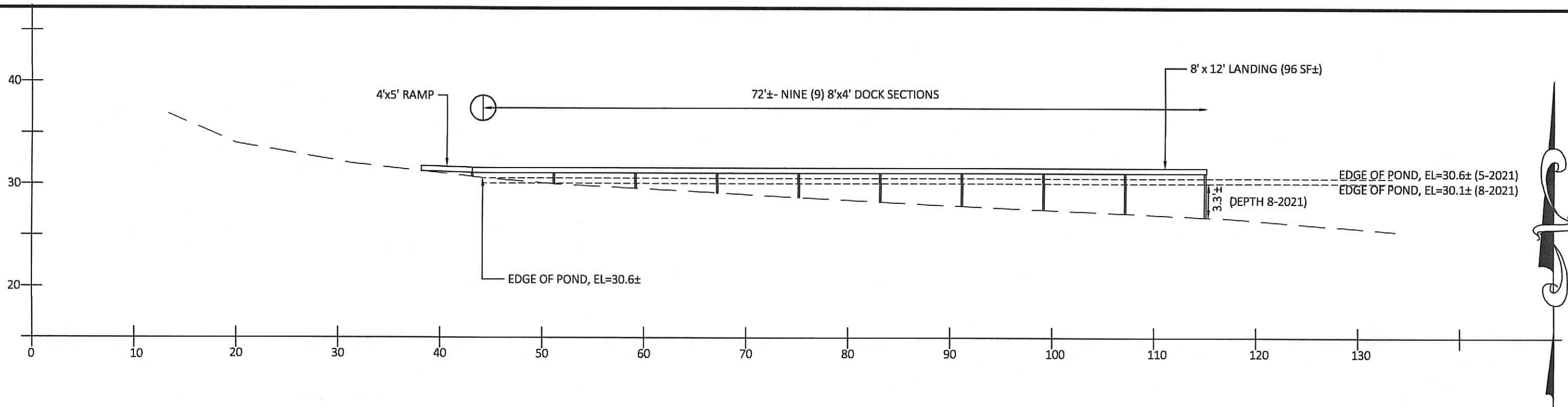
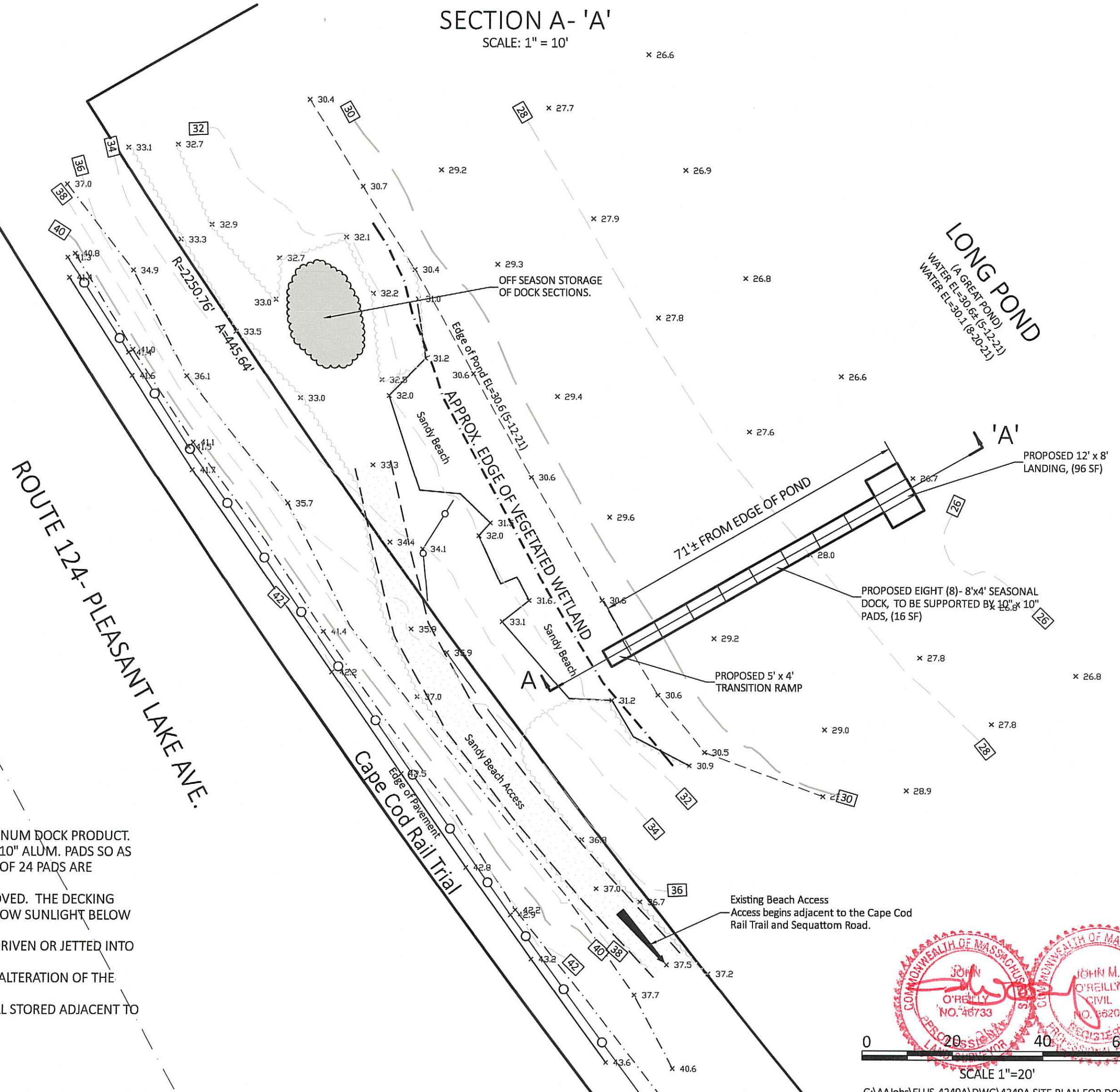

LEGEND

	EXISTING CONTOUR
	PROPOSED CONTOUR
	EXISTING SPOT GRADE
	PROPOSED SPOT GRADE
	WATER SERVICE LINE
	OVERHEAD UTILITY SERVICE
	UNDERGROUND UTILITY SERVICE
	GAS SERVICE LINE
	TEST HOLE / BORING LOCATION
	SEPTIC TANK
	DISTRIBUTION BOX
	SOIL ABSORPTION SYSTEM
	RESERVED FOR FUTURE
	UTILITY POLE
	CATCH BASIN
	FIRE HYDRANT
	WELL
	DRAINAGE MANHOLE
	CONCRETE BOUND, FOUND
	TOP OF BANK
	LIMIT OF WORK
	FENCE
	EDGE OF CLEARING

CONSERVATION NOTES:

- 1.) THE SEASONAL DOCK SHALL BE A PREFABRICATED ALUMINUM DOCK PRODUCT. THE "H" SUPPORT BRACKETS SHALL BE EQUIPPED WITH 10"x10" ALUM. PADS SO AS TO SUPPORT THE DOCK ON THE POND'S BOTTOM. A TOTAL OF 24 PADS ARE PROPOSED (16.5 SF±)
- 3.) THE DECKING SURFACE SHALL BE WOODEN OR AS APPROVED. THE DECKING SHALL HAVE 3/8" GAPS BETWEEN THE BOARDS SO AS TO ALLOW SUNLIGHT BELOW THE DOCK STRUCTURE.
- 4.) THE POSTS FOR THE THE "H" BRACKETS ARE NOT TO BE DRIVEN OR JETTED INTO THE POND'S BOTTOM.
- 5.) THE PROPOSAL DOES NOT CALL FOR ANY DREDGING OR ALTERATION OF THE POND'S BOTTOM.
- 6.) THE OFF SEASON STORAGE OF THE DOCK SECTIONS SHALL STORED ADJACENT TO THE BEACH AREA, REFER TO PLAN VIEW FOR LOCATION.

ELLIS- RING POND FRONT PARCEL
PARCEL P1- PLEASANT LAKE ROAD- ROUTE 124, HARWICH, MA

PROPOSED DOCK PLAN
PARCEL P1- PLEASANT LAKE AVE., HARWICH, MA

J.M. O'REILLY & ASSOCIATES, INC.
Professional Engineering & Land Surveying Services

1573 Main Street - Route 6A
P.O. Box 1773
Brewster, MA 02631 (508)896-6601 Office (508)896-6602 Fax
DATE: 11-3-2021 SCALE: As Noted BY: jmo CHECK: JMO JOB NUMBER: JMO-4249a

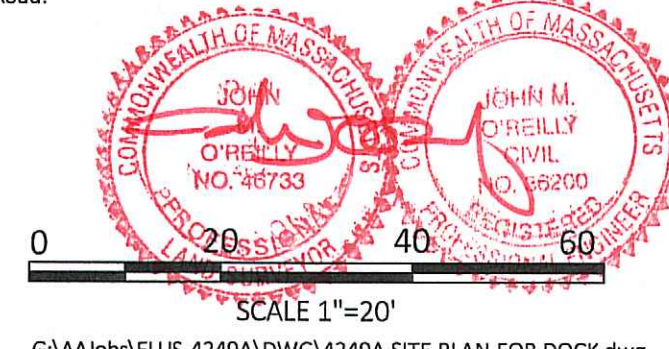

0 20 40 60
SCALE 1"=20'
G:\AA\Jobs\ELLIS-4249A\DWG\4249A.SITE PLAN FOR DOCK.dwg