

CONSERVATION NOTES:

- 1.) THE PROPOSED WORK OUTLINED IN THE NOTICE OF INTENT IS TO CONSTRUCT A NEW DOCK, THE SAME SIZE AND LOCATION AS THE EXISTING DOCK.
- 2.) A NEW LICENSE APPLICATION FOR THE PROPOSED DOCK, ONCE APPROVED BY THE LOCAL CONSERVATION COMMISSION, SHALL BE SUBMITTED TO THE MASSACHUSETTS DEPARTMENT OF ENVIRONMENTAL PROTECTION.
- 3.) OWNER/DOCK BUILDER SHALL REVIEW THE ORDER OF CONDITIONS PRIOR TO AND DURING CONSTRUCTION.
- 4.) DOCK MATERIAL SHALL BE ALUMINUM, RED CEDAR OR POLY DECKING MATERIAL. SLAT SPACING SHALL BE 1/2" MINIMUM, FOR SUNLIGHT PENETRATION AND SHALL MEET ALL REQUIREMENTS OF THE HARWICH CONSERVATION COMMISSION FOR FRESHWATER DOCKS.
- 5.) BENCH SHALL BE CONSTRUCTED OF WELDED ALUMINUM OR WOOD. APPROXIMATE SIZE: 55" LONG, 29" DEEP & 33" HIGH
- 6.) OVER THE WATER KAYAK RACK SHALL BE CONSTRUCTED OF WELDED ALUMINUM, POWDER COATED STEEL, OR WOOD CONSTRUCTION. APPROXIMATE SIZE, 77" LONG 26" WIDE & 48" HIGH.

Long Pond (A Great Pond - Water EL=30.6± 8/31/2023)

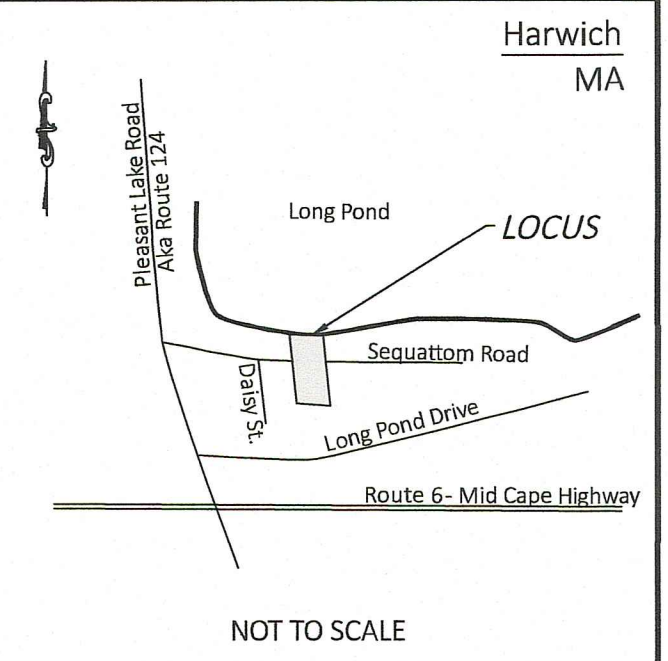
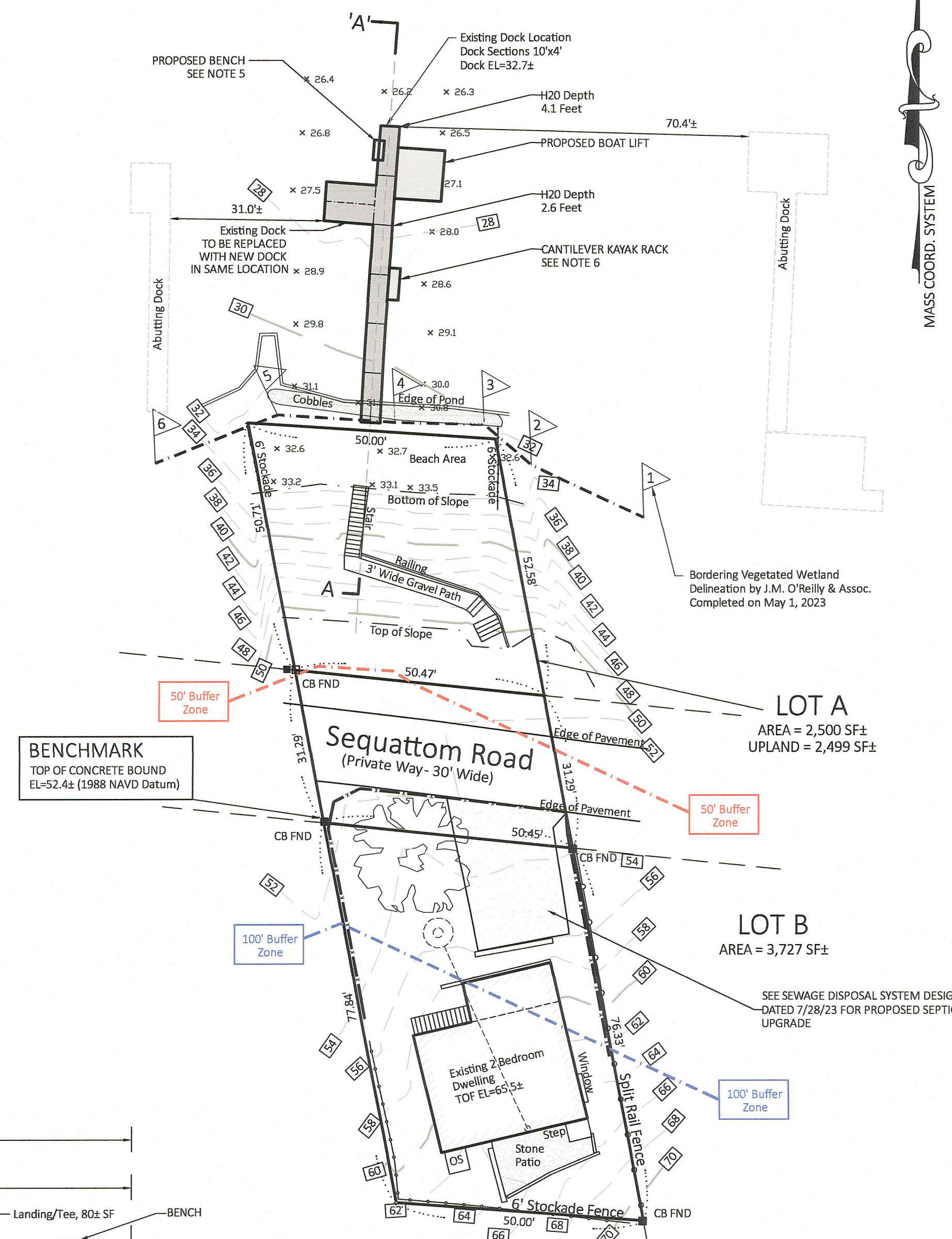

PLAN BOOK 128 DEED BOOK 35633 ASSESSORS' MAP 101
 PAGE 133 PAGE 148 PARCEL T2-2

LEGEND

	EXISTING CONTOUR
	PROPOSED CONTOUR
	EXISTING SPOT GRADE
	PROPOSED SPOT GRADE
	WATER SERVICE LINE
	OVERHEAD UTILITY SERVICE
	ELECTRIC / COMM. SERVICE LINE
	GAS SERVICE LINE
	TEST HOLE / BORING LOCATION
	SEPTIC TANK
	DISTRIBUTION BOX
	SOIL ABSORPTION SYSTEM
	RESERVED FOR FUTURE
	UTILITY POLE
	CATCH BASIN
	FIRE HYDRANT
	WELL
	DRAINAGE MANHOLE
	CONCRETE BOUND, FOUND
	LIMIT OF WORK
	FENCE
	EDGE OF CLEARING

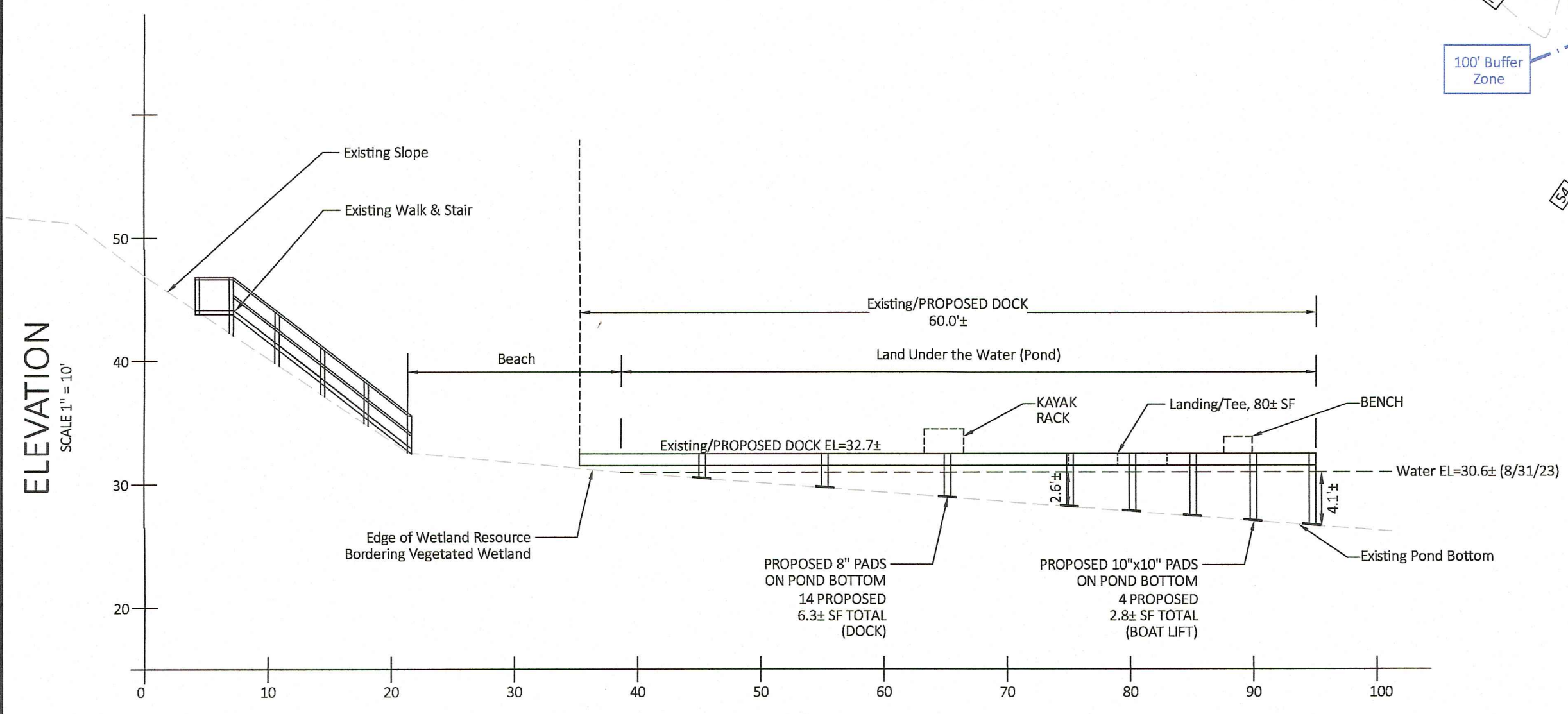

SECTION A-A - 'A'
SCALE 1" = 10'

PLAN
SCALE 1" = 20'

Professional Engineer and Land Surveyor stamps for John M. O'Reilly, Civil Engineer (No. 36600) and Professional Land Surveyor (No. 46733).

Schubert Residence
 c/o Jim Hagerty, Reef, Cape Codds Home Builder, PO Box 186, West Dennis, MA 02670

PROPOSED DOCK/PIER SITE PLAN
 49 Sequattom Road, Harwich, MA

J.M. O'REILLY & ASSOCIATES, INC.
 Professional Engineering & Land Surveying Services

1573 Main Street - Route 6A
 P.O. Box 1773
 Brewster, MA 02631 (508)896-6601 Office (508)896-6602 Fax

DATE: 9/29/23	SCALE: As Noted	BY: MTF	CHECK: JMO	JOB NUMBER: JMO-9496
---------------	-----------------	---------	------------	----------------------