

HARWICH RECREATION DEPARTMENT & COMMISSION

2020 COMMUNITY PRESERVATION COMMITTEE

FUNDING REQUEST

WHITEHOUSE FIELD LIGHTING PROJECT

PHASE 2

**TOWN OF HARWICH - COMMUNITY PRESERVATION
COMMITTEE 2020 CPA PROJECT FUNDING REQUEST
APPLICATION**

FISCAL YEAR 2021-2022

Submission Date: 10/30/20 / Re-submit COVER PAGE 1/12/21

APPLICANT INFORMATION

Applicant: Revised Town of Harwich, Interim T.A. Joseph Powers

Town Committee, Board or Organization: Recreation & Youth Commission

Legal Mailing Address: 100 Oak St. Harwich, MA 02645

Phone: 508-430-7553 Email Address: ebeebe@town.harwich.ma.us

Project Manager: ERIC BEEBE, Rec. Director; GRIFFIN RYDER P.E.
Town Engineer

Legal Mailing Address: 100 Oak St Harwich, MA 02645

Phone: 508-331-8339 Email Address: ebeebe@town.harwich.ma.us

Second Contact Person: John Mahon - Rec. Commission Chairman

Legal Mailing Address: 100 Oak St. Harwich, MA 02645

Phone: 508-331-8339 Email Address: jfmcapecod@gmail.com

PROJECT INFORMATION

PROJECT TITLE: Whitehouse Field Lightrig Project, Phase 2

PROJECT AMOUNT REQUESTED: \$100,000

PROJECT DESCRIPTION: See Attached Documents

ESTIMATED START DATE: Spring 2021

ESTIMATED COMPLETION DATE: Spring 2021

**Three years from the release of funds (July 2021) funds may be rescinded
automatically; waivers may be sought.**

CPA CATEGORY

APPLICANTS PLEASE TAKE NOTE **please check boxes for all that apply**

- Open Space:** This application is for the “acquisition, preservation, rehabilitation and/or preservation of open space”.
- Historic:** This application is for the “acquisition, preservation, rehabilitation and/or restoration of historic resources”. Please provide the date on which the HDHC reviewed and endorsed this application.
- Community Housing:** This application is for the “acquisition, creation, preservation and/or support of community housing”.
- Recreation:** This application is for the “acquisition, creation, preservation, rehabilitation and/or restoration of land for recreational use”.

How does this project fit into Harwich’s Local Comprehensive Plan and/or other Plan?

SEE ATTACHED DOCUMENTS

How does this project benefit the citizens of Harwich? If appropriate, has the application sought public opinion or input? If not, why?

SEE ATTACHED DOCUMENTS

Please list other Commissions/Boards/Committees/Organizations that may have involvement, jurisdiction, partnering:

<u>Commissions/Boards/Committees/Organizations</u>	Please have them initial here after their review
<i>RECREATION & YOUTH COMMISSION</i>	
<i>HIGHWAY DEPARTMENT</i>	
<i>ENGINEERING DEPARTMENT</i>	
<i>TOWN ADMINISTRATORS OFFICE</i>	
<i>COMMUNITY PRESERVATION COMMITTEE</i>	

Describe their response, or provided written comments/input:

See Attached Document

PROJECT BUDGET: Attach a dated and detailed line item project budget estimate for your funding request. If the request involves a Town-owned asset, provide the project's projected operating expenses, including maintenance.

COST ESTIMATE(S): \$ 100,000⁰⁰

Attach cost estimates or firm quotes (if available) for all projects.

LAND and/or BUILDING ACQUISITION PROJECTS: The following **must** also be submitted, as applicable:

- Surveys and/or plot plans for the property
- Appraisals and agreements, if available.
- Name of present owner and attach copy of deed conveying property unto present owner.
- Property address, Harwich Assessor's property identification (Map#, Parcel #).
- For proposed Open Space land purchases, be prepared to discuss public access with the Committee.

By signing below, the Applicant represents and warrants that all the information included is true and correct to the best of the signer's knowledge and belief. Further, the Applicant acknowledges in the event that the Community Preservation Committee agrees to grant funds to Applicant (and subject to Town Meeting approval), this application together with any Terms and Conditions shall constitute a binding agreement, between the Applicant and the Community Preservation Committee. Further, Applicant acknowledges and agrees to execute any additional grant agreements should the Community Preservation Committee so request.

ATTESTATION: I HEREBY ATTEST THAT THE INFORMATION CONTAINED IN THIS APPLICATION IS TRUE AND ACCURATE TO THE BEST OF MY KNOWLEDGE.

Signature - Chief Executive Officer or Board Chair

Title

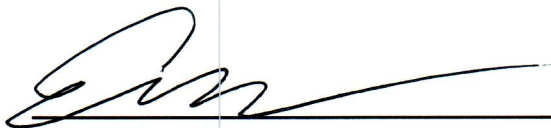

Recreation Director

Printed Name Eric Beebe

Date 10/30/20

APPLICATIONS MUST BE RECEIVED BY OCTOBER 30, 2020 NO LATER THAN 4 PM
Must submit eight (8) paper copies and if possible, a thumb drive (USB memory stick) containing a digital copy of the Application in a PDF file format.

WHITEHOUSE FIELD LIGHTING PROJECT

Whitehouse Field is one of the preeminent amateur baseball fields in New England and a very popular Recreational attraction for the Town of Harwich. It currently hosts our own Cape Cod Baseball League Harwich Mariners, as well as, the Monomoy Sharks Varsity High School Baseball Team. Whitehouse Field is also booked often for other private baseball organizations and is used for many special events highlighted by the ECAC Annual Division 3 Regional Baseball Championship Tournament. The amenities of Whitehouse Field include lights, press box, bleachers, bull pens, concession stand, merchandise stand, and batting cages. Whitehouse Field is one of the most valuable recreation assets that the Town of Harwich has and it is in the best interest of the Town and The Recreation Department and Commission to maintain it's current high status.

The Recreation Department and Commission is currently requesting funding in the amount of \$100,000 for phase 2 of the Whitehouse Field Lighting Project. This past year, Community Preservation Committee funded \$380,360 for this project and an additional \$75,000 was committed by the Harwich Mariners organization for Phase 1 of this project. Since receiving funds for this project, the Town Engineering Department, as well as, the Town Administrator's office has conducted an engineering and design study for this project from an outside engineering company. The results of this study concluded that the cost for this project would be higher than originally anticipated due to new and more advanced LED lighting systems available that would be more suitable for the project at hand. Therefore, we are requesting the additional funding in the amount of \$100,000 to complete this very valuable project for the Town of Harwich community. We, the Department and Commission, want to ensure that the project is done correctly and will provide a new system that is appropriate for the caliber of field that is Whitehouse and allow us to rely on this system for many years to come.

The current lighting system at Whitehouse Field was installed over 15 years ago and is antiquated in it's technology. In addition to this, the lighting structures that sit atop the poles are failing at an alarming rate. We have spent close to \$75,000 in the repair of these light structures over the past 4-5 years with no end in sight. The current system is at the end of it's useful life as indicated by failing bulbs, ballasts, wiring and the structure itself. Last fiscal year, we needed to request a \$20,000 emergency fund transfer from the Finance Committee to get the lights in working order for the busy summer baseball season.

We, the Recreation Department and Commission, submit this proposal as a means to maintaining the current status of Whitehouse Field and it's place in the notoriety of the Town of Harwich. We also see this as a fiscally responsible venture to eliminate future increased spending on maintenance on current failing lighting system.

We believe that a Recreational property like Whitehouse Field deserves the time and funding necessary to let it continue as a town recreational hub. It is unique in it's ability to bring people to our town, young and old, to enjoy one of the many attractions of Harwich.

CURRENT WHITEHOUSE FIELD USERS

- HARWICH MARINERS- CAPE LEAGUE BASEBALL
- MONOMOY VARSITY HIGH SCHOOL BASEBALL TEAM
- HARWICH RECREATION DEPARTMENT
- LOWER CAPE SENIOR BABE RUTH BASEBALL LEAGUE
- BASEBALL CLUBS OF CAPE COD AGES 18+
- BASEBALL CLUBS OF CAPE COD AGES 40+
- AMERICAN LEGION BASEBALL LEAGUE

SPECIAL EVENT WHITEHOUSE FIELD USES

- ECAC COLLEGIATE DIVISION 3 REGIONAL BASEBALL CHAMPIONSHIP TOURNAMENT
- CAPE COD CLASSIC LABOR DAY WEEKEND BASEBALL TOURNAMENT
- FRED THATCHER MEMORIAL ALUMNI HIGHSCHOOL BASEBALL GAME
- HARWICH MARINERS POSTSEASON PLAYOFF GAMES

WHITEHOUSE FIELD LIGHT USERS

- HARWICH MARINERS- CAPE LEAGUE BASEBALL
- MONOMOY VARSITY HIGH SCHOOL BASEBALL TEAM
- LOWER CAPE SENIOR BABE RUTH BASEBALL LEAGUE
- BASEBALL CLUBS OF CAPE COD AGES 18+
- BASEBALL CLUBS OF CAPE COD AGES 40+
- AMERICAN LEGION BASEBALL LEAGUE

TOWN DEPARTMENTS/COMMITTEES/GROUPS PROJECT INVOLVEMENT

HARWICH HIGHWAY DEPARTMENT

The Harwich Highway and Parks Department will assist in any prep work for the lighting system installation as well as handling routine maintenance once new system is in place. We conferred with Highway and Parks Department about the need for the new lighting system and the current lighting system's end of useful life.

RECREATION AND YOUTH COMMISSION

The Whitehouse Field Lighting Project and Community Preservation Committee Funding Application has been reviewed and approved by the Recreation and Youth Commission before October 30, 2020 submittal.

COMMUNITY PRESERVATION COMMITTEE

We are seeking funding for this project from the Community Preservation Committee and plan to present request to the Committee in the Fall of 2019. The Community Preservation Committee has, in the past, provided funds for several other Whitehouse Field Improvement Projects including: New Irrigation System, and New Infield.

HARWICH MARINERS

As the Harwich Mariners Cape Cod Baseball League Organization is the primary user of the lights at Whitehouse Field, we have worked closely with them to put together the specifications for the new LED lighting system proposed. The Harwich Mariners Organization is also working to raise funding to decrease the current request funding number.

WHITEHOUSE FIELD LIGHTING PROJECT PHASE 2 BUDGET/ITEMIZED FUNDING REQUEST

PROJECT TOTAL COST	\$551,286
INCLUDES MATERIALS, INSTALLATION AND DESIGN	
PREVIOUSLY ALLOCATED CPC APPROVED FUNDS	(\$380,760)
FINANCIAL CONTRIBUTION FROM HARWICH MARINERS	(\$75,000)
CHANGE/DIFFERENCE NEEDED TO COMPLETE PROJECT	\$95,526
CONTINGENCY ON PROJECT FUNDING	\$4,474
TOTAL FUNDING REQUEST FOR PHASE 2	\$100,000

Whitehouse Field Lighting Project Part 2—Further Budget Explanation

***Includes information from Engineering Study that also includes separate Whitehouse Field Scoreboard Project**

- **Scoreboard/Netting Appropriation- Annual Town Meeting 2019 Article 44- \$55,000**
- **Lighting Appropriation- Annual Town Meeting 2020 Article 35- \$380,360**
- **Harwich Mariners Donation- \$75,000**
- **Total Funding- \$510,360**
- **Spring 2021 Construction Cost Estimate (10/7/2020)- \$510,360**
- **Budget Placeholder for Safety Netting- \$10,000**
- **Delta- (\$88,636)**
- **CPC Request - \$100,000**

ALTERNATES

10/7/2020

DESCRIPTION	QUANTITY	UNIT	UNIT COST	TOTAL
SUBTOTAL				410,703
DESIGN CONTINGENCY		5 %		20,535
SUBTOTAL				431,238
ESCALATION (spring 2021)		2 %		8,625
TOTAL				439,863

WHITE HOUSE FIELD

Electrical:

Disc. existing scoreboard	1	EA	318.00	318
Disc. existing feeder	50	EA	2.52	126
30/20A/2P/3R	1	EA	268.00	268
Furnish Nevco scoreboard	1	EA	37,710.00	37,710
PVC-1"C-2#8 & 1#10	60	LF	4.70	282
F&I 30A c/b in pnl	1	EA	147.00	147
At shed D&R USL controller	1	EA	432.00	432
D&R all 5 ckts from panel to the existing controller	1	EA	241.00	241
F& I new Musco ltg control	1	EA	1,152.00	1,152
F&I new Musco sports clusters	6	EA	65,833.00	394,998
F&I 50A/3P c/b in exist. Pnl	6	EA	269.00	1,614
F&I 1 1/4"C-w/3#6 & 1#10 ckt	6	EA	254.40	1,526
Revamp exist. Pnl to accommodate 18 new poles	1	EA	1,170.00	1,170
Reconnect exist. Pole ckts to new Musco control	1	EA	826.00	826
- assumes reusing all existing U/G ltg ckts from 6 poles to shed				
Direct Job Expense	1	LS	10,000.00	10,000
Dispose of Score Board	1	LS	6,000.00	6,000
New Scoreboard footings	1	LS	10,000.00	10,000

SUBTOTAL				466,810
GENERAL CONDITIONS		10 %		46,681
SUBTOTAL				513,491
P&P BOND & INSURANCE		2 %		10,270
SUBTOTAL				523,761
FEE		5 %		26,188
SUBTOTAL				549,949

ALTERNATES

10/7/2020

DESCRIPTION	QUANTITY	UNIT	UNIT COST	TOTAL
DESIGN CONTINGENCY		5 %		27,497
SUBTOTAL				577,447
ESCALATION (spring 2021)		2 %		11,549
TOTAL				588,996

10-Year Cost of Ownership Comparison

Whitehouse Baseball Field LED Relight

Ben Layton
April 8, 2019

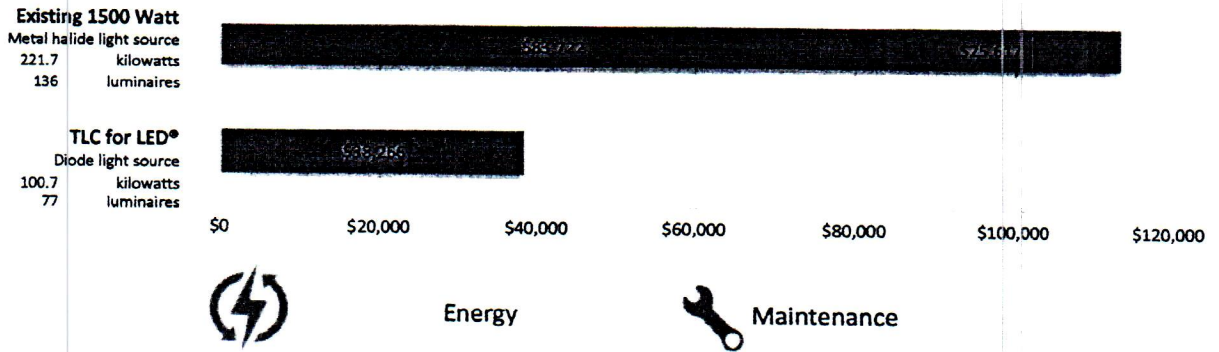

How is this possible? Musco's 40 years of developing systems, light control, and application expertise puts more available lumens per watt on the field. Our services team provides all on/off operation, monitoring, and maintenance.

For your budget . . . for the environment

Musco LED

\$ 10-Year Ownership Savings **\$75,259**

CO2 reduction 165 tons**

** Equivalent to taking 35 cars off the road for one year

Assumptions	70/50 footcandles
Annual operating hours	200
Energy	
Electric cost per kilowatt hour	\$0.14
Demand charge per kilowatt hour	\$0.00
Maintenance	
Group relamp cost per luminaire	\$266
Light maintenance over 10 years	\$0.00
Controls	
Leban - turning lights on & off	\$0.00
Lights on extra time without controls	\$0



We Make It Happen

Whitehouse Baseball Field LED Re-light
 Harrisville, N.H.

FIELD SUMMARY

Series:	Self-Install
Spacing:	30' D
Height:	317' above grade

FIELD SUMMARY

Scale Area per:	8182' x 531'
Lot Area:	3811' x 530'
Min. Area:	5311' x 66'
No. of Poles:	74
Color (C):	S100K - 75 OH
Luminaire Output:	156,000 / 50,000 lumens
No. of Luminaires:	94
Test Load:	178.21 W

Luminaire Type:	U90 1x	880 lbs	L10 lbs
TLC-LED-1500:	>81,000	>81,000	>81,000
TLC-B-E-575:	>81,000	>81,000	>81,000

Guaranteed Performance: The ILLUMINATION described above is guaranteed per your Musco Warranty document.

Field Measurements: Individual field measurements may vary from computer-aided predictions and should be taken in accordance with IESNA RP-6-15.

Electrical System Requirements: Refer to Ampage Draw Chart and/or the "Wiring Control System Summary" for electrical sizing.

Installation Requirements: Results assume a 3% nominal voltage at the site of the driver and structures located within 5 feet (1.5m) of design location.



We Make It Happen
 Musco Lighting, LLC • 800.1.210.1000 • www.musco.com

ILLUMINATION SUMMARY

EQUIPMENT LIST FOR AREAS SHOWN

QTY	LOCATION	SIZE	HEIGHT	TYPE	WATTAGE	POLE	WIND	WIND
2	A1-A2	105"	15.5'	TLC-B-E-575	10	2	0	0
2	B1-B2	90"	15.5'	TLC-LED-1500	18	3	0	0
2	C1-C2	90"	15.5'	TLC-B-E-575	3	3	0	0
6			90"	TLC-LED-1500	12	12	0	0

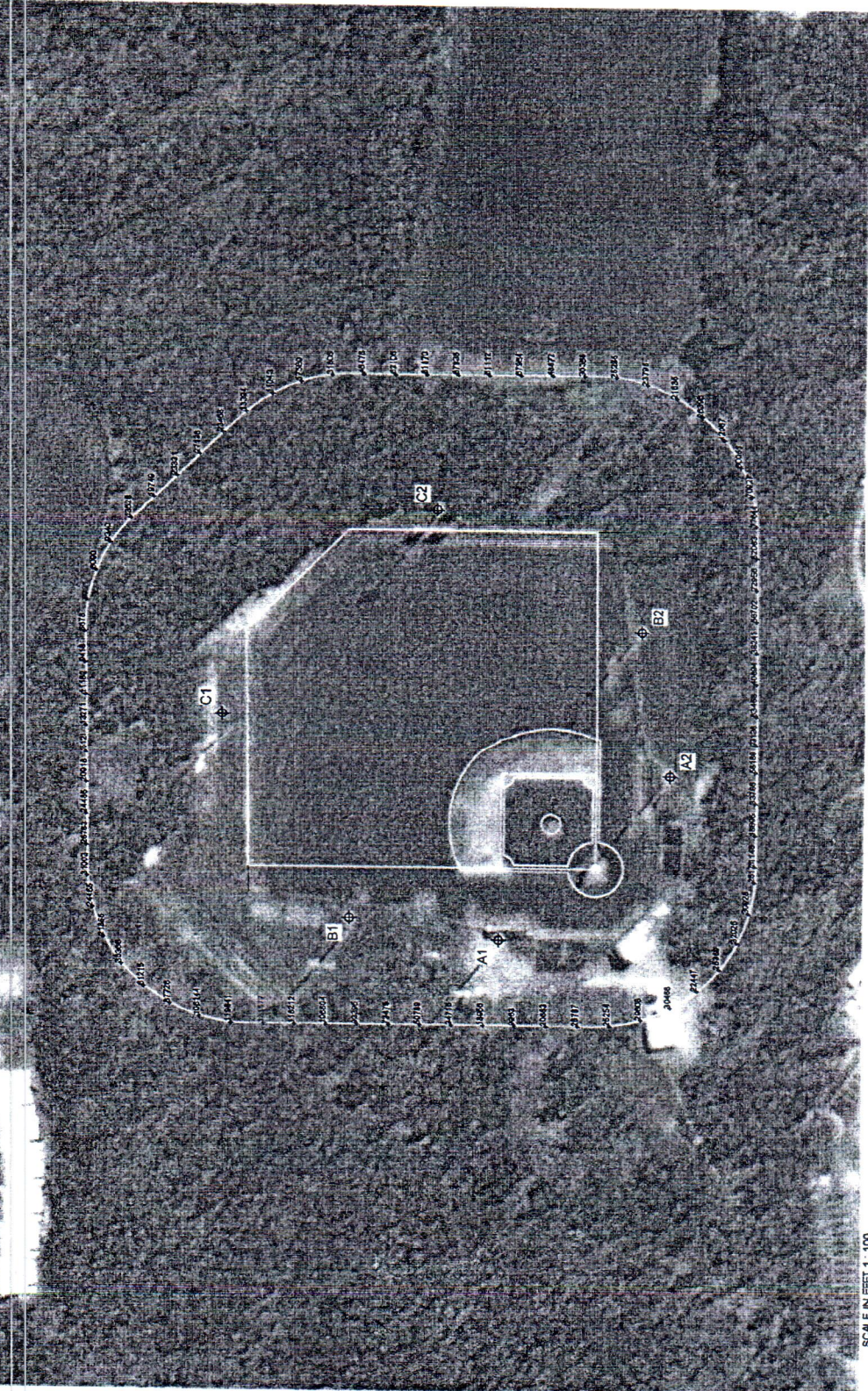

Pole location(s) + dimensions are relative to 8.0 reference point(s)

SCALE IN FEET 1:100



ENGINEERED DESIGN By: Markie Rothe • File #194150A • 01-Mar-19

Not to be reproduced, published, or used without the written consent of Musco Lighting, LLC • 800.1.210.1000 • www.musco.com

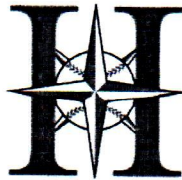

HARWICH MARINERS
PO Box 201, Harwich Port, MA 02646

Eric Beebe
Recreation Director
Town of Harwich
Recreation Department

Mr. Beebe,

The Harwich Athletic Association is excited to learn the Town of Harwich Recreation Department and Recreation Commission are seeking Community Preservation Act (CPA) funding for a retrofit of the light fixtures at Whitehouse Field in 2020. The aging field lighting system at Whitehouse Field is in dire need of an update and we would like to assist in the funding of this potential project in 2020.

The Harwich Athletic Association is committed to seeing this project come to fruition, our Board of Directors and many volunteers understand the need for properly working and efficient lights for the playing surface. The Harwich Mariners will commit a \$75,000.00 contribution towards the field lighting project at Whitehouse Field, if the CPA should select the project for its 2020 fiscal year funding.

Thank You and the Harwich Recreation Commission for your continued support of Whitehouse Field. Whitehouse Field is enjoyed and loved by thousands each year and we will continue to help keep the facility safe and user friendly however we can.

A handwritten signature in black ink, appearing to read 'Ben Layton', written in a cursive style.

Ben Layton
General Manager
Harwich Mariners Baseball
Cape Cod Baseball League