



P.O. Box 101, South Harwich, MA 02661
Ph. 508-432-3997 • E-mail: info@harwichconservationtrust.org
www.harwichconservationtrust.org

To: Town of Harwich Community Preservation Committee
From: Michael Lach, Executive Director, Harwich Conservation Trust (HCT)
Date: April 13, 2023
Subject: Status Report
2021 Town Mtg. Article #34 Harwich Natural Heritage Trail Project, Phase One
2022 Town Mtg. Article #34 Harwich Natural Heritage Trail Project, Phase Two

Thank you for the opportunity to provide a status report for Phase One & Two of the Harwich Natural Heritage Trail Project located at HCT's Robert F. Smith Cold Brook Preserve in Harwich Port. To summarize, Phase One focuses on design, permitting, and construction of the half-mile wheelchair accessible trail loop in the westerly portion of the Preserve. Phase Two focuses on design, permitting, and construction of the approx. 100 ft. boardwalk in the easterly portion of the Preserve.

Since the last status report dated Oct. 13, 2022, HCT representatives attended meetings that included Phase One & Phase Two aspects of the Harwich Natural Heritage Trail Project on the following dates:

- Nov. 2, 3, 16 and 28, 2022
- Feb. 8 (two meetings) and 10, 2023
- March 1, 3 and 8, 2023
- April 5 and 6, 2023

The following project partners and representatives participated:

- Harwich Conservation Trust (HCT): Tom Evans, President; Colin Leonard, Trustee & Chair of Land Stewardship Committee; Michael Lach, Exec. Dir.; Connor O'Brien, Dir. of Land Stewardship
- The Compact of Cape Cod Conservation Trusts, Inc.: Kelly Grant, Land Protection Specialist
- MA Division of Ecological Restoration: Kate Bentsen, Ecological Restoration Specialist & Ecohydrologist; Eric Ford, Ecological Restoration Specialist & Professional Wetland Scientist
- Inter-Fluve [engineering firm specializing in river & wetland ecological restoration & access projects, website link: [Inter-Fluve | River Restoration and Water Resources Engineering \(interfluve.com\)](http://interfluve.com)]
 - Nick Nelson, Regional Director & Fluvial Geomorphologist
 - Mike Burke, Principal Engineer
 - Emmanuel da Costa, Engineer
- Stimson Associates Landscape Architects, website link: [STIMSON \(stimsonstudio.com\)](http://stimsonstudio.com)
 - Joe Wahler, Ryosuke Takahashi, Cassandra Lanson (Landscape Architects)
- The BSC Group, website link: [Home Page - BSC Group](#)

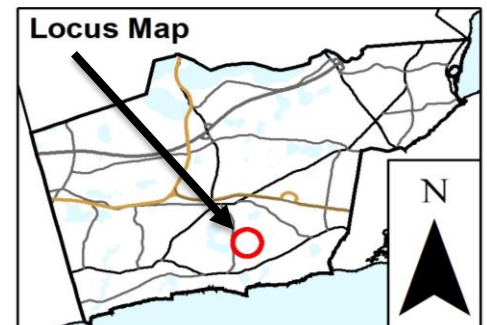

Location of Cold Brook Preserve

- Brian Yergatian, Principal Engineer
- Casey-Lee Bastien, Landscape Architect

Design & Permitting Progress:

As mentioned in the fall 2022 status report, Stimson Associates Landscape Architects generated engineered design plans (please see attached) for both the proposed half-mile wheelchair accessible trail loop and approx. 100 ft. boardwalk. Since the fall, Stimson and Inter-Fluve have been refining the designs and Inter-Fluve has been advancing the overall project through the permitting process with state and federal agencies, which is nearly complete. Recall that in Aug. 2022, the Town of Harwich Conservation Commission voted its approval of a Notice of Intent permit with corresponding Order of Conditions.

Property Acquisition & Parking:

Parking for the Cold Brook Preserve had historically been located since 2001 at the town-owned property known collectively as 203 Bank Street, an assemblage of four parcels totaling approx. 2 acres. That property is comprised of Parcels B2, B2-1 and B3 shown on Assessor Map 23 as well as Parcel R7-B on Assessor Map 32. This parking site has provided visitor access and adequate driver safety sight lines along either direction of Bank Street.

In June 2022, HCT partnered with the nonprofit Harwich Fire Association (HFA) to submit a joint proposal in response to a request for proposals from the Select Board regarding purchase of the property for \$300,000. HFA's primary goal is to restore the architectural features of the Town's first fire station to offer the public an opportunity to see an antique fire engine and other memorable aspects of the Town's public safety history.

The Select Board selected the HCT/HFA proposal. Property conveyance from Town to HCT/HFA was completed on December 8, 2022.

On Sept. 15, 2022, HCT released a request for proposals seeking qualified contractors to bid on Phase Three for the parking area design in order to integrate parking with the wheelchair accessible trailhead, viewing area, and half-mile trail loop. In late October, HCT selected The BSC Group to design an enhanced parking area, trail connector to the envisioned Phase One wheelchair accessible trail loop, and viewing overlook.

As shown on the attached draft parking area design, the proposed location of the viewing overlook will allow visitor access from the parking area to the connector trail that links the parking area to the wheelchair accessible trail loop. In other words, the connector trail is the segment of wheelchair accessible trail extending from the parking area to the half-mile wheelchair accessible trail loop.

Free Guided Walks:

Since the fall, Harwich Conservation Trust's Director of Land Stewardship Connor O'Brien has been leading free guided walks at the Robert F. Smith Cold Brook Preserve. These walks are open to the public and help participants learn about the important changes that will result from the planned ecological restoration designed to improve the health of habitats, water quality, and wildlife as well as enhance the visitor experience including the trail elements funded by Town CPA funds.

These free guided walks have been offered on the following dates:

- Sept. 22 and 29, 2022
- Oct. 12, 13 and 19, 2022
- Nov. 2, 9, 23 and 30 2022
- Dec. 14, 2022

- March 1, 8, 22 and 29, 2023
- April 5, 2023

Status of CPA funding disbursement:

In November 2022, HCT submitted paid invoices to the Town Accounting Dept. and received a Community Preservation Act (CPA) fund disbursement of \$47,573.00 toward the 75% design and permitting of the wheelchair accessible trail.

Next steps:

- HCT and Town of Harwich Select Board finalize written agreement that governs the overall eco-restoration construction funding from town, state, and federal sources.
- HCT continue work with The BSC Group on Phase Three design (parking area design/integration with wheelchair accessible trailhead, viewing area, and connector to half-mile trail loop).
- Permitting to be completed in spring 2023.
- Eco-restoration construction to begin summer/fall 2023 and last until spring 2024.
- Trail construction aspects to begin winter 2024 and last through spring with ½-mile wheelchair accessible trail loop and parking area to be final construction elements.

Attachments:

- March 17, 2023 draft parking area design from The BSC Group
- June 30, 2022 wheelchair accessible trail loop with stream crossings and boardwalk design/construction plans from Stimson Associates Landscape Architects

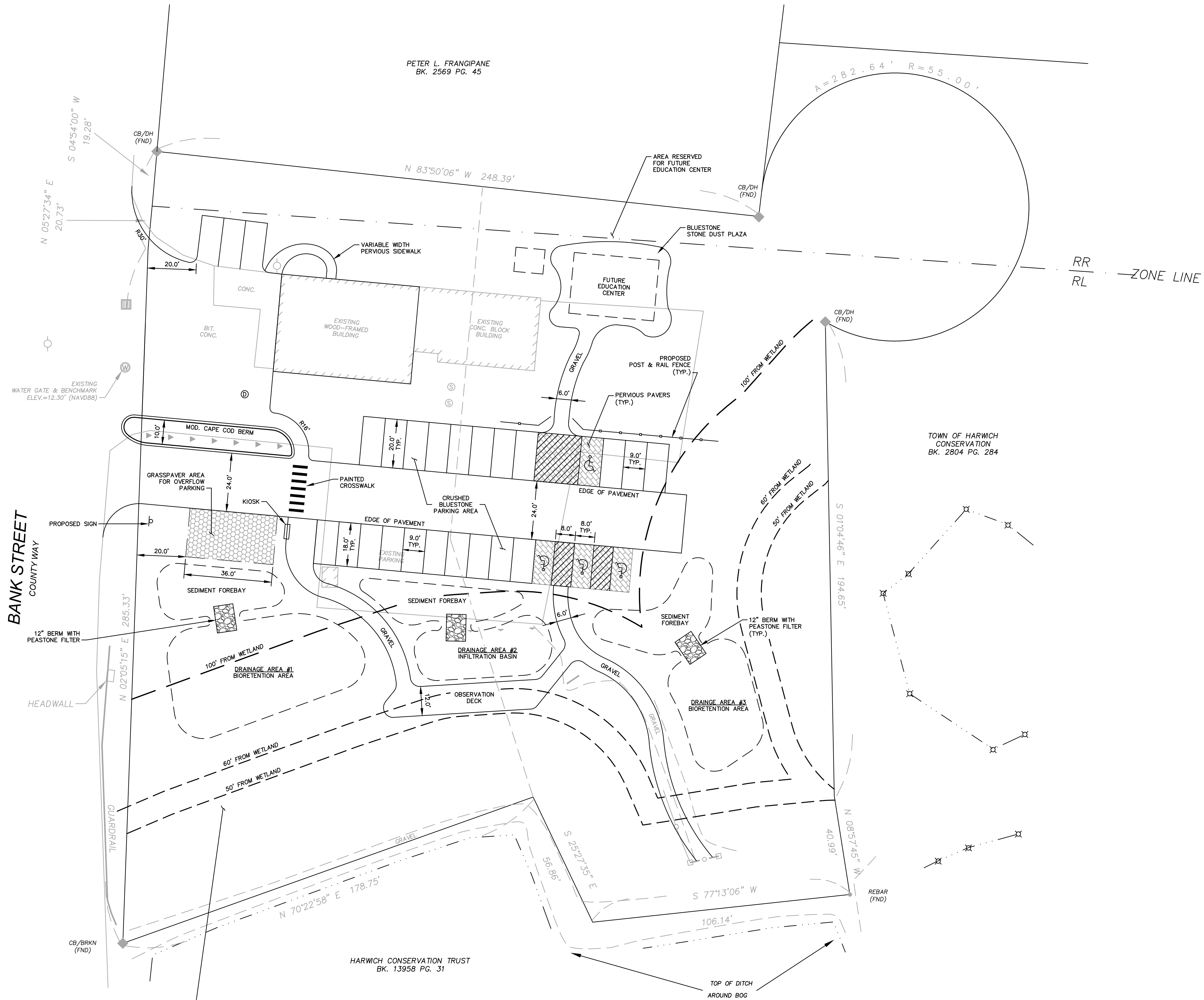

BANK STREET
COUNTY WAY

AREA INCLUSIVE OF CINNAMON FERN (WETLAND)
CONTAINS LESS THAN 2,000 SQ.FT. DOES NOT
MEET HARWICH CONSERVATION THRESHOLD OF
3,000 SQ.FT.+ OR THE STATE REGULATIONS

**PRELIMINARY
PLAN**
(FOR DISCUSSION ONLY)

FOR THE BSC GROUP, INC. DATE
PROFESSIONAL ENGINEER

**COLD BROOK
GATEWAY PARKING &
TRAILHEAD DESIGN**

BANK STREET
IN
HARWICH
MASSACHUSETTS
(BARNSTABLE COUNTY)

LAYOUT & MATERIALS
PLAN

MARCH 17, 2023

REVISIONS:

| NO. | DATE | DESC. |
|-----|------|-------|
| | | |
| | | |
| | | |
| | | |
| | | |
| | | |
| | | |
| | | |
| | | |
| | | |

PREPARED FOR:



HARWICH CONSERVATION TRUST
P.O. BOX 101
SOUTH HARWICH, MA 02661
www.harwichconservationtrust.org



BSC GROUP

349 Main Street - Route 28
West Yarmouth, Massachusetts
02673
508 778 8919

© 2023 BSC Group, Inc.
SCALE: 1" = 20'
0 10 20 40 FEET

FILE: YAR\5074300\C\5074300-SP.dwg
DWG: SHEET OF
JOB. NO: 5-0743.00

COLD BROOK ECO-RESTORATION PROJECT

HARWICH CONSERVATION TRUST (HCT)
0 Bank St. Harwich Port, MA 02646

CONSTRUCTION DOCUMENT
June 30, 2022

DRAWING LIST

L1.0 SITE PLAN
L1.1 ADA ACCESS PLAN
L1.2 OVERLOOK ENLARGEMENT PLAN
L2.0 CROSSING 1 PLAN & SECTION
L2.1 CROSSING 2 PLAN & SECTION
L2.2 CROSSING 3 PLAN & SECTION
L2.3 BOARDWALK PLAN & SECTION
L3.0 DETAILS-1
L3.1 DETAILS-2

ABBREVIATIONS

| | | | | | |
|----------|---------------------|--------|------------------------|-------|------------------------|
| @ | AT | EW | EACH WAY | PA | PLANTING AREA |
| ARCH | ARCHITECT | FEE | FINISH FLOOR ELEVATION | ± | PLUS OR MINUS |
| B&B | BALL AND BURLAP | FG | FINISH GRADE | PC | POINT OF CURVATURE |
| BC | BOTTOM OF CURB | FOC | FACE OF CURB | PERF | PERFORATED |
| BLDG | BUILDING | FOW | FACE OF WALL | POB | POINT OF BEGINNING |
| BIT CONC | BITUMINOUS CONCRETE | FS | FINISH SURFACE | POC | POINT OF CONNECTION |
| BOC | BACK OF CURB | GALV | GALVANIZED | PSI | POUNDS PER SQUARE INCH |
| BS | BOTTOM OF STEP | GB | GRADE BREAK | PT | POINT OF TANGENCY |
| CAL | CALIPER | HH | HANDHOLE | R | RADIUS |
| CB | CATCH BASIN | HORIZ | HORIZONTAL | ROW | RIGHT OF WAY |
| CJ | CONTROL JOINT | HP | HIGH POINT | SJ | SCORE JOINT |
| CIP | CAST IN PLACE | ID | INSIDE DIAMETER | SQ | SQUARE |
| CL | CENTER LINE | INV | INVERT | SS | STAINLESS STEEL |
| CLR | CLEARANCE | JT | JOINT | STRUC | STRUCTURAL |
| CO | CLEAN OUT | LAND | LANDSCAPE | STD | STANDARD |
| COL | COLUMN | LN | LAWN | STL | STEEL |
| CONC | CONCRETE | LONGIT | LONGITUDINAL | T&B | TOP AND BOTTOM |
| CONT | CONTINUOUS | LOW | LIMIT OF WORK | TC | TOP OF CURB |
| ∅ | DIAMETER | LP | LOW POINT | TD | TRENCH DRAIN |
| DN | DOWN | LT | LIGHT POLE | TFG | TOP OF FOOTING |
| DTL | DETAIL | MH | MANHOLE | TS | TOP OF STEP |
| DWG/S | DRAWING/S | MAX | MAXIMUM | TYP | TYPICAL |
| EA | EACH | MFTR | MANUFACTURER | UON | UNLESS OTHERWISE NOTED |
| EJ | EXPANSION JOINT | MIN | MINIMUM | VEH | VEHICULAR |
| ELECT | ELECTRICAL | NIC | NOT IN CONTRACT | VERT | VERTICAL |
| ELEV | ELEVATION | NTS | NOT TO SCALE | VIF | VERIFY IN FIELD |
| EOP | EDGE OF PAVEMENT | OC | ON CENTER | W/ | WITH |
| EQ | EQUAL | OD | OUTSIDE DIAMETER | | |

STEPHEN STIMSON ASSOCIATES
LANDSCAPE ARCHITECTS, INC.
288 NORFOLK STREET, CAMBRIDGE MA 02139
PH (617) 876-8960

All rights reserved. The drawings, designs, and ideas embodied therein are property of Stephen Stimson Associates and shall not be copied, reproduced, or disclosed in connection with any work other than the project for which they have been prepared, in whole or part, without prior written authorization of Stephen Stimson Associates.



LEGEND
 ——— EXISTING CONTOURS
 ——— PROPOSED CONTOURS
 - - - MOWED PATH EDGE
 - - - PROPERTY BOUNDARY
 - - - CENTERLINE

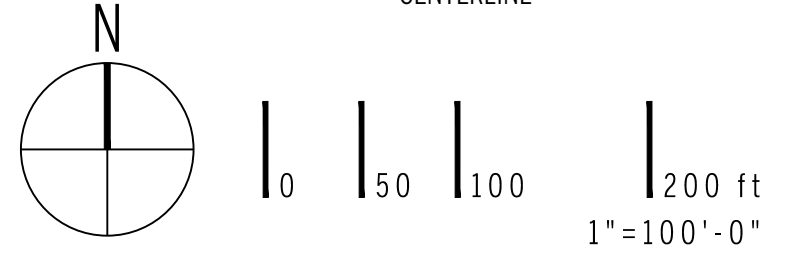

LANDSCAPE ARCHITECT
STIMSON
 STEPHEN STIMSON ASSOCIATES LANDSCAPE ARCHITECTS, INC.
 288 NORFOLK STREET CAMBRIDGE, MA 02139 T 617 876 8960
 71 GATES ROAD PRINCETON, MA 01541 T 978 464 5200
 STIMSONSTUDIO.COM

STRUCTURAL ENGINEER
 RSE ASSOCIATES, INC.
 63 PLEASANT STREET SUITE 200 WATERTOWN, MA 02472 T 617 926 9300

ENVIRONMENTAL ENGINEER
 INTER-FLUVE
 220 CONCORD AVENUE, 2ND FLOOR CAMBRIDGE, MA 02138 T 617 714 5537

**COLD BROOK
 ECO-RESTORATION PROJECT**
 HCT
 0 BANK ST
 HARWICH PORT, MA 02646

| ISSUE | DATE | DESCRIPTION |
|-------|------|-------------|
| 1 | | |
| 2 | | |
| 3 | | |
| 4 | | |
| 5 | | |
| 6 | | |
| 7 | | |
| 8 | | |

SCALE
 1"=100'-0"
 DATE
 06.30.2022
 DRAWN BY
 RT, CL
 REVIEWED BY
 JW

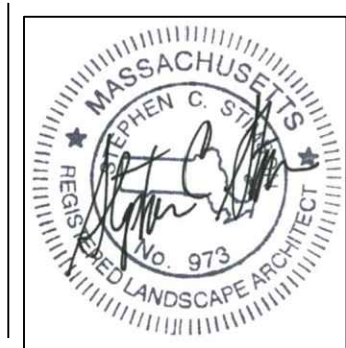

SITE PLAN
 CONSTRUCTION DOCUMENT | **L1.0**

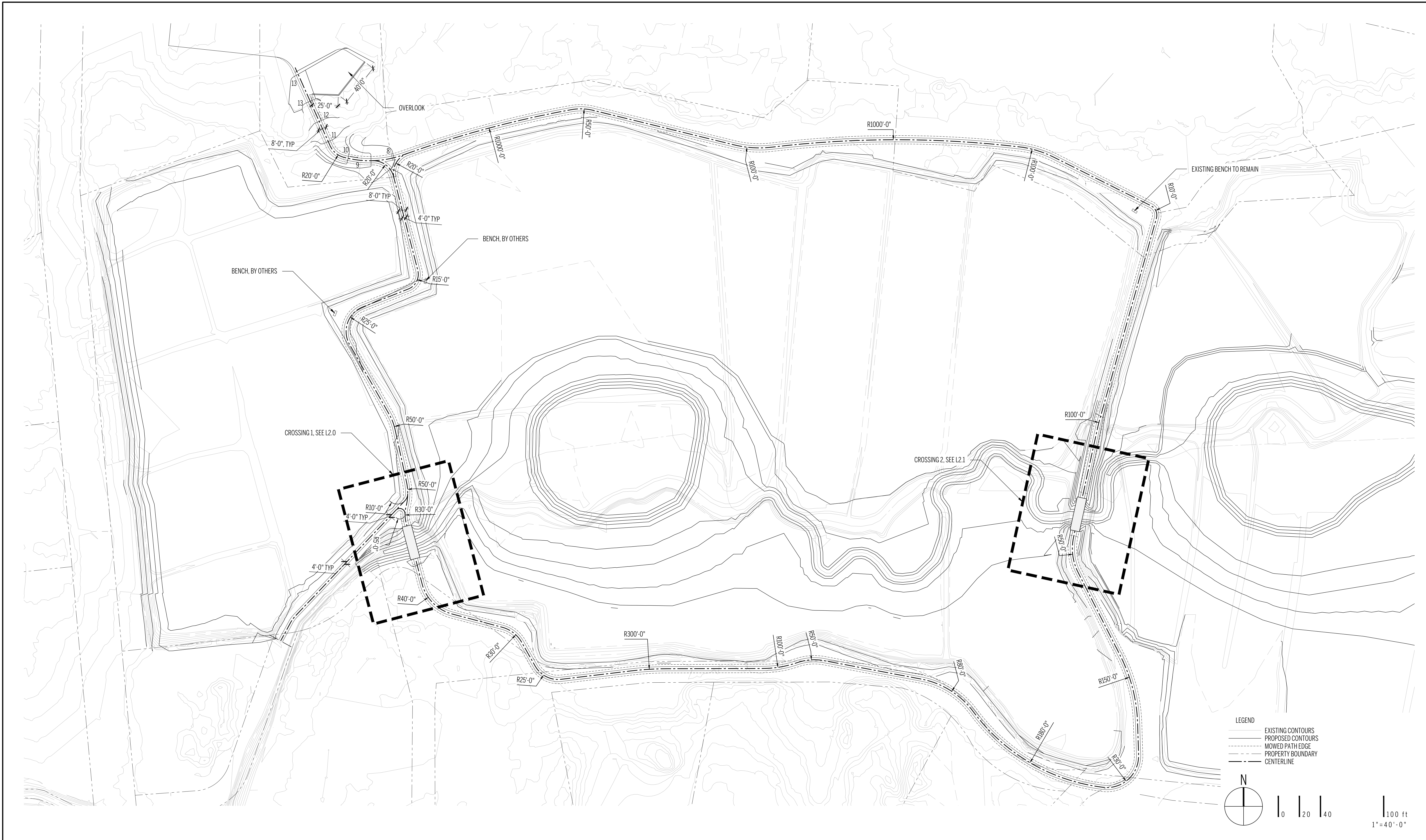

- LEGEND
- EXISTING CONTOURS
 - PROPOSED CONTOURS
 - MOWED PATH EDGE
 - PROPERTY BOUNDARY
 - CENTERLINE

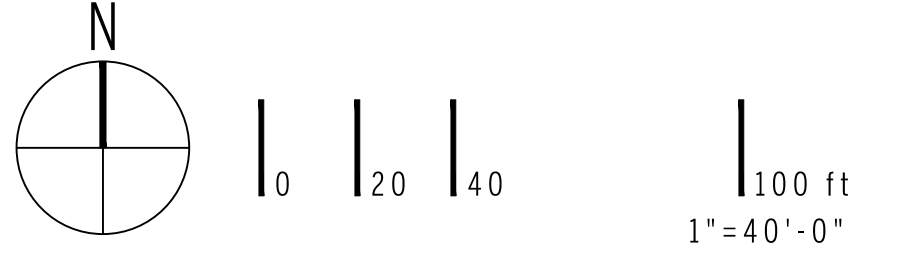

LANDSCAPE ARCHITECT
STIMSON
 STEPHEN STIMSON ASSOCIATES LANDSCAPE ARCHITECTS, INC.
 288 NORFOLK STREET
 CAMBRIDGE, MA 02139
 T 617 876 8960
 71 GATES ROAD
 PRINCETON, MA 01541
 T 978 464 5200
 STIMSONSTUDIO.COM

STRUCTURAL ENGINEER
RSE ASSOCIATES, INC.
 63 PLEASANT STREET
 SUITE 200
 WATERTOWN, MA 02472
 T 617 926 9300

ENVIRONMENTAL ENGINEER
INTER-FLUVE
 220 CONCORD AVENUE, 2ND FLOOR
 CAMBRIDGE, MA 02138
 T 617 714 5537

**COLD BROOK
 ECO-RESTORATION PROJECT**
 HCT
 0 BANK ST
 HARWICH PORT, MA 02646

| ISSUE | DATE | DESCRIPTION |
|-------|------|-------------|
| 1 | | |
| 2 | | |
| 3 | | |
| 4 | | |
| 5 | | |
| 6 | | |
| 7 | | |
| 8 | | |

SCALE
 1" = 40'-0"
 DATE
 06.30.2022
 DRAWN BY
 RT, CL
 REVIEWED BY
 JW

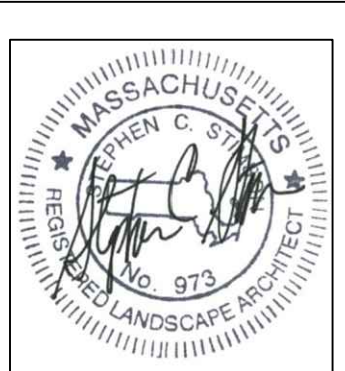

ADA ACCESS PLAN
CONSTRUCTION DOCUMENT | **L1.1**

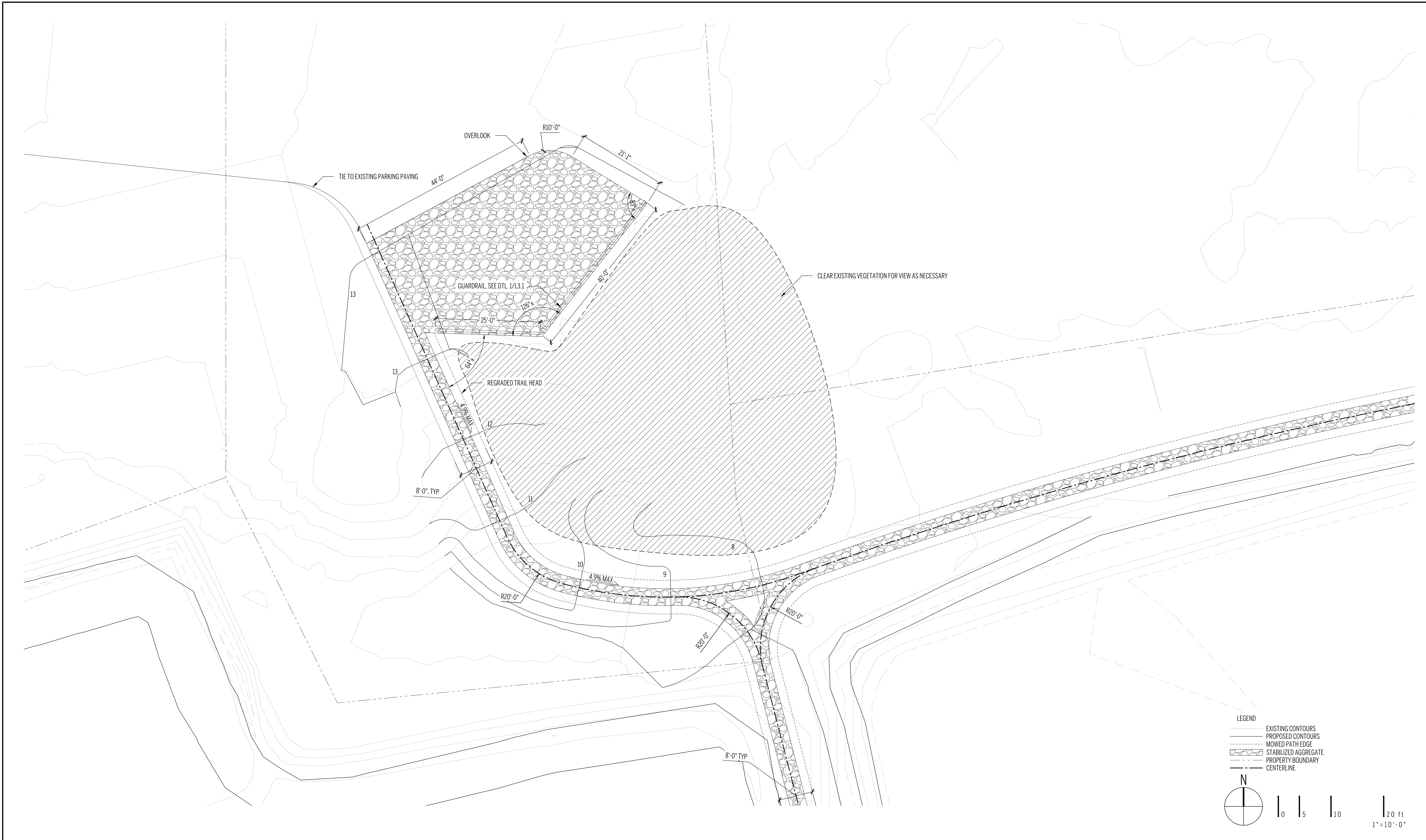

LEGEND

- EXISTING CONTOURS
- PROPOSED CONTOURS
- - - MOWED PATH EDGE
- ▨ STABILIZED AGGREGATE
- - - PROPERTY BOUNDARY
- CENTERLINE

N

0 5 10 20 ft
1"=10'-0"

LANDSCAPE ARCHITECT
STIMSON
 STEPHEN STIMSON ASSOCIATES LANDSCAPE ARCHITECTS, INC.
 288 NORFOLK STREET CAMBRIDGE, MA 02139
 71 GATES ROAD PRINCETON, MA 01541
 T 617 876 8960 T 978 464 5200
 STIMSONSTUDIO.COM

STRUCTURAL ENGINEER
RSE ASSOCIATES, INC.
 63 PLEASANT STREET SUITE 200
 WATERTOWN, MA 02472
 T 617 926 9300

ENVIRONMENTAL ENGINEER
INTER-FLUVE
 220 CONCORD AVENUE, 2ND FLOOR
 CAMBRIDGE, MA 02138
 T 617 714 5537

**COLD BROOK
 ECO-RESTORATION PROJECT**
 HCT
 0 BANK ST
 HARWICH PORT, MA 02646

| ISSUE | DATE | DESCRIPTION |
|-------|------|-------------|
| 1 | | |
| 2 | | |
| 3 | | |
| 4 | | |
| 5 | | |
| 6 | | |
| 7 | | |
| 8 | | |

SCALE
 1"=10'-0"
 DATE
 06.30.2022
 DRAWN BY
 RT, CL
 REVIEWED BY
 JW

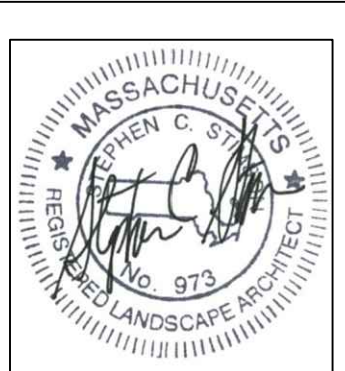

OVERLOOK
 CONSTRUCTION DOCUMENT
L1.2

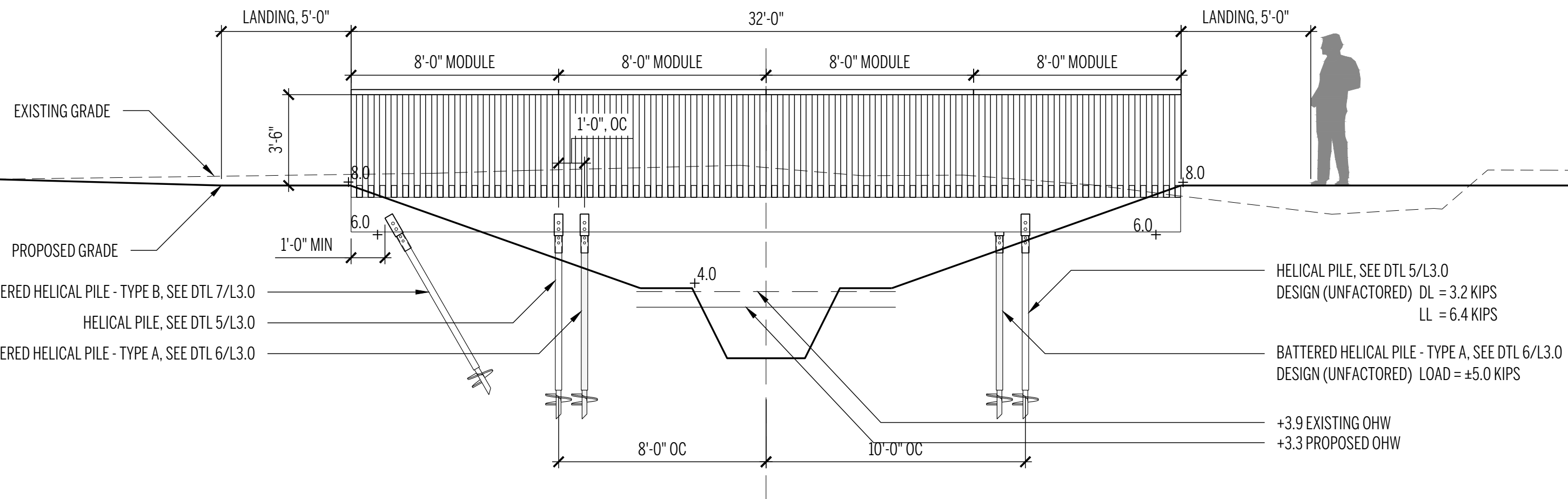

2 CROSSING SECTION FACING DOWNSTREAM
1/4" = 1'-0"

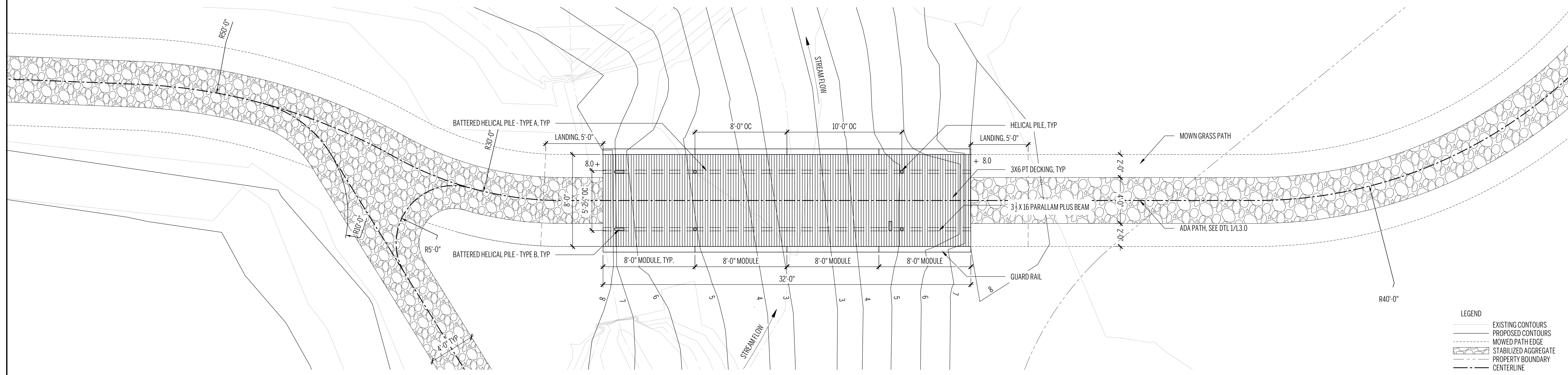

- LEGEND
- EXISTING CONTOURS
 - PROPOSED CONTOURS
 - MOWN PATH EDGE
 - STABILIZED AGGREGATE
 - PROPERTY BOUNDARY
 - CENTERLINE

1 CROSSING 1 PLAN
1/4" = 1'-0"

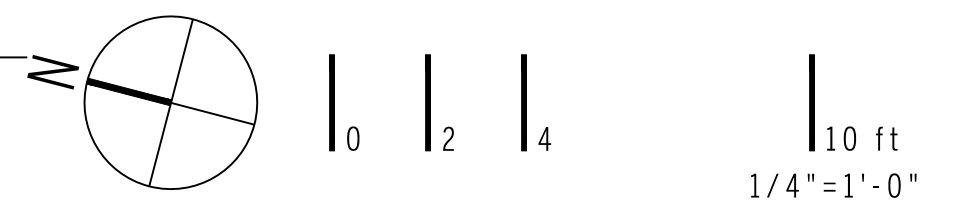

**COLD BROOK
ECO-RESTORATION PROJECT**

HCT
0 BANK ST
HARWICH PORT, MA 02646

LANDSCAPE ARCHITECT
STIMSON
STEPHEN STIMSON ASSOCIATES LANDSCAPE ARCHITECTS, INC.
288 NORFOLK STREET
CAMBRIDGE, MA 02139
T 617 876 8960
STIMSONSTUDIO.COM

STRUCTURAL ENGINEER
RSE ASSOCIATES, INC.
63 PLEASANT STREET
SUITE 200
WATERTOWN, MA 02472
T 617 926 9300

ENVIRONMENTAL ENGINEER
INTER-FLUVE
220 CONCORD AVENUE, 2ND FLOOR
CAMBRIDGE, MA 02138
T 617 714 5537

| ISSUE | DATE | DESCRIPTION |
|-------|------|-------------|
| 1 | | |
| 2 | | |
| 3 | | |
| 4 | | |
| 5 | | |
| 6 | | |
| 7 | | |
| 8 | | |

SCALE
1/4" = 1'-0"
DATE
06.30.2022
DRAWN BY
RT, CL
REVIEWED BY
JW

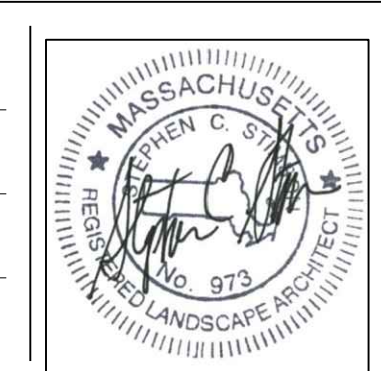

**CROSSING 1
PLAN & SECTION**

CONSTRUCTION DOCUMENT | **L2.0**

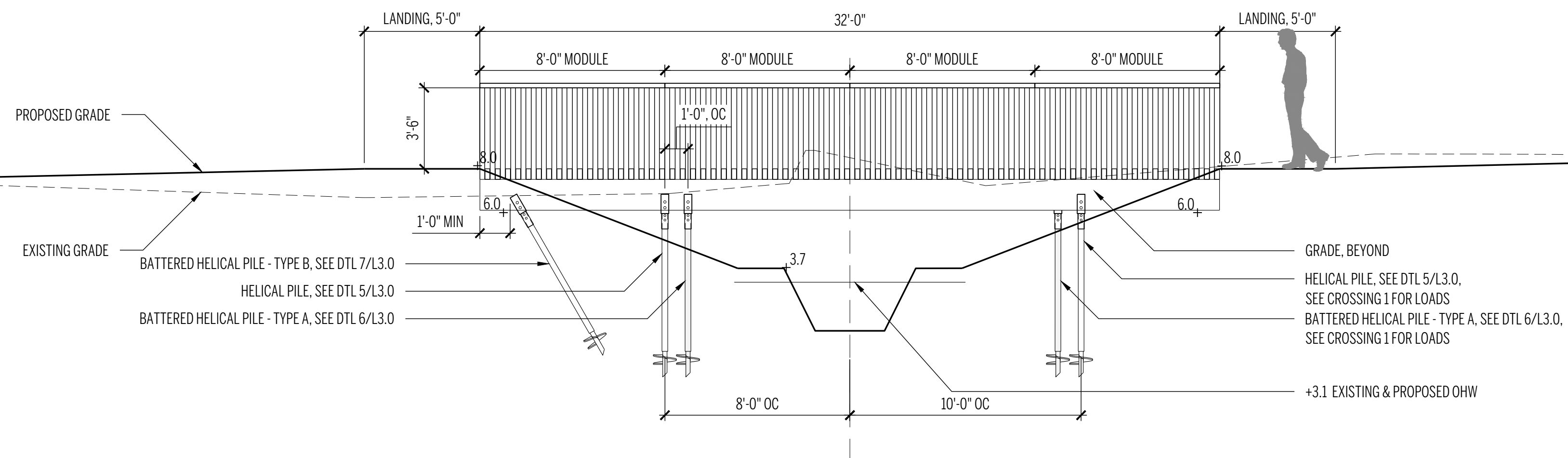

2 CROSSING SECTION FACING DOWNSTREAM
1/4" = 1'-0"

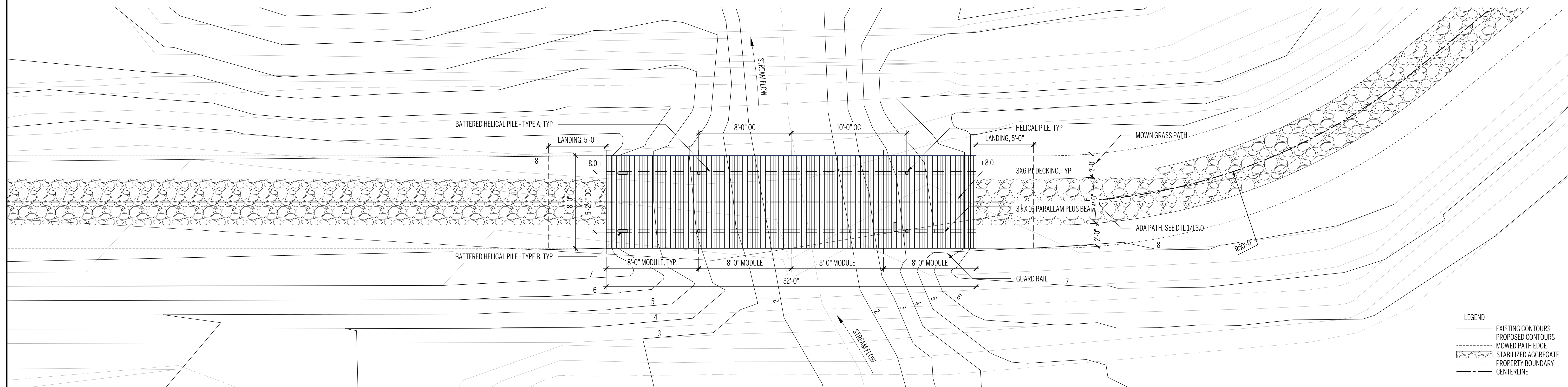

1 CROSSING 2 PLAN
1/4" = 1'-0"

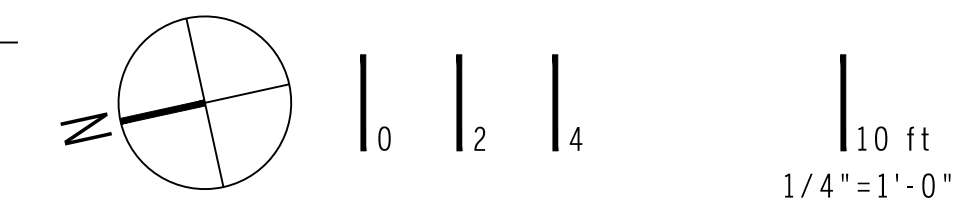

**COLD BROOK
ECO-RESTORATION PROJECT**
HCT
0 BANK ST
HARWICH PORT, MA 02646

| ISSUE | DATE | DESCRIPTION |
|-------|------|-------------|
| 1 | | |
| 2 | | |
| 3 | | |
| 4 | | |
| 5 | | |
| 6 | | |
| 7 | | |
| 8 | | |

SCALE
1/4" = 1'-0"
DATE
06.30.2022
DRAWN BY
RT, CL
REVIEWED BY
JW

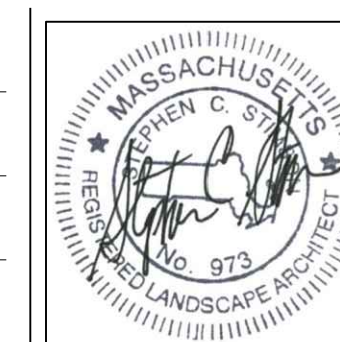

**CROSSING 2
PLAN & SECTION**
**CONSTRUCTION
DOCUMENT** | **L2.0**

LANDSCAPE ARCHITECT
STIMSON
STEPHEN STIMSON ASSOCIATES LANDSCAPE ARCHITECTS, INC.
288 NORFOLK STREET
CAMBRIDGE, MA 02139
T 617 876 8960
STIMSONSTUDIO.COM

STRUCTURAL ENGINEER
RSE ASSOCIATES, INC.
63 PLEASANT STREET
SUITE 200
WATERTOWN, MA 02472
T 617 926 9300

ENVIRONMENTAL ENGINEER
INTER-FLUVE
220 CONCORD AVENUE, 2ND FLOOR
CAMBRIDGE, MA 02138
T 617 714 5537

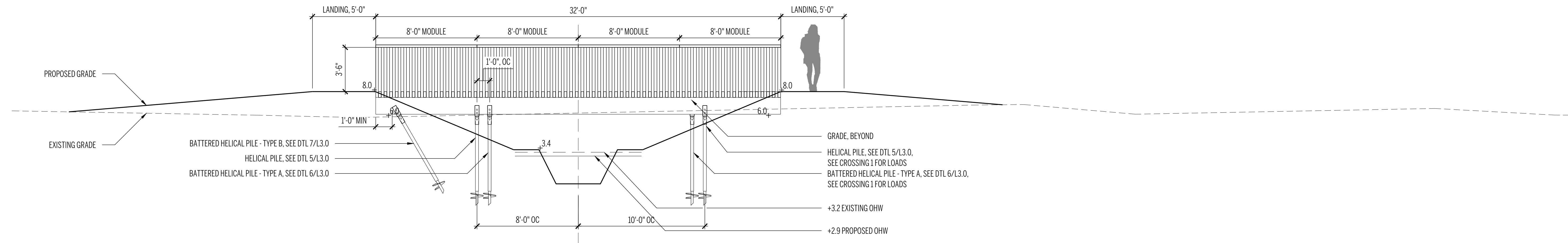

2 CROSSING SECTION FACING DOWNSTREAM
1/4" = 1'-0"

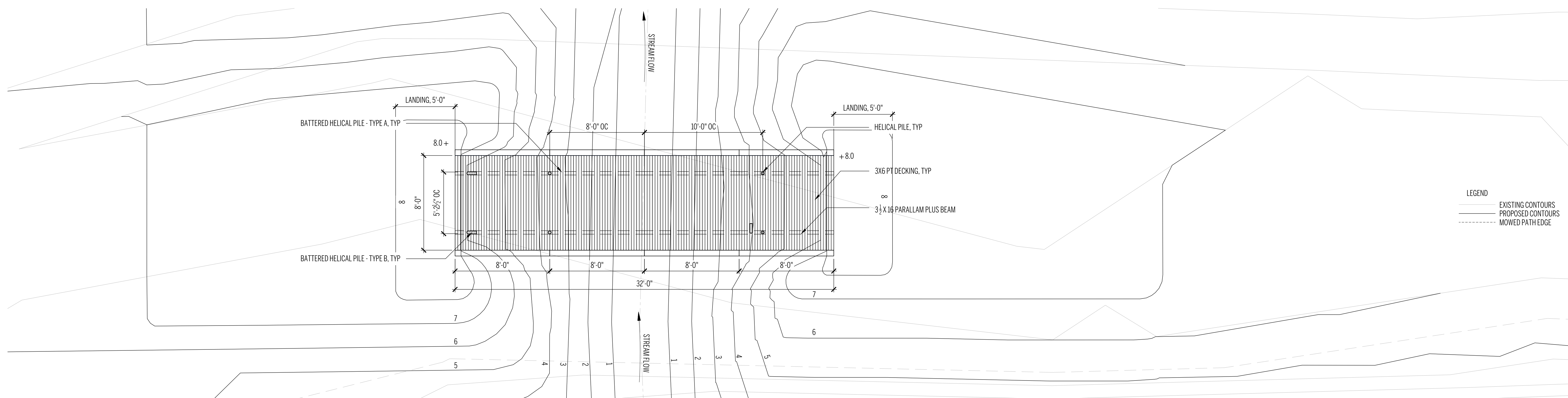

1 CROSSING 3 PLAN
1/4" = 1'-0"

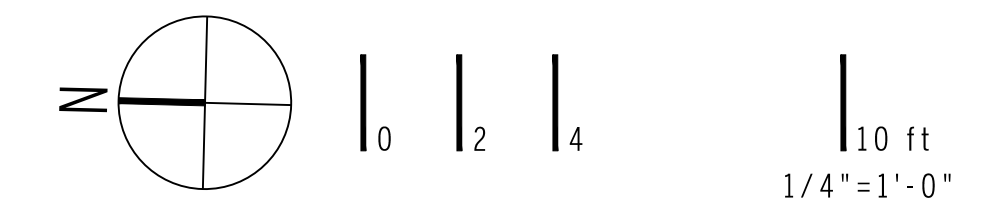

LANDSCAPE ARCHITECT
STIMSON
STEPHEN STIMSON ASSOCIATES LANDSCAPE ARCHITECTS, INC.
288 NORFOLK STREET
CAMBRIDGE, MA 02139
T 617 876 8960
71 GATES ROAD
PRINCETON, MA 01541
T 978 464 5200
STIMSONSTUDIO.COM

STRUCTURAL ENGINEER
RSE ASSOCIATES, INC.
63 PLEASANT STREET
SUITE 200
WATERTOWN, MA 02472
T 617 926 9300

ENVIRONMENTAL ENGINEER
INTER-FLUVE
220 CONCORD AVENUE, 2ND FLOOR
CAMBRIDGE, MA 02138
T 617 714 5537

**COLD BROOK
ECO-RESTORATION PROJECT**
HCT
0 BANK ST
HARWICH PORT, MA 02646

| ISSUE | DATE | DESCRIPTION |
|-------|------|-------------|
| 1 | | |
| 2 | | |
| 3 | | |
| 4 | | |
| 5 | | |
| 6 | | |
| 7 | | |
| 8 | | |

SCALE
1/4" = 1'-0"
DATE
06.30.2022
DRAWN BY
RT, CL
REVIEWED BY
JW

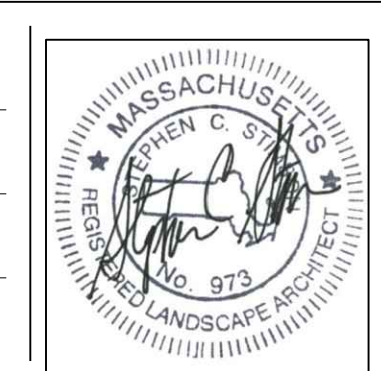

**CROSSING 3
PLAN & SECTION**
CONSTRUCTION DOCUMENT | **L2.0**

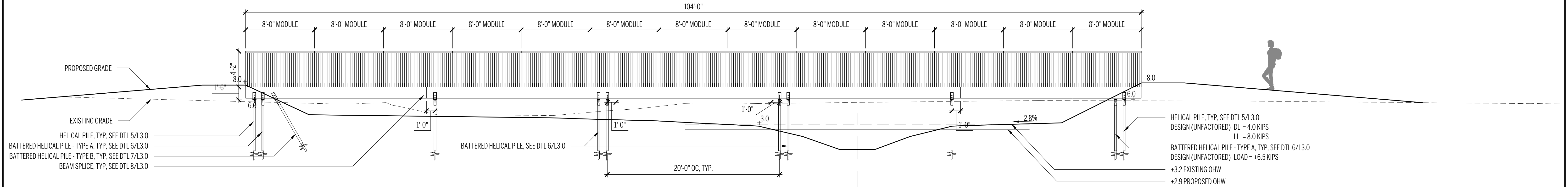

2 CROSSING SECTION FACING UPSTREAM
3/16" = 1'-0"

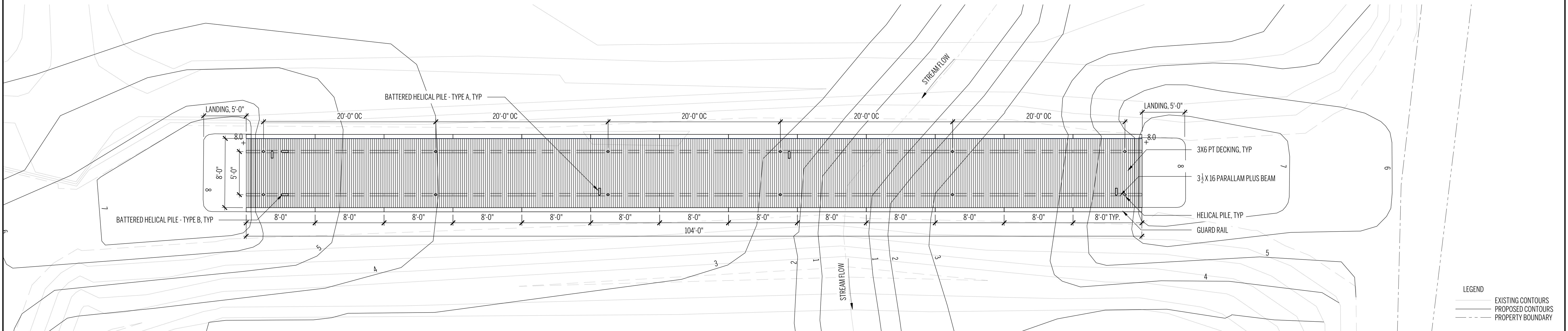

1 CROSSING 1 PLAN
3/16" = 1'-0"

LEGEND
 ——— EXISTING CONTOURS
 - - - - - PROPOSED CONTOURS
 - - - - - PROPERTY BOUNDARY

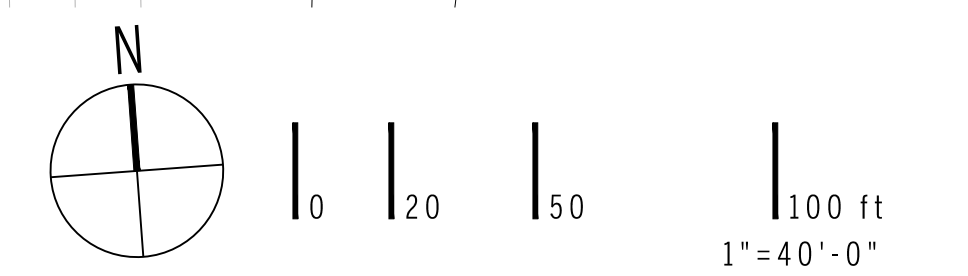

LANDSCAPE ARCHITECT
STIMSON
 STEPHEN STIMSON ASSOCIATES LANDSCAPE ARCHITECTS, INC.
 288 NORFOLK STREET CAMBRIDGE, MA 02139 T 617 876 8960
 71 GATES ROAD PRINCETON, MA 01541 T 978 464 5200
 STIMSONSTUDIO.COM

STRUCTURAL ENGINEER
RSE ASSOCIATES, INC.
 63 PLEASANT STREET SUITE 200 WATERTOWN, MA 02472 T 617 926 9300

ENVIRONMENTAL ENGINEER
INTER-FLUVE
 220 CONCORD AVENUE, 2ND FLOOR CAMBRIDGE, MA 02138 T 617 714 5537

**COLD BROOK
 ECO-RESTORATION PROJECT**
 HCT
 0 BANK ST
 HARWICH PORT, MA 02646

| ISSUE | DATE | DESCRIPTION |
|-------|------|-------------|
| 1 | | |
| 2 | | |
| 3 | | |
| 4 | | |
| 5 | | |
| 6 | | |
| 7 | | |
| 8 | | |

SCALE
3/16" = 1'-0"
DATE
06.30.2022
DRAWN BY
RT, CL
REVIEWED BY
JW

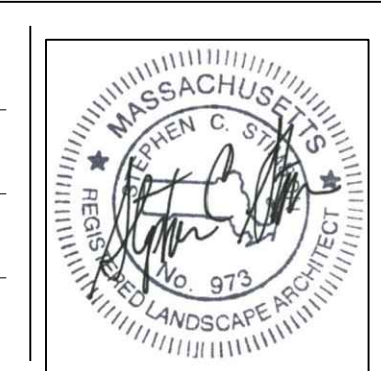

**BOARDWALK
 PLAN & SECTION**
**CONSTRUCTION
 DOCUMENT** | **L2.0**

STRUCTURAL NOTES

General

All structural work to be carried out in accordance with the Massachusetts Building Code.

Foundation

1. Provide minimum 4'-0" frost cover for headwall footings.
2. Allowable soil bearing pressure assumed to be 2,000 psf for headwall footings. This is to be confirmed by a geotechnical engineer prior to pouring footings.
3. See Drawings for unfactored pile design loads. Pile design to be carried out by a Geotechnical engineer licensed in Massachusetts. Submit pile design for approval.

Structural Steel

1. Structural steel tube columns to be ASTM A500 Grade B. Structural steel pipe columns to be ASTM A53 Type S Grade B. Steel beams to be ASTM A992 Grade 50. Steel plates to be ASTM A36.
2. Steel connection bolts to be ASTM A325. Anchor bolts to be ASTM A307.
3. Steel connections to be 3/16" continuous fillet weld unless otherwise noted on plan.
4. Bolt holes in steel to be 1/16" larger in diameter than the nominal size of bolts used.
5. All connection hardware to be hot dipped galvanized.

Wood Construction

1. Timber to be SPF No. 2 or better unless noted.
2. All exterior timber to be pressure treated.
3. Provide Simpson joist hangers where joists are supported by beams.
4. Unless otherwise noted, provide Simpson connectors at column/beam and beam/beam connections. Details to be in accordance with manufacturer instructions. Alternatively, provide bolted connections using 1/4" thick steel angles with min. 4" edge distance and spacing.
5. Provide 1/4" steel brackets to connect wood beams to steel channels.
6. Provide Simpson Hurricane Ties at joist/beam connections.
7. Where pockets in concrete piers/walls are provided for bearing of wood beams, provide Simpson cast in anchors.
8. Maximum nail or screw spacing to be 6" for deck fastening.
9. Maximum moisture content to be 19%.
10. All exterior bolts, nails and hardware to be hot dipped galvanized.

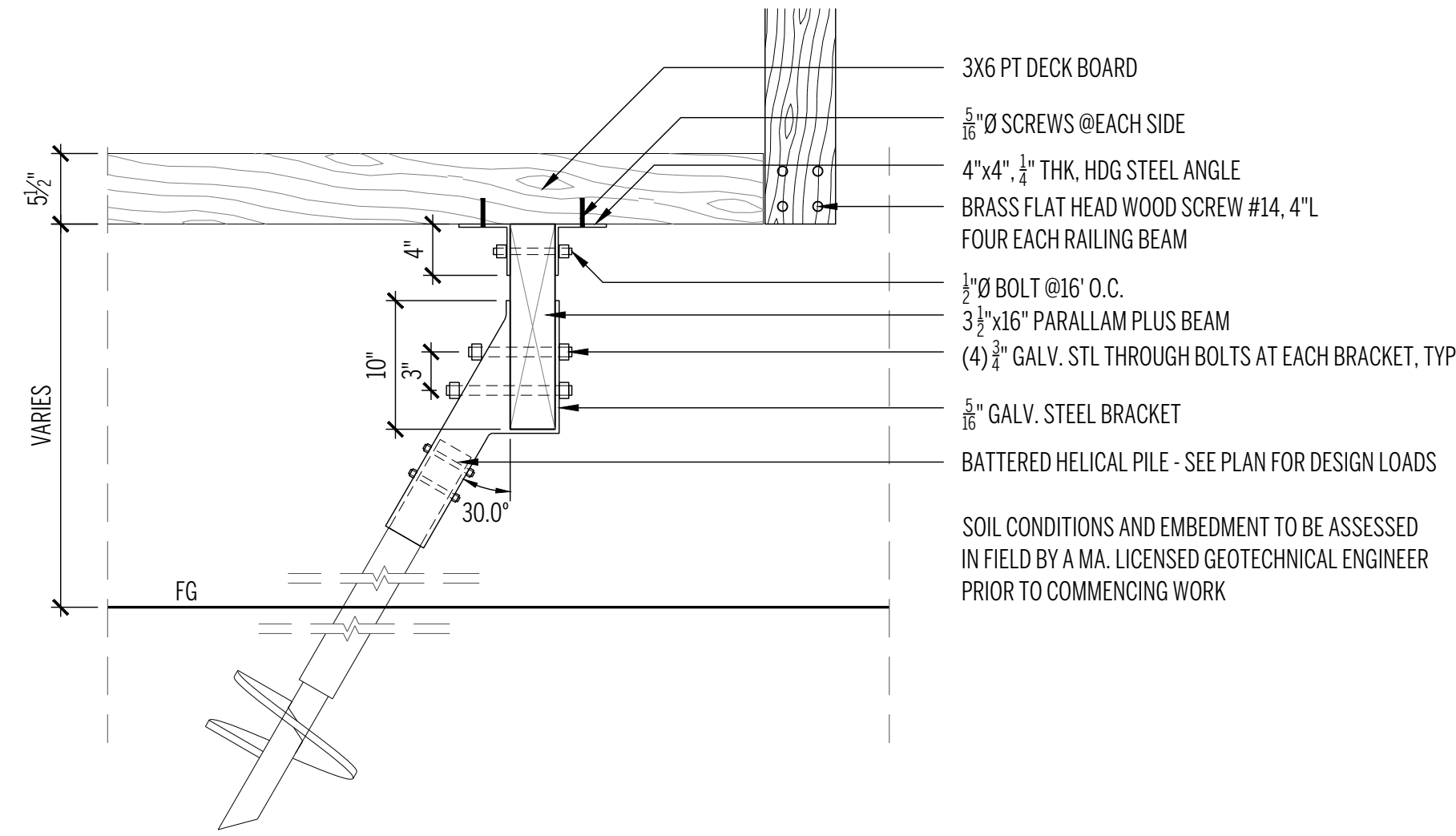

6 BATTERED HELICAL PILE - TYPE A
1" = 1'-0"

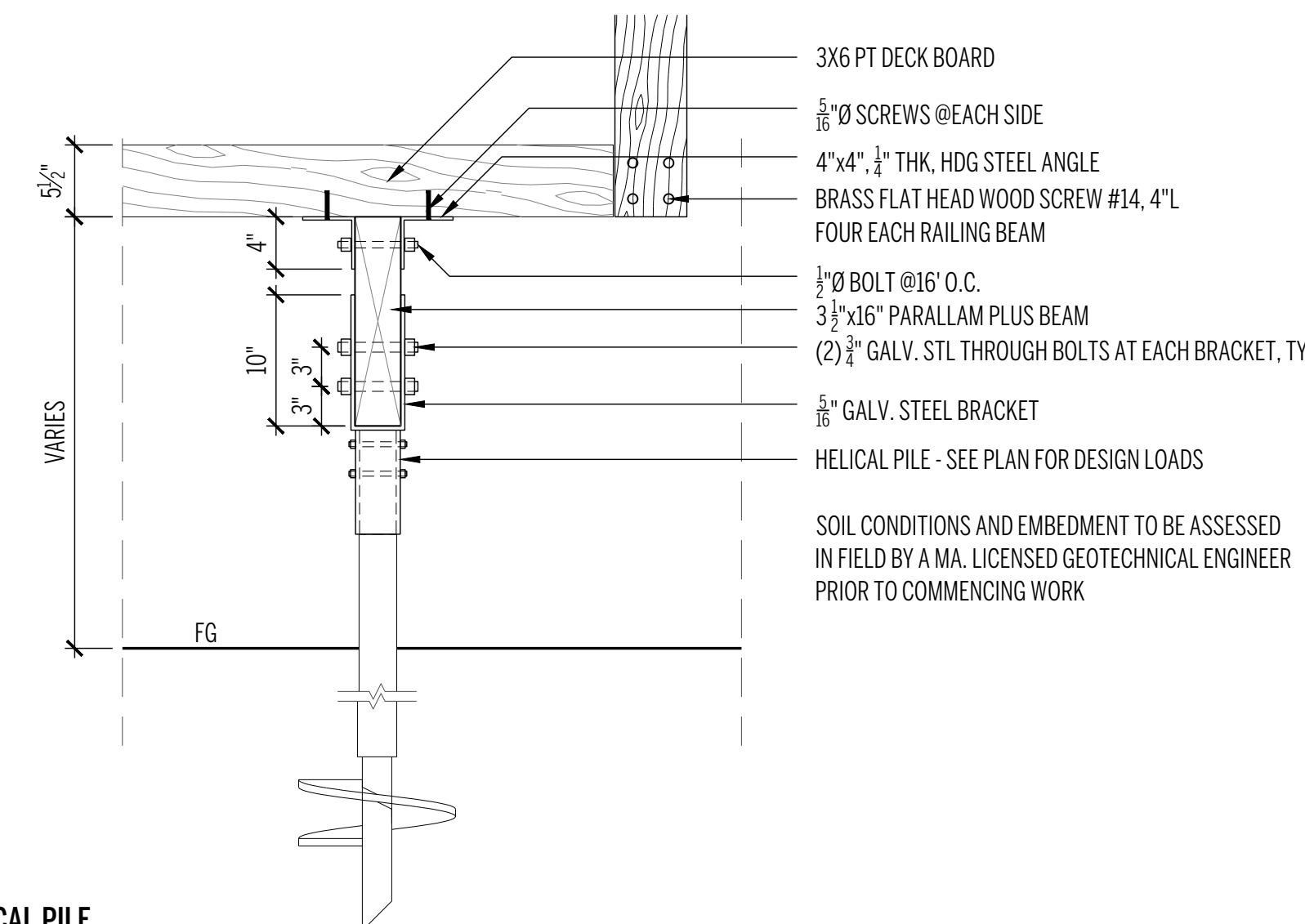

5 HELICAL PILE
1" = 1'-0"

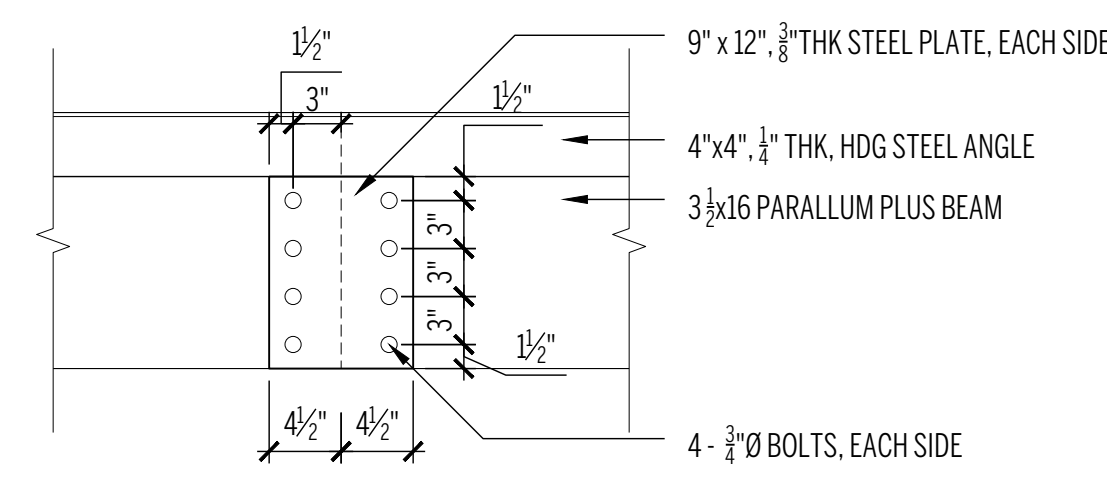

8 BEAM SPLICE
1" = 1'-0"

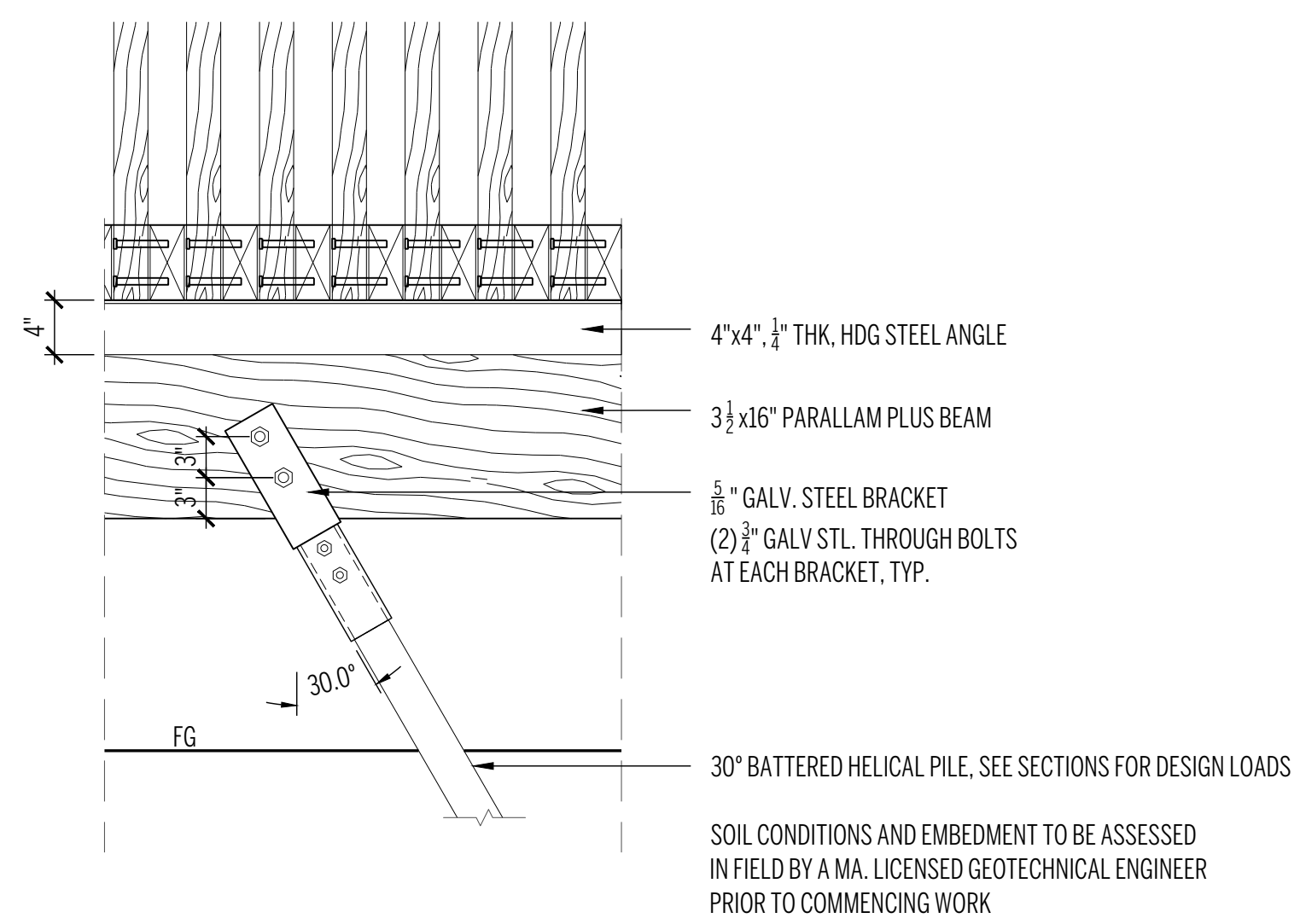

7 BATTERED HELICAL PILE - TYPE B
1" = 1'-0"

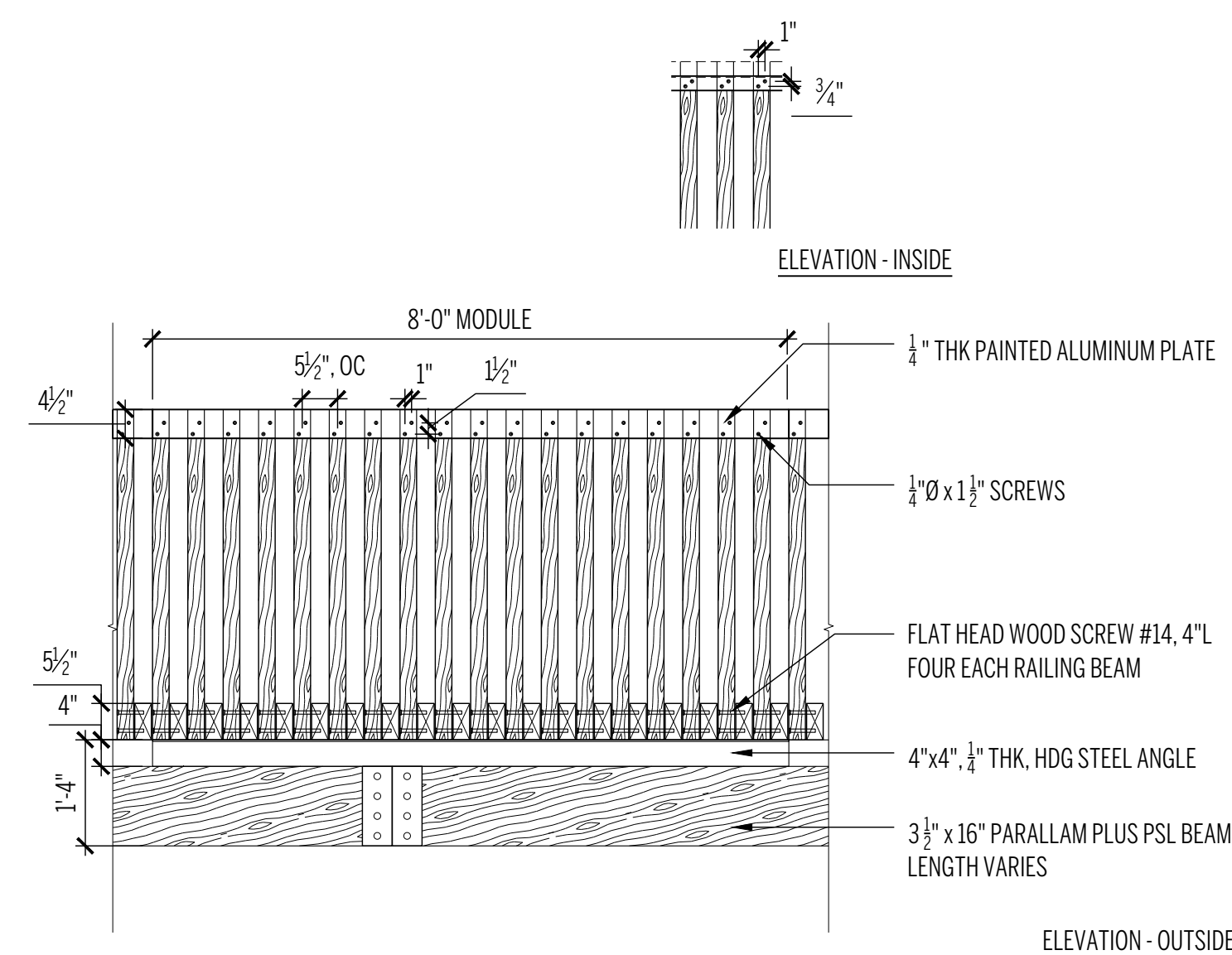

4 CROSSING MODULE ELEVATION
1/2" = 1'-0"

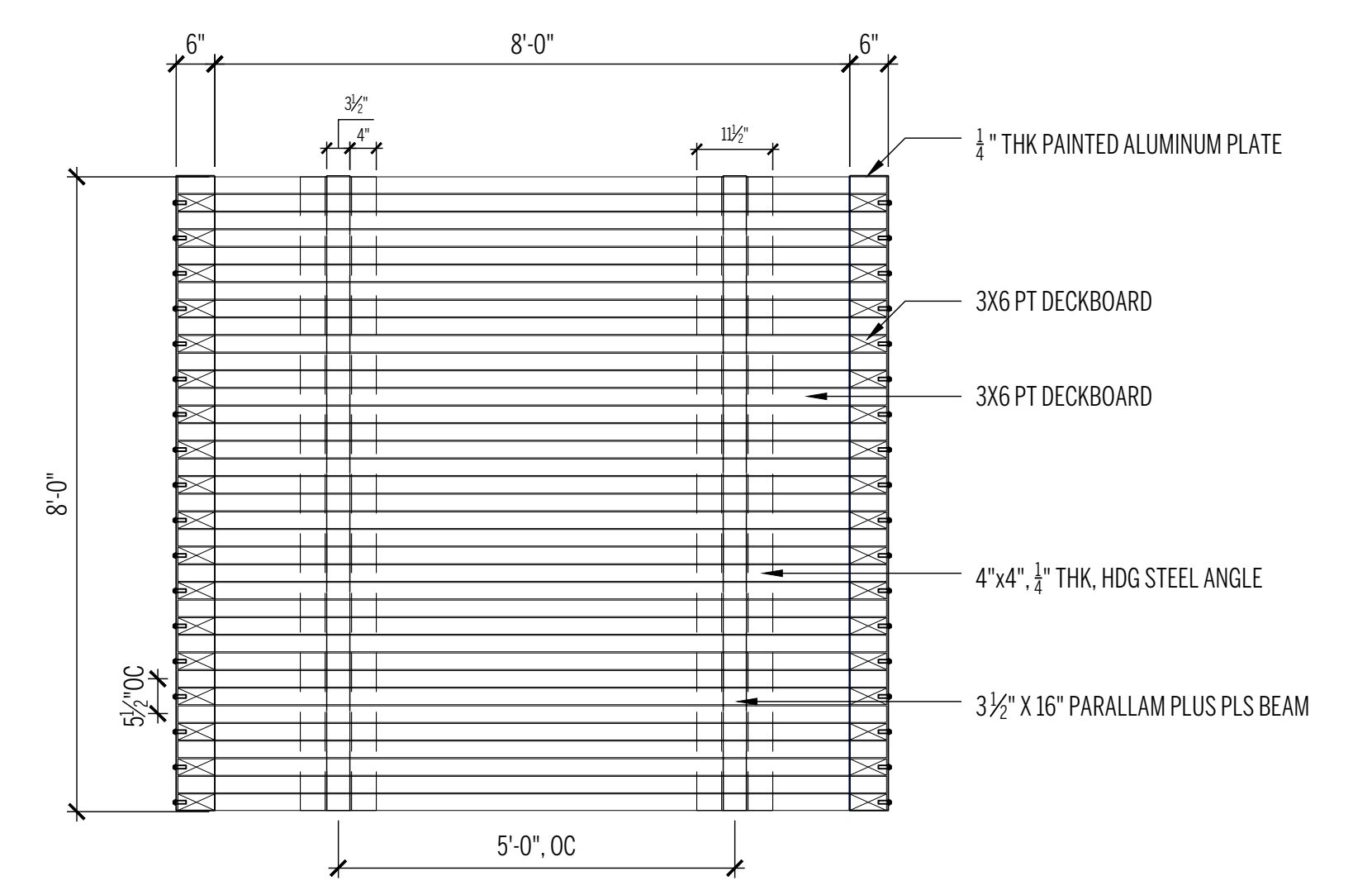

3 CROSSING MODULE PLAN
1/2" = 1'-0"

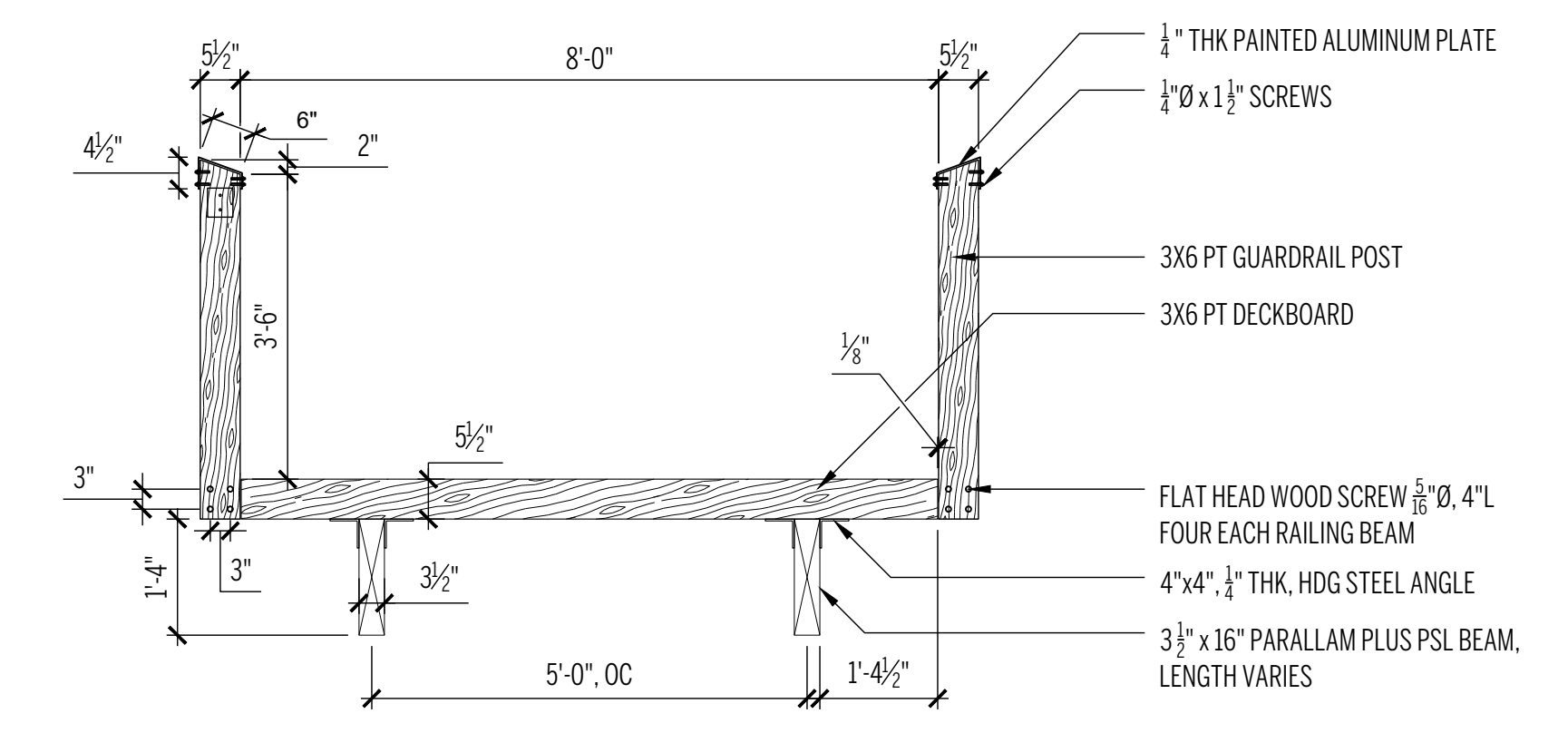

2 CROSSING MODULE SECTION
1/2" = 1'-0"

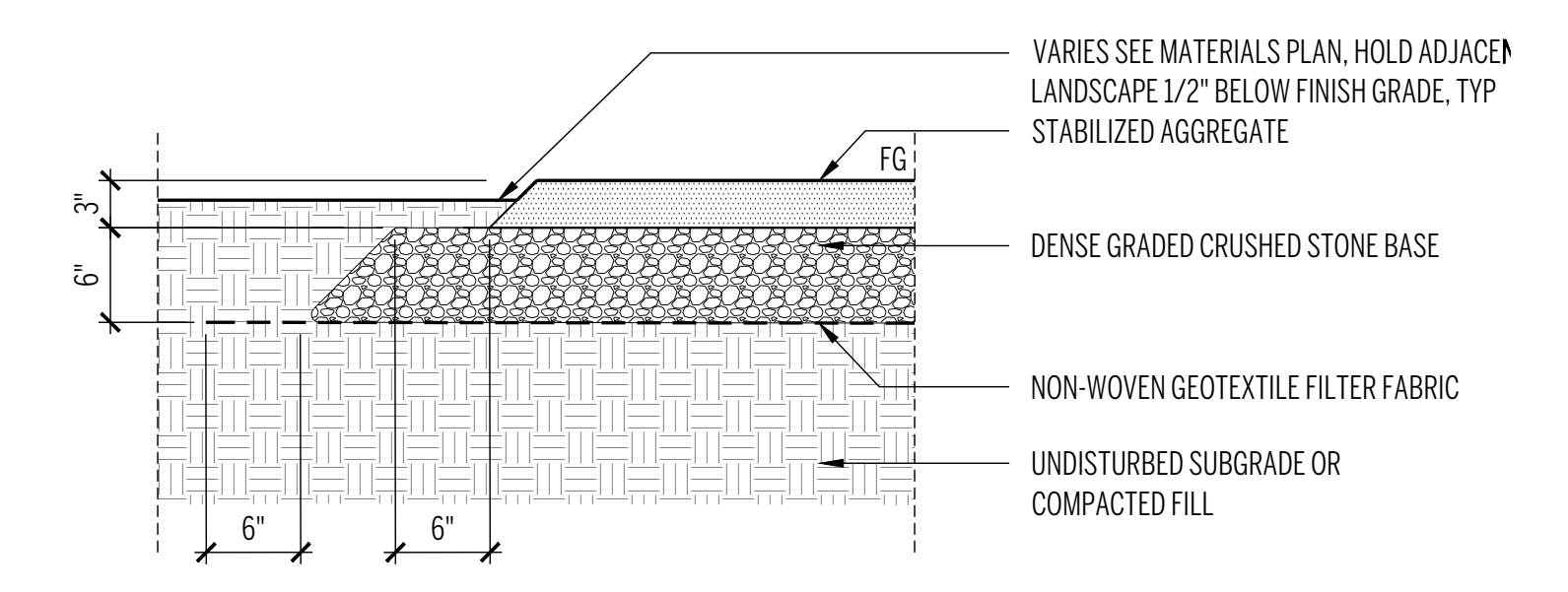

1 ADA PATH PAVING
1 1/2" = 1'-0"

LANDSCAPE ARCHITECT
STIMSON
STEPHEN STIMSON ASSOCIATES LANDSCAPE ARCHITECTS, INC.
288 NORFOLK STREET CAMBRIDGE, MA 02139
71 GATES ROAD PRINCETON, MA 01541
T 617 876 8960 T 978 464 5200
STIMSONSTUDIO.COM

STRUCTURAL ENGINEER
RSE ASSOCIATES, INC.
63 PLEASANT STREET SUITE 200 WATERTOWN, MA 02472
T 617 926 9300

ENVIRONMENTAL ENGINEER
INTER-FLUVE
220 CONCORD AVENUE, 2ND FLOOR CAMBRIDGE, MA 02138
T 617 714 5537

**COLD BROOK
ECO-RESTORATION PROJECT**
HCT
0 BANK ST
HARWICH PORT, MA 02646

| ISSUE | DATE | DESCRIPTION |
|-------|------|-------------|
| 1 | | |
| 2 | | |
| 3 | | |
| 4 | | |
| 5 | | |
| 6 | | |
| 7 | | |
| 8 | | |

SCALE AS NOTED
DATE 06.30.2022
DRAWN BY RT, CL
REVIEWED BY JW

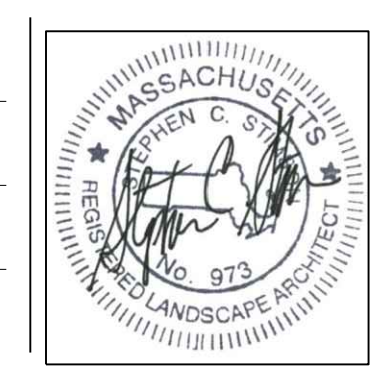

DETAILS
CONSTRUCTION DOCUMENT
L3.0

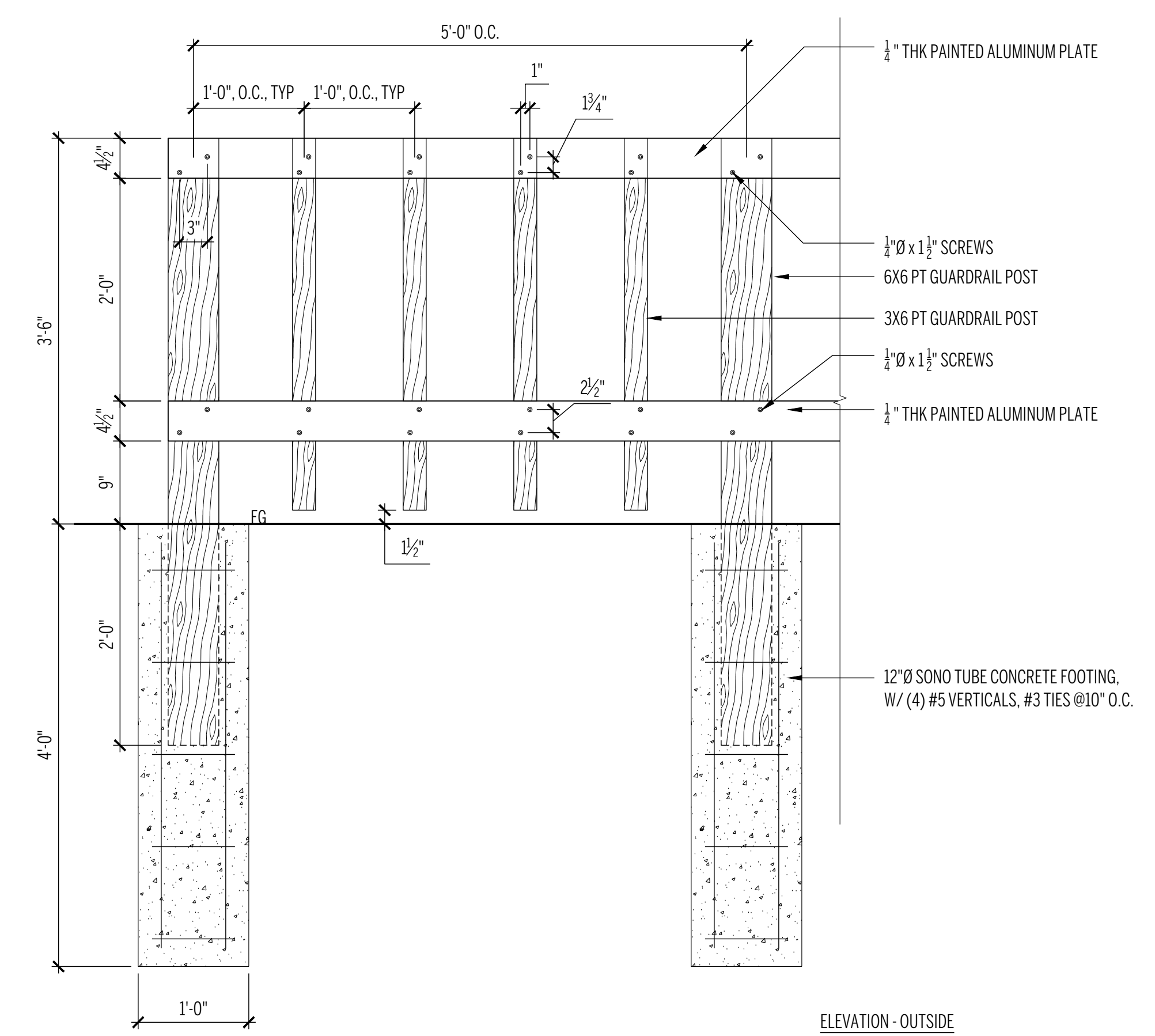
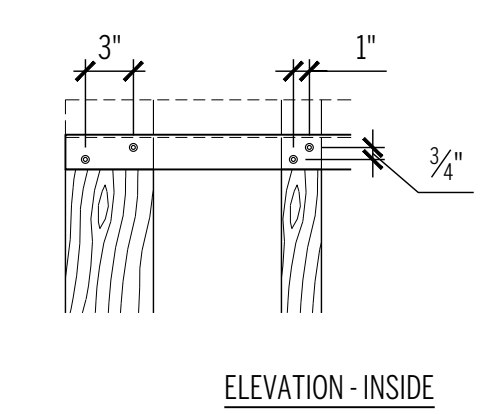
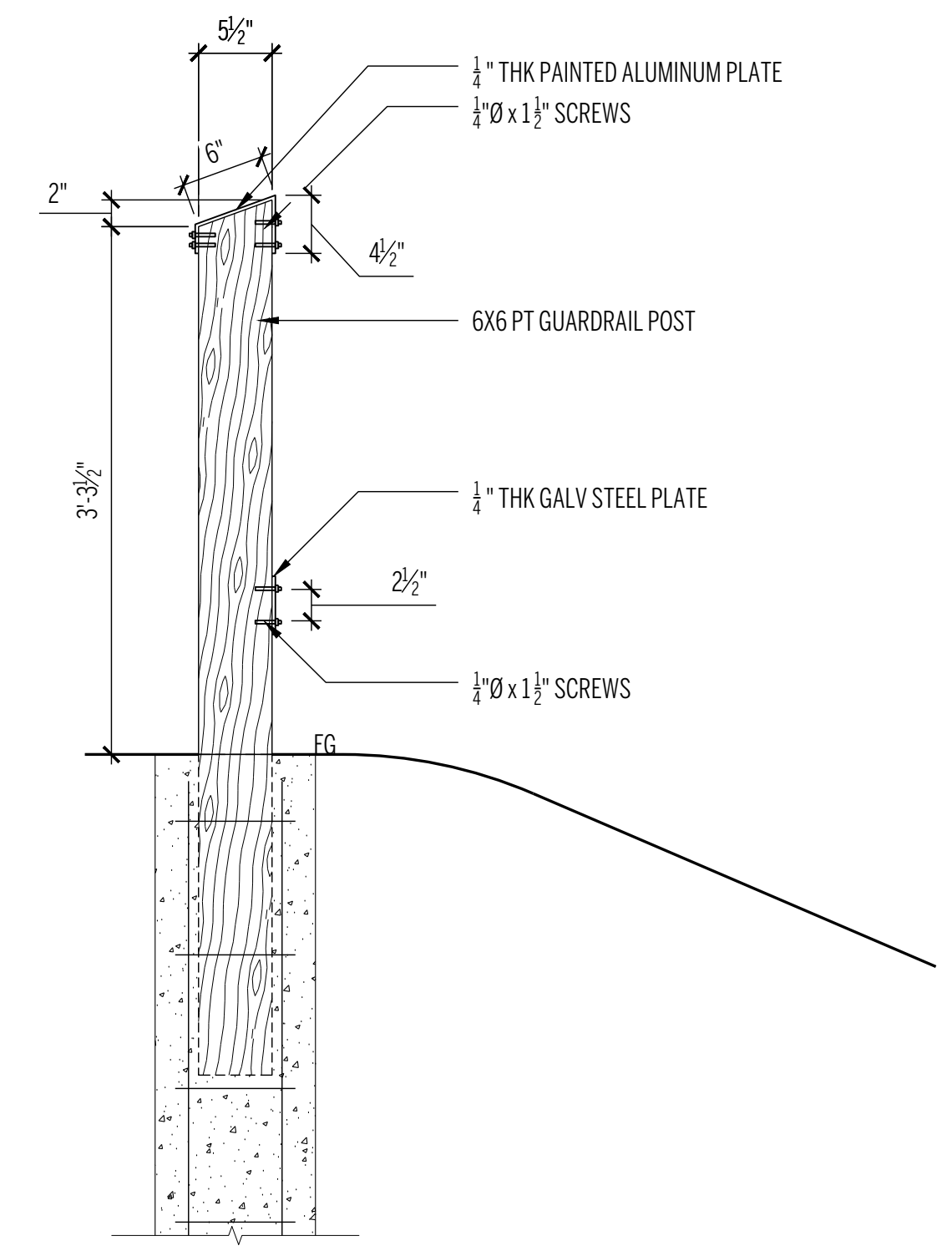

1 OVERLOOK GUARDRAIL
1"=1'-0"

LANDSCAPE ARCHITECT

STIMSON

STEPHEN STIMSON ASSOCIATES LANDSCAPE ARCHITECTS, INC.

288 NORFOLK STREET
CAMBRIDGE, MA 02139
T 617 876 8960

71 GATES ROAD
PRINCETON, MA 01541
SUITE 200
T 978 464 5200
STIMSONSTUDIO.COM

STRUCTURAL ENGINEER

RSE ASSOCIATES, INC.

63 PLEASANT STREET
SUITE 200
WATERTOWN, MA 02472
T 617 926 9300

ENVIRONMENTAL ENGINEER

INTER-FLUVE

220 CONCORD AVENUE, 2ND FLOOR
CAMBRIDGE, MA 02138
T 617 714 5537

**COLD BROOK
ECO-RESTORATION PROJECT**

HCT
0 BANK ST
HARWICH PORT, MA 02646

| ISSUE | DATE | DESCRIPTION |
|-------|------|-------------|
| 1 | | |
| 2 | | |
| 3 | | |
| 4 | | |
| 5 | | |
| 6 | | |
| 7 | | |
| 8 | | |

SCALE
AS NOTED
DATE
06.30.2022
DRAWN BY
RT, CL
REVIEWED BY
JW

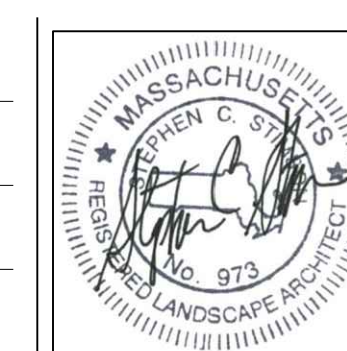

DETAILS

CONSTRUCTION
DOCUMENT

L3.1