



TOWN OF HARWICH  
ASSESSORS OFFICE  
732 MAIN STREET  
HARWICH, MASSACHUSETTS 02645

TOWN OF HARWICH  
JUN 21 2023  
ASSESSORS OFFICE

OFFICE OF  
BOARD OF ASSESSORS  
Tel: 508-430-7503  
Fax: 508-430-7086

**ABUTTERS REQUEST FORM**

Board Requesting Action: PLANNING BOARD

Date Submitted: 21 JUN 2023

Applicant's Name: TODD LABARGE

Assessors Map(s) & Parcel(s): 12-N1-1

Property Location: 237 RT 28 WEST HARWICH, MA 02671

Owner(s): TODD & LORI LABARGE

Contact Person: CASEY FURNAS

E-mail Address: CASEY@LABARGEHOMES.COM

Telephone #: 508-432-6360

Type of Petition: SITE PLAN REVIEW

Assessors Approval By: *M. Sullivan* 6/21/23

**INVOICE**

*This cover sheet is also your invoice.*

	<u>Amount</u>	<u>Date Paid</u>	<u>Ck #</u>
Up to 25 Abutters	\$50.00	6/21/23	26271
Additional Abutters _____ @ \$2.00 ea	_____	_____	_____
<b>TOTAL</b>	_____	_____	_____

Make checks payable to: Town of Harwich



TOWN OF HARWICH, MA  
 BOARD OF ASSESSORS  
 732 Main Street, Harwich, MA 02645

Abutters List Within 300 feet of Parcel 12/N1-1/0

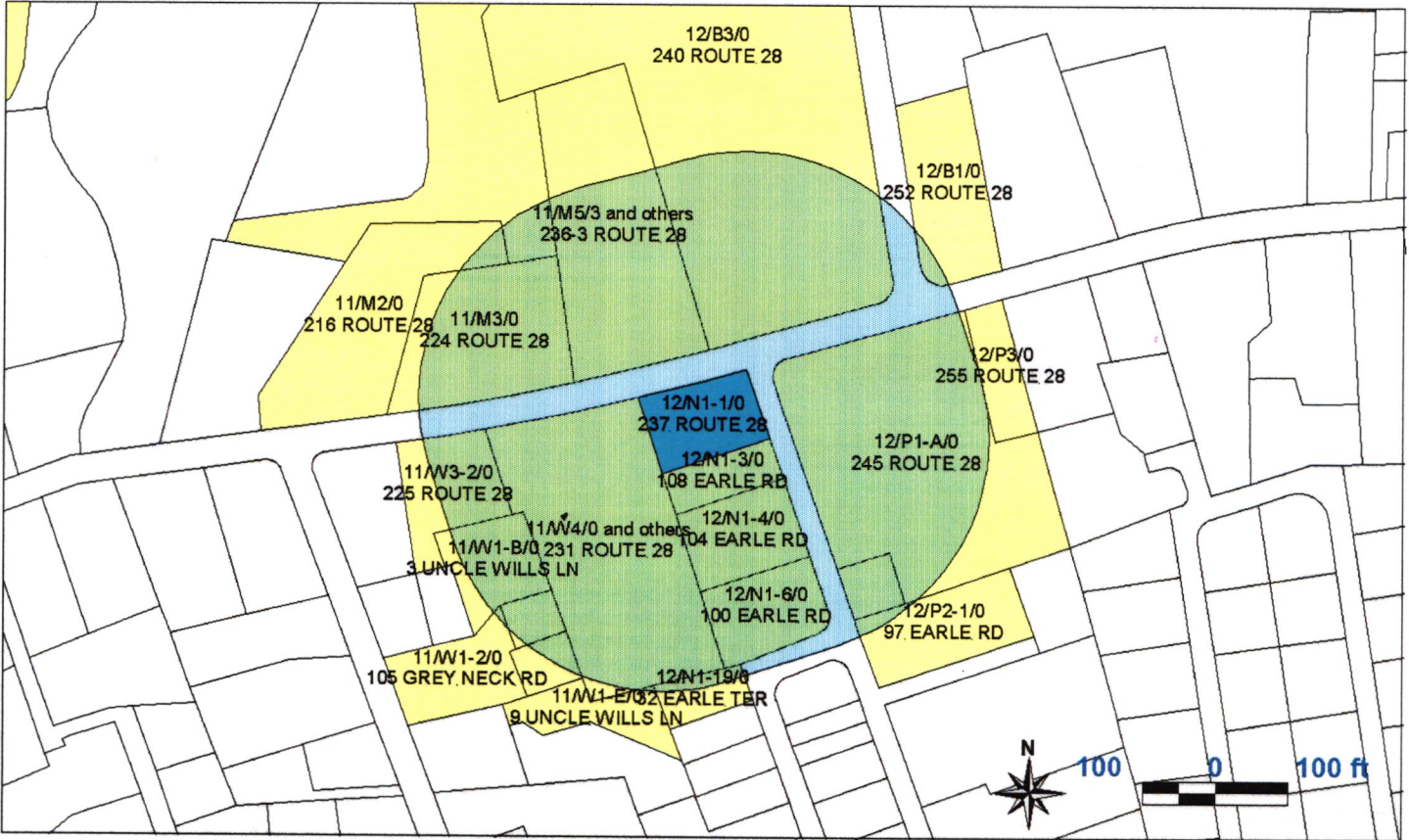

Key	Parcel ID	Owner	Location	Mailing Street	Mailing City	ST	ZipCd/Country
8217	11-M2-0-R	FOSTER FRANCIS X	216 ROUTE 28	PO BOX 2628	HYANNIS	MA	02601
1177	11-M3-0-R	LUKE ARTHUR J TR ARTSON NOMINEE TRUST	224 ROUTE 28	22 SPRINGER LN	W YARMOUTH	MA	02673
1210	11-M5-0-E	CAPTAIN JOHN WILLIAMS CONDO TR MARENGHI PAMELA J TRS	236 ROUTE 28	PO BOX 34	W HARWICH	MA	02671
23677	11-M5-1-R	SECOLA MARY LOUISE C/O AMZEEN EDWARD S &	236-1 ROUTE 28	236 ROUTE 28 UNIT 1	W HARWICH	MA	02671
23679	11-M5-2-R	KELLEY STARR & KELLEY JOSEPH L	236-2 ROUTE 28	236 ROUTE 28 UNIT 2	W HARWICH	MA	02671
23680	11-M5-3-R	COPITHORNE DEBORAH J TR DEBORAH J COPITHORNE NOMINEE T	236-3 ROUTE 28	642 MAIN ST	MEDFIELD	MA	02052
23681	11-M5-4-R	MATEEV MATEEV KRASIMIR	236-4 ROUTE 28	236 ROUTE 28 UNIT 4	W HARWICH	MA	02671
1302	11-W1-2-0-R	OCHS-PIASECKI TRS ET ALS OCHS JAMES JOSEPH, ROONEY DEBO	105 GREY NECK RD	16 PINNACLE DR	WALPOLE	MA	02032
1296	11-W1-B-0-R	MCFADDEN FEDERICK M & MCFADDEN STEPHANIE A	3 UNCLE WILLS LN	12 SPAFFORD RD	MILTON	MA	02168
1298	11-W1-C-0-R	GREY NECK PARTNERS LLC	5 UNCLE WILLS LN	5569 DESCARTES CIR	BOYNTON BEACH	FL	33472
1299	11-W1-D-0-R	MORRILL DANIEL F & MORRILL TIFFANY	7 UNCLE WILLS LN	1 MILLBROOK CIR	E LONGMEADOW	MA	01028
1300	11-W1-E-0-R	KENT JOHN D & KENT MAUREEN A	9 UNCLE WILLS LN	16 BARTLETT WAY UNIT #1	WALTHAM	MA	02452
16042	11-W3-2-0-R	UNCHAINED LLC	225 ROUTE 28	C/O ALLEN HARBOR MARINE SERVIC 335 LOWER COUNTY RD	HARWICH PORT	MA	02646
20020	11-W4-0-E	SEASCAPE VILLAGE CONDOMINIUM T C/O JAMES REDFIELD CHAIRMAN	231 ROUTE 28	231 ROUTE 28 UNIT 13	W HARWICH	MA	02671
8262	11-W4-1-R	KEHOE DONALD J	231-1-1 ROUTE 28	231 ROUTE 28 UNIT 1	W HARWICH	MA	02671

Key	Parcel ID	Owner	Location	Mailing Street	Mailing City	ST	ZipCd/Country
8342	11-W4-2-R	MORAES CLAUDSON S JR & MORAES JESSICA A	231-1-2 ROUTE 28	231 ROUTE 28 UNIT 2	W HARWICH	MA	02671
8263	11-W4-3-R	GOLDBERG YURY TRS ET AL GOLDBERG MUSA TRS	231-1-3 ROUTE 28	136 HIGHLAND AVE	WATERTOWN	MA	02472
8265	11-W4-4-R	MABB LORI V TR GAIL F MCKAY REVOCABLE TRUST	231-1-4 ROUTE 28	73 COTTAGE LN	WEYMOUTH	MA	02188
8266	11-W4-5-R	MCINNIS MICHAEL & MCINNIS DEBORAH	231-1-5 ROUTE 28	19 SAWIN DR	WESTMINSTER	MA	01473
8267	11-W4-6-R	HUMPHREY ELIZABETH A	231-1-6 ROUTE 28	231 ROUTE 28 UNIT 6	W HARWICH	MA	02671
8268	11-W4-7-R	QUICK ALISON A	231-1-7 ROUTE 28	231 ROUTE 28 UNIT 7	W HARWICH	MA	02671
8269	11-W4-8-R	BURKE SEAN	231-1-8 ROUTE 28	6 BISHOPS LN	HARWICH	MA	02645
8270	11-W4-9-R	SEELEY NICHOLAS C & SEELEY KATERI G	231-2-9 ROUTE 28	231 ROUTE 28 UNIT 9	W HARWICH	MA	02671
8271	11-W4-10-R	BENNETT DAVID M & BENNETT MARY-REGINA	231-2-10 ROUTE 28	5 DONNY DR	FRANKLIN	MA	02058
8272	11-W4-11-R	MORGAN JUDITH M C/O MORGAN JUDITH M TR	231-2-11 ROUTE 28	231 ROUTE 28 UNIT 11	W HARWICH	MA	02671
8273	11-W4-12-R	RYAN PETER W ET AL RYAN BRENDAN S	231-2-12 ROUTE 28	231 ROUTE 28 UNIT 12	W HARWICH	MA	02671
8274	11-W4-13-R	REDFIELD RONALD H	231-3-13 ROUTE 28	24020 TIMBERLAWN CT	LUTZ	FL	33549
8275	11-W4-14-R	KENDALL ELIZA J	231-3-14 ROUTE 28	90 OLD CHATHAM RD	HARWICH	MA	02645
8276	11-W4-15-R	CHO YONG K	231-3-15 ROUTE 28	96 BIRCH AVE	E LONGMEADOW	MA	01028
8306	11-W4-16-R	SEELEY GARY & SEELEY SANDRA	231-3-16 ROUTE 28	231 ROUTE 28 UNIT 3-16	W HARWICH	MA	02671
8277	11-W4-17-R	TANCO SANDRA	231-4-17 ROUTE 28	PO BOX 383	HARWICH PORT	MA	02646
8278	11-W4-18-R	CHAPLIC KYLE	231-4-18 ROUTE 28	231 ROUTE 28 UNIT 18	W HARWICH	MA	02671
8279	11-W4-19-R	MURPHY JOHN PAUL & MURPHY MARY ALICE	231-4-19 ROUTE 28	56 EXETER ST	QUINCY	MA	02170
8280	11-W4-20-R	WEST JOHN P & WEST LINDSAY A	231-4-20 ROUTE 28	231 ROUTE 28 UNIT 20	W HARWICH	MA	02671
8281	11-W4-21-R	OTTINO ANDREW W	231-5-21 ROUTE 28	231 ROUTE 28 UNIT 5-21	W HARWICH	MA	02671
8282	11-W4-22-R	HYDE DANIEL	231-5-22 ROUTE 28	8 RADCLIFFE RD	MASHPEE	MA	02649
8283	11-W4-23-R	ROUILLARD JONATHAN W & ROUILLARD LARA	231-5-23 ROUTE 28	231 ROUTE 28 UNIT 23	W HARWICH	MA	02671
8284	11-W4-24-R	KILCOYNE THOMAS J & KILCOYNE ANNE M	231-5-24 ROUTE 28	231 ROUTE 28 UNIT 24	W HARWICH	MA	02671
8285	11-W4-25-R	PECK MORGAN A	231-5-25 ROUTE 28	161 ROUTE 28 UNIT 6	W HARWICH	MA	02671
8286	11-W4-26-R	QUIGLEY ANGELA M TRS ET AL ERASMI TIMOTHY J TRS	231-5-26 ROUTE 28	1 BELMONT RD UNIT 29	W HARWICH	MA	02671
1379	12-B1-0-R	KALBACH LEONARD & KALBACH BARBARA	252 ROUTE 28	PO BOX 293	W HARWICH	MA	02671
10552	12-B3-0-E	ROMAN CATHOLIC BISHOP OF FALL MICHAEL K MCMANUS CHANCEL	240 ROUTE 28	450 HIGHLAND AVE	FALL RIVER	MA	02720-3701
1364	12-N1-1-0-R	LABARGE TODD & LABARGE LORI	237 ROUTE 28	237 ROUTE 28	W HARWICH	MA	02671
1395	12-N1-3-0-R	MCDOWELL GEORGE ANDREW JR & MCDOWELL BARBARA L	108 EARLE RD	81 RIVERFORD RD	BROOKFIELD	CT	06804
1396	12-N1-4-0-R	STALLINGS STEPHEN D & STALLINGS KATHLEEN	104 EARLE RD	104 EARLE RD	W HARWICH	MA	02671
1398	12-N1-6-0-R	HOOGASIAN JOHN & HOOGASIAN MARY D	100 EARLE RD	168 SOUTH SPENCER RD	SPENCER	MA	01562
1425	12-N1-19-0-R	KELLEY MARY T & KELLEY DAVID M	32 EARLE TER	49 GRAY BEECH LN	HANOVER	MA	02339
12756	12-P1-A-0-E	ROMAN CATHOLIC BISHOP OF FALL MICHAEL K MCMANUS CHANCEL	245 ROUTE 28	450 HIGHLAND AVE	FALL RIVER	MA	02720-3701
1443	12-P1-B-0-R	HAMM RICHARD JAMES & HAMM JULIE ANN	99 EARLE RD	3 PALOMINO DR	HOPKINTON	MA	01748
1444	12-P2-1-0-R	GRAVALLESE JOHN W & GRAVALLESE DEBORAH L	97 EARLE RD	107 NORTH ST	N READING	MA	01864
8295	12-P3-0-R	PETERSON THOMAS H REALTY INC	255 ROUTE 28	255 RT 28 PO BOX 324	W HARWICH	MA	02671

	11-M2-0-R		11-M3-0-R		11-M5-0-E
FOSTER FRANCIS X PO BOX 2628 HYANNIS, MA 02601		LUKE ARTHUR J TR ARTSON NOMINEE TRUST 22 SPRINGER LN W YARMOUTH, MA 02673		CAPTAIN JOHN WILLIAMS CONDO TR MARENGHI PAMELA J TRS PO BOX 34 W HARWICH, MA 02671	
	11-M5-1-R		11-M5-2-R		11-M5-3-R
SECOLA MARY LOUISE C/O AMZEEN EDWARD S & 236 ROUTE 28 UNIT 1 W HARWICH, MA 02671		KELLEY STARR & KELLEY JOSEPH L 236 ROUTE 28 UNIT 2 W HARWICH, MA 02671		COPITHORNE DEBORAH J TR DEBORAH J COPITHORNE NOMINEE T 642 MAIN ST MEDFIELD, MA 02052	
	11-M5-4-R		11-W1-2-0-R		11-W1-B-0-R
MATEEV MATEEV KRASIMIR 236 ROUTE 28 UNIT 4 W HARWICH, MA 02671		OCHS-PIASECKI TRS ET ALS OCHS JAMES JOSEPH, ROONEY DEBO 16 PINNACLE DR WALPOLE, MA 02032		MCFADDEN FEDERICK M & MCFADDEN STEPHANIE A 12 SPAFFORD RD MILTON, MA 02168	
	11-W1-C-0-R		11-W1-D-0-R		11-W1-E-0-R
GREY NECK PARTNERS LLC 5569 DESCARTES CIR BOYNTON BEACH, FL 33472		MORRILL DANIEL F & MORRILL TIFFANY 1 MILLBROOK CIR E LONGMEADOW, MA 01028		KENT JOHN D & KENT MAUREEN A 16 BARTLETT WAY UNIT #1 WALTHAM, MA 02452	
	11-W3-2-0-R		11-W4-0-E		11-W4-1-R
UNCHAINED LLC C/O ALLEN HARBOR MARINE SERVIC 335 LOWER COUNTY RD HARWICH PORT, MA 02646		SEASCAPE VILLAGE CONDOMINIUM T C/O JAMES REDFIELD CHAIRMAN 231 ROUTE 28 UNIT 13 W HARWICH, MA 02671		KEHOE DONALD J 231 ROUTE 28 UNIT 1 W HARWICH, MA 02671	
	11-W4-2-R		11-W4-3-R		11-W4-4-R
MORAES CLAUDSON S JR & MORAES JESSICA A 231 ROUTE 28 UNIT 2 W HARWICH, MA 02671		GOLDBERG YURY TRS ET AL GOLDBERG MUSA TRS 136 HIGHLAND AVE WATERTOWN, MA 02472		MABB LORI V TR GAIL F MCKAY REVOCABLE TRUST 73 COTTAGE LN WEYMOUTH, MA 02188	
	11-W4-5-R		11-W4-6-R		11-W4-7-R
MCINNIS MICHAEL & MCINNIS DEBORAH 19 SAWIN DR WESTMINSTER, MA 01473		HUMPHREY ELIZABETH A 231 ROUTE 28 UNIT 6 W HARWICH, MA 02671		QUICK ALISON A 231 ROUTE 28 UNIT 7 W HARWICH, MA 02671	
	11-W4-8-R		11-W4-9-R		11-W4-10-R
BURKE SEAN 6 BISHOPS LN HARWICH, MA 02645		SEELEY NICHOLAS C & SEELEY KATERI G 231 ROUTE 28 UNIT 9 W HARWICH, MA 02671		BENNETT DAVID M & BENNETT MARY-REGINA 5 DONNY DR FRANKLIN, MA 02058	
	11-W4-11-R		11-W4-12-R		11-W4-13-R
MORGAN JUDITH M C/O MORGAN JUDITH M TR 231 ROUTE 28 UNIT 11 W HARWICH, MA 02671		RYAN PETER W ET AL RYAN BRENDAN S 231 ROUTE 28 UNIT 12 W HARWICH, MA 02671		REDFIELD RONALD H 24020 TIMBERLAWN CT LUTZ, FL 33549	
	11-W4-14-R		11-W4-15-R		11-W4-16-R
KENDALL ELIZA J 90 OLD CHATHAM RD HARWICH, MA 02645		CHO YONG K 96 BIRCH AVE E LONGMEADOW, MA 01028		SEELEY GARY & SEELEY SANDRA 231 ROUTE 28 UNIT 3-16 W HARWICH, MA 02671	

11-W4-17-R	TANCO SANDRA PO BOX 383 HARWICH PORT, MA 02646	11-W4-18-R	MURPHY JOHN PAUL & MURPHY MARY ALICE 56 EXETER ST QUINCY, MA 02170	11-W4-19-R
11-W4-20-R	WEST JOHN P & WEST LINDSAY A 231 ROUTE 28 UNIT 20 W HARWICH, MA 02671	11-W4-21-R	HYDE DANIEL 8 RADCLIFFE RD MASHPEE, MA 02649	11-W4-22-R
11-W4-23-R	ROUILLARD JONATHAN W & ROUILLARD LARA 231 ROUTE 28 UNIT 23 W HARWICH, MA 02671	11-W4-24-R	PECK MORGAN A 161 ROUTE 28 UNIT 6 W HARWICH, MA 02671	11-W4-25-R
11-W4-26-R	QUIGLEY ANGELA M TRS ET AL ERASMI TIMOTHY J TRS 1 BELMONT RD UNIT 29 W HARWICH, MA 02671	12-B1-0-R	ROMAN CATHOLIC BISHOP OF FALL MICHAEL K MCMANUS CHANCEL 450 HIGHLAND AVE FALL RIVER, MA 02720-3701	12-B3-0-E
12-N1-1-0-R	LABARGE TODD & LABARGE LORI 237 ROUTE 28 W HARWICH, MA 02671	12-N1-3-0-R	STALLINGS STEPHEN D & STALLINGS KATHLEEN 104 EARLE RD W HARWICH, MA 02671	12-N1-4-0-R
12-N1-6-0-R	HOOGASIAN JOHN & HOOGASIAN MARY D 168 SOUTH SPENCER RD SPENCER, MA 01562	12-N1-19-0-R	ROMAN CATHOLIC BISHOP OF FALL MICHAEL K MCMANUS CHANCEL 450 HIGHLAND AVE FALL RIVER, MA 02720-3701	12-P1-A-0-E
12-P1-B-0-R	HAMM RICHARD JAMES & HAMM JULIE ANN 3 PALOMINO DR HOPKINTON, MA 01748	12-P2-1-0-R	PETERSON THOMAS H REALTY INC 255 RT 28 PO BOX 324 W HARWICH, MA 02671	12-P3-0-R
	CHAPLIC KYLE 231 ROUTE 28 UNIT 18 W HARWICH, MA 02671			
	OTTINO ANDREW W 231 ROUTE 28 UNIT 5-21 W HARWICH, MA 02671			
	KILCOYNE THOMAS J & KILCOYNE ANNE M 231 ROUTE 28 UNIT 24 W HARWICH, MA 02671			
	KALBACH LEONARD & KALBACH BARBARA PO BOX 293 W HARWICH, MA 02671			
	MCDOWELL GEORGE ANDREW JR & MCDOWELL BARBARA L 81 RIVERFORD RD BROOKFIELD, CT 06804			
	KELLEY MARY T & KELLEY DAVID M 49 GRAY BEECH LN HANOVER, MA 02339			
	GRAVALLESE JOHN W & GRAVALLESE DEBORAH L 107 NORTH ST N READING, MA 01864			