



TOWN OF HARWICH
 ASSESSORS OFFICE
 732 MAIN STREET
 HARWICH, MASSACHUSETTS 02645

**** Please email all Abutters Requests to assessing@town.harwich.ma.us**

OFFICE OF
 BOARD OF ASSESSORS
 Tel: 508-430-7503
 Fax: 508-430-7086

ABUTTERS REQUEST FORM

Board Requesting Action: *Planning*
 Date Submitted: *4/4/23*
 Applicant's Name: *Jennifer Ramler / Cape Sea Gullie*
 Assessors Map(s) & Parcel(s): *14*
 Property Location: *31 Sea St. Harwich Port*
 Owner(s): *Jennifer + Douglas Ramler*
 Contact Person: *Jennifer Ramler*
 E-mail Address: *capeseagullie@aol.com*
 Telephone #: *774-209-9148*
 Type of Petition: *Special Permit / waiver of Site Plan Review*
 Assessors Approval By: *[Signature]* *4/4/23*

TOWN OF HARWICH
 APR 04 2023
 ASSESSORS OFFICE

I hereby certify that the names and addresses on the attached or preceding sheet (s) are of the owners as they appear in the assessing departments most recent computerized tax list

INVOICE

This cover sheet is also your invoice.

		Date Paid	Ck #
Abutters Fee	\$50.00	<i>4/4/23</i>	<i>4702</i>

Make checks payable to: Town of Harwich



TOWN OF HARWICH, MA
 BOARD OF ASSESSORS
 732 Main Street, Harwich, MA 02645

Abutters List Within 300 feet of Parcel 14/V2/0

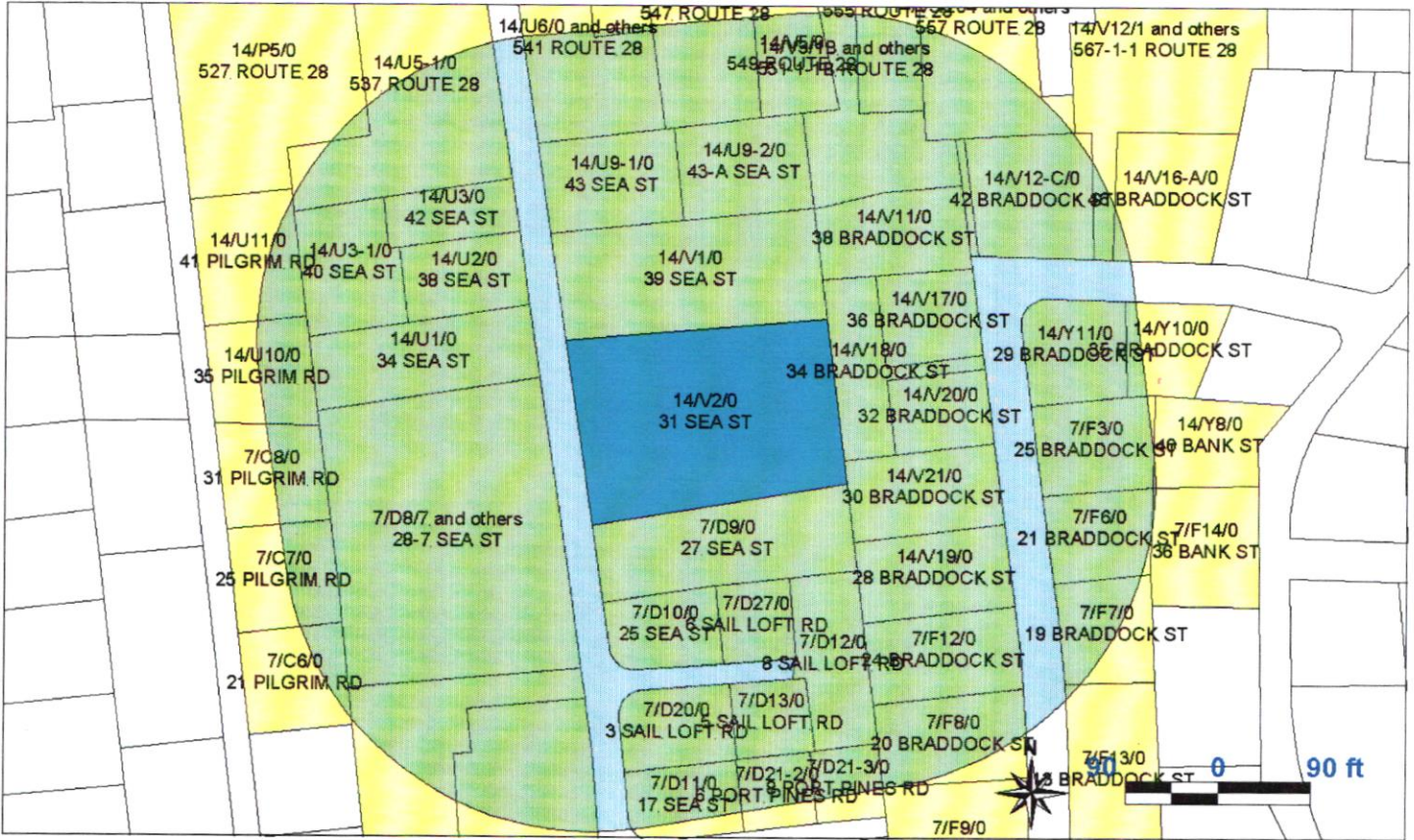

Key	Parcel ID	Owner	Location	Mailing Street	Mailing City	ST	ZipCd/Country
1098	7-C6-0-R	BEATTY THOMAS P & BEATTY ANNE M	21 PILGRIM RD	27 BONAD RD	W ROXBURY	MA	02131
1100	7-C7-0-R	WARD JEFFREY T & WARD MICHELLE THOMAS	25 PILGRIM RD	50 TEMPLE RD	WELLESLEY	MA	02482
1103	7-C8-0-R	ROBERGE GEORGE & DEBRA ET AL MCWHINNIE ELIZABETH A	31 PILGRIM RD	7246 CHAPPARAL CIR E	CENTENNIAL	CO	80016
25754	7-D6-8-0-R	CAMPBELL MARTHA M	18 SEA ST	57 KINGSWOOD RD	AUBURNDALE	MA	02466
25755	7-D6-9-0-R	CAMPBELL MICHAEL C	20 SEA ST	4 WARE RD	AUBURNDALE	MA	02466
24911	7-D8-0-E	SEA HEATHER CONDOMINIUM SEA HEATHER CONDOMINIUM TRUST	28 SEA ST	C/O DENNIS E MILLER 15 COPELAND DR	BEDFORD	MA	01730
24912	7-D8-1-R	MILLER DENNIS E TRS ET AL MILLER CHRISTINE A TRS	28-1 SEA ST	300 PIER 4 BLVD UNIT 31	BOSTON	MA	02210
24913	7-D8-2-R	MILLER DENNIS E TRS ET AL MILLER CHRISTINE A TRS	28-2 SEA ST	300 PIER 4 BLVD UNIT 31	BOSTON	MA	02210
24914	7-D8-3-R	FERRIE GAY TR GAY FERRIE 2016 REVOCABLE TRUS	28-3 SEA ST	33 FOREST ST 413	LEXINGTON	MA	02421
24915	7-D8-4-R	TRAVAGLINI BRENDA B TR BRENDA B TRAVAGLINI REVOCABLE	28-4 SEA ST	18 HARRISON ST	WINCHESTER	MA	01890
24916	7-D8-5-R	TRUDEL CLAUDIA V	28-5 SEA ST	28 OYSTER LANDING RD	HILTON HEAD	SC	29928
24917	7-D8-6-R	AZNOIAN GRACE	28-6 SEA ST	62 WILD ROSE DR	ANDOVER	MA	01810
24918	7-D8-7-R	BOWMAN JOHN S & BOWMAN MARGARET J	28-7 SEA ST	12 CRESTVIEW RD	BEDFORD	MA	01730
1758	7-D9-0-R	MALONE PETER C & MALONE MARSHA	27 SEA ST	27 SEA ST	HARWICH PORT	MA	02646
1761	7-D10-0-R	MILLER-PUCKETT MARY JANE TR MARY JANE MILLER-PUCKETT REV T	25 SEA ST	PO BOX 803	E ORLEANS	MA	02643

Key	Parcel ID	Owner	Location	Mailing Street	Mailing City	ST	ZipCd/Country
1765	7-D11-0-R	WHEELER CHARLES E TRS ET AL WHEELER SANDRA F TRS	17 SEA ST	48 BROOK RD	WESTON	MA	02493
1767	7-D12-0-R	MCCARTHY KEVIN C & MCCARTHY MARY ANN Y	8 SAIL LOFT RD	26 HIGHLAND CIR	NEEDHAM	MA	02494
8148	7-D13-0-R	RIELLY JUDITH FALLON TR JUDITH FALLON RIELLY 1999 FAMI	5 SAIL LOFT RD	5 SAIL LOFT RD	HARWICH PORT	MA	02646
1778	7-D20-0-R	RAVENELLE EDITH S	3 SAIL LOFT RD	254 HORSE POND RD	SUDBURY	MA	01776
1781	7-D21-2-0-R	DOLAN SEAN J & DOLAN LINDA M	6 PORT PINES RD	PO BOX 633	HARWICH PORT	MA	02646
1785	7-D21-3-0-R	SHORTEN SUSAN C & SHORTEN GREG	8 PORT PINES RD	1016 VENETIAN CT	CARY	NC	27518-7103
1798	7-D27-0-R	RATTO FRANCES M ET AL TR SAIL LOFT ROAD NOMINEE TRUST	6 SAIL LOFT RD	5 RICHARDSON DR	NEEDHAM	MA	02492-2817
1806	7-F3-0-R	GLEDHILL BRUCE C TR 25 BRADDOCK LANE REALTY TRUST	25 BRADDOCK ST	235 NIGHT CAP LANE	SALEM	SC	29676
1816	7-F6-0-R	BENZING PADI T	21 BRADDOCK ST	21 BRADDOCK ST	HARWICH PORT	MA	02646
1818	7-F7-0-R	MERRILL ANDREW & ERICA ET ALS THURMAN KARIN B TR	19 BRADDOCK ST	6 RINGWOOD RD	NORWALK	CT	06853
1822	7-F8-0-R	CMB REALTY CROUP LLC	20 BRADDOCK ST	83 LAZELL ST	HINGHAM	MA	02043
1826	7-F9-0-R	16 BRADDOCK STREET LLC	16 BRADDOCK ST	16 BRADDOCK ST	HARWICH PORT	MA	02646
1832	7-F12-0-R	DONNELLY CHARLES F TRS ET AL DONNELLY LAURA J TRS	24 BRADDOCK ST	24 BRADDOCK ST	HARWICH PORT	MA	02646
1834	7-F13-0-R	MICHAUD MARC J TRS ET AL MICHAUC ALLISON TRS	13 BRADDOCK ST	11 CHERRY LN	BEDFORD	NH	03110
1836	7-F14-0-R	ESTEN CLAIRE M, JASON ET ALS DEVENS KATHERINE, CHARLES III	36 BANK ST	5 KILLAM FARM LN	SOUTHBORO	MA	01772
10558	14-P5-0-E	PILGRIM CONGREGATION	527 ROUTE 28	527 MAIN ST	HARWICH PORT	MA	02646
2039	14-U1-0-R	WARD CHRISTPHER A TR ET AL WARD WHITNEY A TRS	34 SEA ST	50 PLEASANT ST	HINGHAM	MA	02043
2041	14-U2-0-R	SKINNER NANCY R TR NANCY R SKINNER REALTY TRUST	38 SEA ST	39 BURNHAM RD	BOLTON	MA	01740
2062	14-U3-0-R	MIDDLETON MARGARET E ET AL GANLEY MARY ELIZABETH	42 SEA ST	5613 SOUTHWICK ST	BETHESDA	MD	20817
2063	14-U3-1-0-R	KANE ELLEN E C/O KANE ELLEN E TRS ET AL	40 SEA ST	15 GLEN RD	WELLESLEY	MA	02481
8506	14-U5-1-0-R	YORK LO TR ROUTE 28 NOMINEE REALTY TRUST	537 ROUTE 28	346 ADAMS ST	QUINCY	MA	02169
2046	14-U6-0-E	541-543 MAIN STREET CONDOMINIUMS TRUST	541 ROUTE 28	C/O BRAX INC 51 OAK ST	HARWICH	MA	02645
23986	14-U6-A-1-R	541 MAIN STREET LLC	541-1 ROUTE 28	541 ROUTE 28 UNIT 1	HARWICH PORT	MA	02646
23987	14-U6-A-2-R	541 MAIN STREET LLC	541-2 ROUTE 28	541 ROUTE 28 UNIT 2	HARWICH PORT	MA	02646
23988	14-U6-B-3-R	541 MAIN STREET LLC	541-3 ROUTE 28	541 ROUTE 28 UNIT 3	HARWICH PORT	MA	02646
23989	14-U6-B-4-R	541 MAIN STREET LLC	541-4 ROUTE 28	541 ROUTE 28 UNIT 4	HARWICH PORT	MA	02646
2048	14-U8-0-R	CHASING SILVER LLC	545 ROUTE 28	15345 SW 88TH AVE	PALMETTO BAY	FL	33157
24727	14-U9-1-0-R	Vranos William & Vranos Kathleen	43 SEA ST	PO BOX 629 30 GAFFIELD AVE	MONUMENT BEACH	MA	02553
24728	14-U9-2-0-R	SHARRY MAURA J	43-A SEA ST	43-A SEA ST	HARWICH PORT	MA	02646
2064	14-U10-0-R	KINEKE MARGARET TR 35 PILGRIM RD NOMINEE TRUST	35 PILGRIM RD	607 18TH AVE E	SEATTLE	WA	98112
2065	14-U11-0-R	41 PILGRIM ROAD LLC	41 PILGRIM RD	141 WEBSTER ST	W NEWTON	MA	01886
2066	14-V1-0-R	GOODHUE JOSEPH A JR & GOODHUE JANET L	39 SEA ST	15 W SEA COLONY DR	VERO BEACH	FL	32963
8510	14-V2-0-R	RAMLER DOUGLAS J TRS ET AL RAMLER JENNIFER R TRS	31 SEA ST	PO BOX 414	HARWICH PORT	MA	02646
19800	14-V3-0-E	KEMAH INN CONDOMINIUM TRUST TH C/O NEIL H CRONIN TRUSTEE	551 ROUTE 28	PO BOX 553	HARWICH PORT	MA	02646
17730	14-V3-2-R	AMALGAMATED BUSINESS CORPORATI	551-1-2 ROUTE 28	18 EAST 50TH ST 10TH FLOOR	NEW YORK	NY	10022
17731	14-V3-3-R	AMALGAMATED BUSINESS CORPORATI	551-1-3 ROUTE 28	18 EAST 50TH ST 10TH FLOOR	NEW YORK	NY	10022
17734	14-V3-5-R	AMALGAMATED BUSINESS CORPORATI	551-1-5 ROUTE 28	18 EAST 50TH ST 10TH FLOOR	NEW YORK	NY	10022
17735	14-V3-6-R	BERNHEIM KENNETH S & BERNHEIM AMY	551-2-6 ROUTE 28	92 WASHINGTON POST DR	WILTON	CT	06897
17727	14-V3-1A-R	AMALGAMATED BUSINESS CORPORATI	551-1-1A ROUTE 28	18 EAST 50TH ST 10TH FLOOR	NEW YORK	NY	10022
17728	14-V3-1B-R	AMALGAMATED BUSINESS CORPORATI	551-1-1B ROUTE 28	18 EAST 50TH ST 10TH FLOOR	NEW YORK	NY	10022
17729	14-V3-1C-R	AMALGAMATED BUSINESS CORPORATI	551-1-1C ROUTE 28	18 EAST 50TH ST 10TH FLOOR	NEW YORK	NY	10022

Key	Parcel ID	Owner	Location	Mailing Street	Mailing City	ST	ZipCd/Country
17732	14-V3-4A-R	AMALGAMATED BUSINESS CORPORATI	551-1-4A ROUTE 28	18 EAST 50TH ST 10TH FLOOR	NEW YORK	NY	10022
17733	14-V3-4B-R	AMALGAMATED BUSINESS CORPORATI	551-1-4B ROUTE 28	18 EAST 50TH ST 10TH FLOOR	NEW YORK	NY	10022
8513	14-V4-0-R	SAWIN GARY & SAWIN LISA B	547 ROUTE 28	34 HIGH ROCK ST	WESTWOOD	MA	02090
8518	14-V5-0-R	BELOIN MICHAEL J & BELOIN LAUREL G	549 ROUTE 28	23 WALNUT FARMS DR	FARMINGTON	CT	06032
8521	14-V8-0-R	555 CAMELOT LLC	555 ROUTE 28	200 GARRETT ST STE O	CHARLOTTESVILLE	VA	22902
2050	14-V9-0-E	HARWICH PORT COMMONS CONDO	557 ROUTE 28	200 GARRETT ST STE O	CHARLOTTESVILLE	VA	22902
28437	14-V9-101-R	HARWICH PORT COMMONS CONDO	557 ROUTE 28	200 GARRETT ST STE O	CHARLOTTESVILLE	VA	22902
28438	14-V9-201-R	HARWICH PORT COMMONS CONDO	557 ROUTE 28	200 GARRETT ST STE O	CHARLOTTESVILLE	VA	22902
28439	14-V9-202-R	HARWICH PORT COMMONS CONDO	557 ROUTE 28	200 GARRETT ST STE O	CHARLOTTESVILLE	VA	22902
28440	14-V9-203-R	HARWICH PORT COMMONS CONDO	557 ROUTE 28	200 GARRETT ST STE O	CHARLOTTESVILLE	VA	22902
28441	14-V9-204-R	HARWICH PORT COMMONS CONDO	557 ROUTE 28	200 GARRETT ST STE O	CHARLOTTESVILLE	VA	22902
2068	14-V11-0-R	HALL BONNIE MARTHA	38 BRADDOCK ST	38 BRADDOCK ST	HARWICH PORT	MA	02646
19704	14-V12-0-E	BEACH SIDE CONDOMINIUM ASSOCIA C/O JEANNE HEROUX PRES & TEAS	567 ROUTE 28	PO BOX 733	HARWICH PORT	MA	02646
8647	14-V12-1-R	SLOCUM JAN S LIFE ESTATE	567-1-1 ROUTE 28	116 NOB HILL DR	FRAMINGHAM	MA	01701
8648	14-V12-2-R	NEWBERY RICHARD & NEWBERY AMY	567-2-2 ROUTE 28	15 DALEY CIR	MARLBOROUGH	MA	01752-3031
8649	14-V12-3-R	THALL AARON J & THALL BARBARA W	567-3-3 ROUTE 28	131 HELLER WAY	MONTCLAIR	NJ	07043
11332	14-V12-4-R	HE JIE & CAI CHANGMENG	567-4-4 ROUTE 28	35 BOTHFELD RD	NEWTON	MA	02459
8651	14-V12-5-R	COSTELLO CAROL	567-5-5 ROUTE 28	46 MAYBERRY AVE	MEDFORD	MA	02155
19706	14-V12-C-0-R	CARROLL CORNELIA R TRS ET AL CARROLL DANIEL B TRS	42 BRADDOCK ST	42 BRADDOCK ST	HARWICH PORT	MA	02646
11704	14-V16-A-0-R	BORGATTI MARY ROSE TRS ET AL BORGATTI ROBERT ANTHONY TRS	46 BRADDOCK ST	3 JOB CUSHING RD	SHREWSBURY	MA	01545
2072	14-V17-0-R	MCCOURT PAUL J ET AL MCCOURT BRIAN E	36 BRADDOCK ST	870 EAST SIXTH ST UNIT 4	S BOSTON	MA	02127
2073	14-V18-0-R	VISCO BRUNO TRS ET AL CONROY SANDI TRS	34 BRADDOCK ST	176 OAKLEIGH RD	NEWTON	MA	02458
2079	14-V19-0-R	AMADEI ARTHUR P & AMADEI ELIZABETH A	28 BRADDOCK ST	2 FARM ST	MEDFIELD	MA	02052
2080	14-V20-0-R	GIUSTI JOHN P & GIUSTI LISA T	32 BRADDOCK ST	9 PRESTWICK DR	HOPKINTON	MA	01748
2096	14-V21-0-R	WALKER ALFRED J & WALKER HEATHER R	30 BRADDOCK ST	15 CEDAR RD	WHITEHOUSE STATION	NJ	08889
2195	14-Y8-0-R	HARRIS JACK L	40 BANK ST	40 BANK ST	HARWICH PORT	MA	02646
2197	14-Y10-0-R	JORDAN BRIAN B & JORDAN KARA	35 BRADDOCK ST	21 ATWOOD STROLL	E SANDWICH	MA	02537
2199	14-Y11-0-R	BRADY EDWARD A	29 BRADDOCK ST	101 SOUTH SEAS DR	JUPITER	FL	33477

<p>7-C6-0-R</p> <p>BEATTY THOMAS P & BEATTY ANNE M 27 BONAD RD W ROXBURY, MA 02131</p>	<p>7-C7-0-R</p> <p>WARD JEFFREY T & WARD MICHELLE THOMAS 50 TEMPLE RD WELLESLEY, MA 02482</p>	<p>7-C8-0-R</p> <p>ROBERGE GEORGE & DEBRA ET AL MCWHINNIE ELIZABETH A 7246 CHAPPARAL CIR E CENTENNIAL, CO 80016</p>
<p>7-D6-8-0-R</p> <p>CAMPBELL MARTHA M 57 KINGSWOOD RD AUBURNDALE, MA 02466</p>	<p>7-D6-9-0-R</p> <p>CAMPBELL MICHAEL C 4 WARE RD AUBURNDALE, MA 02466</p>	<p>7-D8-0-E</p> <p>SEA HEATHER CONDOMINIUM SEA HEATHER CONDOMINIUM TRUST C/O DENNIS E MILLER 15 COPELAND DR BEDFORD, MA 01730</p>
<p>7-D8-1-R</p> <p>MILLER DENNIS E TRS ET AL MILLER CHRISTINE A TRS 300 PIER 4 BLVD UNIT 31 BOSTON, MA 02210</p>	<p>7-D8-2-R</p> <p>MILLER DENNIS E TRS ET AL MILLER CHRISTINE A TRS 300 PIER 4 BLVD UNIT 31 BOSTON, MA 02210</p>	<p>7-D8-3-R</p> <p>FERRIE GAY TR GAY FERRIE 2016 REVOCABLE TRUS 33 FOREST ST 413 LEXINGTON, MA 02421</p>
<p>7-D8-4-R</p> <p>TRAVAGLINI BRENDA B TR BRENDA B TRAVAGLINI REVOCABLE 18 HARRISON ST WINCHESTER, MA 01890</p>	<p>7-D8-5-R</p> <p>TRUDEL CLAUDIA V 28 OYSTER LANDING RD HILTON HEAD, SC 29928</p>	<p>7-D8-6-R</p> <p>AZNOIAN GRACE 62 WILD ROSE DR ANDOVER, MA 01810</p>
<p>7-D8-7-R</p> <p>BOWMAN JOHN S & BOWMAN MARGARET J 12 CRESTVIEW RD BEDFORD, MA 01730</p>	<p>7-D9-0-R</p> <p>MALONE PETER C & MALONE MARSHA 27 SEA ST HARWICH PORT, MA 02646</p>	<p>7-D10-0-R</p> <p>MILLER-PUCKETT MARY JANE TR MARY JANE MILLER-PUCKETT REV T PO BOX 803 E ORLEANS, MA 02643</p>
<p>7-D11-0-R</p> <p>WHEELER CHARLES E TRS ET AL WHEELER SANDRA F TRS 48 BROOK RD WESTON, MA 02493</p>	<p>7-D12-0-R</p> <p>MCCARTHY KEVIN C & MCCARTHY MARY ANN Y 26 HIGHLAND CIR NEEDHAM, MA 02494</p>	<p>7-D13-0-R</p> <p>RIELLY JUDITH FALLON TR JUDITH FALLON RIELLY 1999 FAMI 5 SAIL LOFT RD HARWICH PORT, MA 02646</p>
<p>7-D20-0-R</p> <p>RAVENELLE EDITH S 254 HORSE POND RD SUDBURY, MA 01776</p>	<p>7-D21-2-0-R</p> <p>DOLAN SEAN J & DOLAN LINDA M PO BOX 633 HARWICH PORT, MA 02646</p>	<p>7-D21-3-0-R</p> <p>SHORTEN SUSAN C & SHORTEN GREG 1016 VENETIAN CT CARY, NC 27518-7103</p>
<p>7-D27-0-R</p> <p>RATTO FRANCES M ET AL TR SAIL LOFT ROAD NOMINEE TRUST 5 RICHARDSON DR NEEDHAM, MA 02492-2817</p>	<p>7-F3-0-R</p> <p>GLEDHILL BRUCE C TR 25 BRADDOCK LANE REALTY TRUST 235 NIGHT CAP LANE SALEM, SC 29676</p>	<p>7-F6-0-R</p> <p>BENZING PADI T 21 BRADDOCK ST HARWICH PORT, MA 02646</p>
<p>7-F7-0-R</p> <p>MERRILL ANDREW & ERICA ET ALS THURMAN KARIN B TR 6 RINGWOOD RD NORWALK, CT 06853</p>	<p>7-F8-0-R</p> <p>CMB REALTY CROUP LLC 83 LAZELL ST HINGHAM, MA 02043</p>	<p>7-F9-0-R</p> <p>16 BRADDOCK STREET LLC 16 BRADDOCK ST HARWICH PORT, MA 02646</p>
<p>7-F12-0-R</p> <p>DONNELLY CHARLES F TRS ET AL DONNELLY LAURA J TRS 24 BRADDOCK ST HARWICH PORT, MA 02646</p>	<p>7-F13-0-R</p> <p>MICHAUD MARC J TRS ET AL MICHAUC ALLISON TRS 11 CHERRY LN BEDFORD, NH 03110</p>	<p>7-F14-0-R</p> <p>ESTEN CLAIRE M, JASON ET ALS DEVENS KATHERINE, CHARLES III 5 KILLAM FARM LN SOUTHBORO, MA 01772</p>

14-P5-0-E	PILGRIM CONGREGATION 527 MAIN ST HARWICH PORT, MA 02646	14-U1-0-R	WARD CHRISTPHER A TR ET AL WARD WHITNEY A TRS 50 PLEASANT ST HINGHAM, MA 02043	14-U2-0-R	SKINNER NANCY R TR NANCY R SKINNER REALTY TRUST 39 BURNHAM RD BOLTON, MA 01740
14-U3-0-R	MIDDLETON MARGARET E ET AL GANLEY MARY ELIZABETH 5613 SOUTHWICK ST BETHESDA, MD 20817	14-U3-1-0-R	KANE ELLEN E C/O KANE ELLEN E TRS ET AL 15 GLEN RD WELLESLEY, MA 02481	14-U5-1-0-R	YORK LO TR ROUTE 28 NOMINEE REALTY TRUST 346 ADAMS ST QUINCY, MA 02169
14-U6-0-E	541-543 MAIN STREET CONDOMINIUMS TRUST C/O BRAX INC 51 OAK ST HARWICH, MA 02645	14-U6-A-1-R	541 MAIN STREET LLC 541 ROUTE 28 UNIT 1 HARWICH PORT, MA 02646	14-U6-A-2-R	541 MAIN STREET LLC 541 ROUTE 28 UNIT 2 HARWICH PORT, MA 02646
14-U6-B-3-R	541 MAIN STREET LLC 541 ROUTE 28 UNIT 3 HARWICH PORT, MA 02646	14-U6-B-4-R	541 MAIN STREET LLC 541 ROUTE 28 UNIT 4 HARWICH PORT, MA 02646	14-U8-0-R	CHASING SILVER LLC 15345 SW 88TH AVE PALMETTO BAY, FL 33157
14-U9-1-0-R	Vranos WILLIAM & VRANOS KATHLEEN PO BOX 629 30 GAFFIELD AVE MONUMENT BEACH, MA 02553	14-U9-2-0-R	SHARRY MAURA J 43-A SEA ST HARWICH PORT, MA 02646	14-U10-0-R	KINEKE MARGARET TR 35 PILGRIM RD NOMINEE TRUST 607 18TH AVE E SEATTLE, WA 98112
14-U11-0-R	41 PILGRIM ROAD LLC 141 WEBSTER ST W NEWTON, MA 01886	14-V1-0-R	GOODHUE JOSEPH A JR & GOODHUE JANET L 15 W SEA COLONY DR VERO BEACH, FL 32963	14-V2-0-R	RAMLER DOUGLAS J TRS ET AL RAMLER JENNIFER R TRS PO BOX 414 HARWICH PORT, MA 02646
14-V3-0-E	KEMAH INN CONDOMINIUM TRUST TH C/O NEIL H CRONIN TRUSTEE PO BOX 553 HARWICH PORT, MA 02646	14-V3-2-R	AMALGAMATED BUSINESS CORPORATI 18 EAST 50TH ST 10TH FLOOR NEW YORK, NY 10022	14-V3-3-R	AMALGAMATED BUSINESS CORPORATI 18 EAST 50TH ST 10TH FLOOR NEW YORK, NY 10022
14-V3-5-R	AMALGAMATED BUSINESS CORPORATI 18 EAST 50TH ST 10TH FLOOR NEW YORK, NY 10022	14-V3-6-R	BERNHEIM KENNETH S & BERNHEIM AMY 92 WASHINGTON POST DR WILTON, CT 06897	14-V3-1A-R	AMALGAMATED BUSINESS CORPORATI 18 EAST 50TH ST 10TH FLOOR NEW YORK, NY 10022
14-V3-1B-R	AMALGAMATED BUSINESS CORPORATI 18 EAST 50TH ST 10TH FLOOR NEW YORK, NY 10022	14-V3-1C-R	AMALGAMATED BUSINESS CORPORATI 18 EAST 50TH ST 10TH FLOOR NEW YORK, NY 10022	14-V3-4A-R	AMALGAMATED BUSINESS CORPORATI 18 EAST 50TH ST 10TH FLOOR NEW YORK, NY 10022
14-V3-4B-R	AMALGAMATED BUSINESS CORPORATI 18 EAST 50TH ST 10TH FLOOR NEW YORK, NY 10022	14-V4-0-R	SAWIN GARY & SAWIN LISA B 34 HIGH ROCK ST WESTWOOD, MA 02090	14-V5-0-R	BELOIN MICHAEL J & BELOIN LAUREL G 23 WALNUT FARMS DR FARMINGTON, CT 06032

14-V8-0-R	14-V9-0-E	14-V9-101-R
555 CAMELOT LLC 200 GARRETT ST STE O CHARLOTTESVILLE, VA 22902	HARWICH PORT COMMONS CONDO 200 GARRETT ST STE O CHARLOTTESVILLE, VA 22902	HARWICH PORT COMMONS CONDO 200 GARRETT ST STE O CHARLOTTESVILLE, VA 22902
14-V9-201-R	14-V9-202-R	14-V9-203-R
HARWICH PORT COMMONS CONDO 200 GARRETT ST STE O CHARLOTTESVILLE, VA 22902	HARWICH PORT COMMONS CONDO 200 GARRETT ST STE O CHARLOTTESVILLE, VA 22902	HARWICH PORT COMMONS CONDO 200 GARRETT ST STE O CHARLOTTESVILLE, VA 22902
14-V9-204-R	14-V11-0-R	14-V12-0-E
HARWICH PORT COMMONS CONDO 200 GARRETT ST STE O CHARLOTTESVILLE, VA 22902	HALL BONNIE MARTHA 38 BRADDOCK ST HARWICH PORT, MA 02646	BEACH SIDE CONDOMINIUM ASSOCIA C/O JEANNE HEROUX PRES & TEAS PO BOX 733 HARWICH PORT, MA 02646
14-V12-1-R	14-V12-2-R	14-V12-3-R
SLOCUM JAN S LIFE ESTATE 116 NOB HILL DR FRAMINGHAM, MA 01701	NEWBERY RICHARD & NEWBERY AMY 15 DALEY CIR MARLBOROUGH, MA 01752-3031	THALL AARON J & THALL BARBARA W 131 HELLER WAY MONTCLAIR, NJ 07043
14-V12-4-R	14-V12-5-R	14-V12-C-0-R
HE JIE & CAI CHANGMENG 35 BOTHFELD RD NEWTON, MA 02459	COSTELLO CAROL 46 MAYBERRY AVE MEDFORD, MA 02155	CARROLL CORNELIA R TRS ET AL CARROLL DANIEL B TRS 42 BRADDOCK ST HARWICH PORT, MA 02646
14-V16-A-0-R	14-V17-0-R	14-V18-0-R
BORGATTI MARY ROSE TRS ET AL BORGATTI ROBERT ANTHONY TRS 3 JOB CUSHING RD SHREWSBURY, MA 01545	MCCOURT PAUL J ET AL MCCOURT BRIAN E 870 EAST SIXTH ST UNIT 4 S BOSTON, MA 02127	VISCO BRUNO TRS ET AL CONROY SANDI TRS 176 OAKLEIGH RD NEWTON, MA 02458
14-V19-0-R	14-V20-0-R	14-V21-0-R
AMADEI ARTHUR P & AMADEI ELIZABETH A 2 FARM ST MEDFIELD, MA 02052	GIUSTI JOHN P & GIUSTI LISA T 9 PRESTWICK DR HOPKINTON, MA 01748	WALKER ALFRED J & WALKER HEATHER R 15 CEDAR RD WHITEHOUSE STATION, NJ 08889
14-Y8-0-R	14-Y10-0-R	14-Y11-0-R
HARRIS JACK L 40 BANK ST HARWICH PORT, MA 02646	JORDAN BRIAN B & JORDAN KARA 21 ATWOOD STROLL E SANDWICH, MA 02537	BRADY EDWARD A 101 SOUTH SEAS DR JUPITER, FL 33477