

DRAINAGE FACILITY PROFILE:

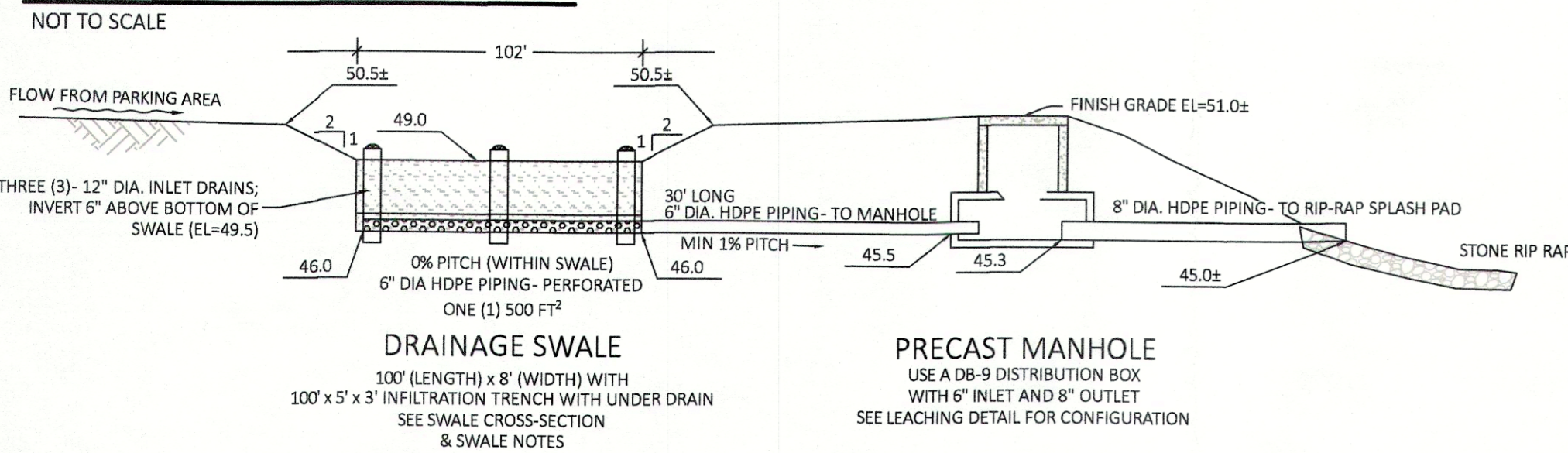

SWALE CROSS-SECTION

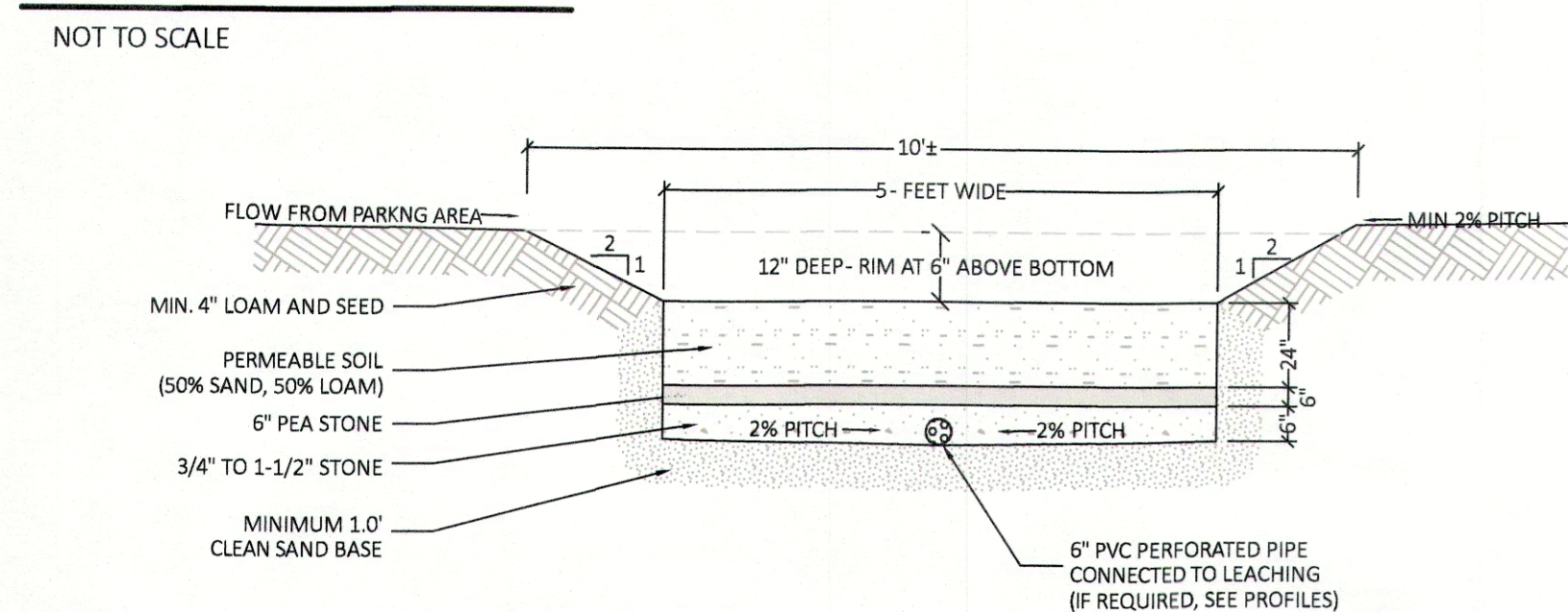

SWALE NOTES:

- 1) THE SWALE SOIL BEDS AND LOWER SLOPED AREAS SHALL BE A MINIMUM OF 30" DEEP AND COMPOSED OF APPROXIMATELY 50% SAND AND 50% LOAM. UPPER SLOPED SWALE AREAS SHALL BE COVERED WITH A MINIMUM OF 4" INCHES OF LOAM. SEE SWALE DETAIL.
- 2) ALL SLOPED SWALE AREAS SHALL BE COVERED WITH JUTE NETTING EROSION CLOTH, SECURED IN PLACE. JUTE NETTING SHALL REMAIN IN PLACE UNTIL VEGETATION HAS BEEN ESTABLISHED.
- 3) NON-WOVEN FILTER FABRIC LAYER SHALL BE INSTALLED IN BETWEEN THE PERMEABLE SOIL AND STONE LAYERS.
- 4) 6" HDPE PERFORATED PIPE SHALL BE INSTALLED ALONG THE CENTERLINE OF THE SWALE AT THE BOTTOM OF THE STONE LAYER. PERFORATED PIPE SHALL CONNECT TO 6" SOLID HDPE PIPE THAT OUTLETS INTO THE MANHOLE.

RIP-RAP SPLASH PAD DETAIL:

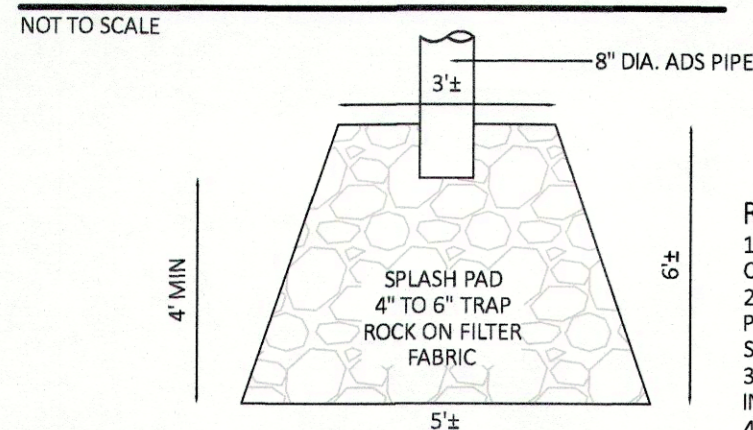

- RIPRAP NOTES:**
- 1) THE RIPRAP SHALL BE INSTALLED ONCE THE SWALE CHANNEL IS GRADED AND ESTABLISHED.
 - 2) RIPRAP STONE SHALL BE 4" TO 6" CHINK STONE PLACED IN RANDOM PATTERN WITH UNEVEN SURFACE.
 - 3) THE RIPRAP SHALL BE 12" THICK AND EXTEND 2 INCHES ABOVE THE PROPOSED GRADE.
 - 4) RIPRAP STONE SHALL BE LAID ON A DOUBLE LAYER OF FILTER FABRIC.

STRAW WATTLE/EROSION CONTROL DETAIL

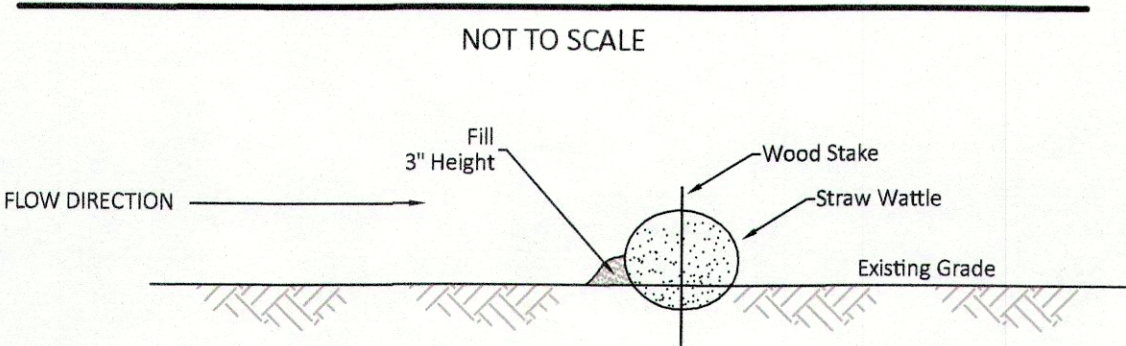

EROSION CONTROL NOTES:

- 1) LIMIT OF WORK SHALL BE MADE UP OF A 9" DIAMETER STRAW WATTLE INSTALLED PER THE MANUFACTURERS SPECIFICATIONS. LIMIT OF WORK LINE SHALL BE THE LIMITS OF THE LEASED PERIMETER ON THE EAST SIDE AND THE PROPERTY BOUNDARIES ON THE NORTH AND SOUTH SIDES OF THE PROJECT SITE.
- 2) CONTRACTOR SHALL BE RESPONSIBLE FOR PREVENTING EROSION/RUNOFF DURING CONSTRUCTION.
- 3) LIMIT OF WORK SHALL BE INSTALLED PRIOR TO START OF WORK, AND SHALL BE MAINTAINED IN PLACE FOR THE ENTIRETY OF CONSTRUCTION ACTIVITIES ON SITE, UNTIL ALL DISTURBED AREAS HAVE BEEN REVEGETATED AND/OR STABILIZED.
- 4) ALL PROPOSED CATCH BASIN RIMS SHALL HAVE FILTER FABRIC INSTALLED UNDER THE RIM AFTER INSTALLATION UNTIL CONSTRUCTION ACTIVITIES ARE COMPLETE. FILTER FABRIC SHALL BE CLEANED OF ANY SEDIMENT AS NEEDED. SEDIMENT MUST BE REMOVED FROM THE AREA OF THE STRAW WATTLE BARRIER IF IT HAS ACCUMULATED TO 1/2 OF THE ABOVE GROUND HEIGHT.
- 5) ALL PROPOSED STORMWATER SUBSURFACE LEACHING FACILITIES SHALL BE SURROUNDED BY STRAW WATTLES TO PROTECT THE AREA FROM EROSION AND/OR SOIL ACCRETION UNTIL CONSTRUCTION ACTIVITIES ARE COMPLETE.
- 6) MATERIAL STOCKPILES SHALL BE LOCATED WITHIN LIMIT OF WORK AND SHALL BE PHYSICALLY SEPARATED FROM CONTACT WITH STORMWATER THROUGH THE USE OF STRAW WATTLES. STOCKPILES SHALL BE COVERED OR STABILIZED AS NECESSARY TO PROTECT AGAINST EROSION AND DUST GENERATION.
- 7) CONTRACTOR SHALL INSPECT THE LIMIT OF WORK DAILY AND IMMEDIATELY REPAIR ANY DAMAGED SECTIONS ON THE STRAW WATTLE. CONTRACTOR SHALL KEEP A MINIMUM OF 25' OF EXTRA STRAW WATTLE ON SITE TO ALLOW FOR QUICK REPAIR OF ANY DAMAGED SECTIONS.

GRAVEL & PARKING GUARDRAIL DETAIL

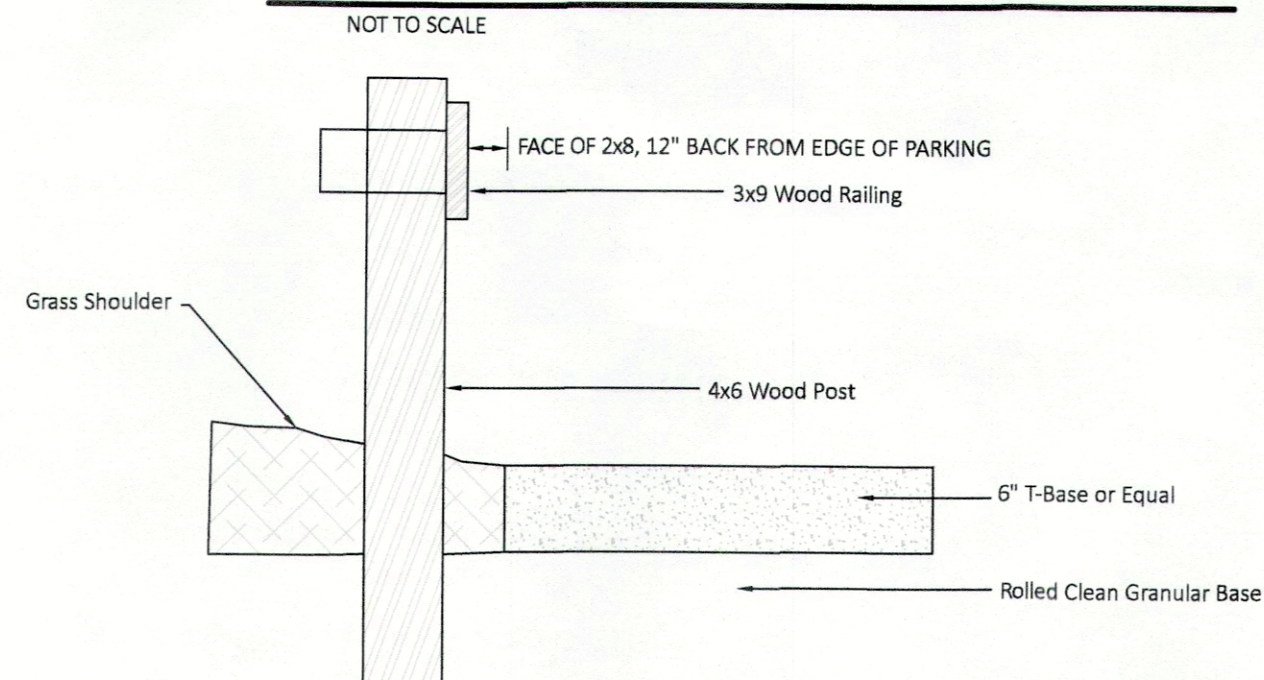

WOODEN GUARDRAIL SECTION:

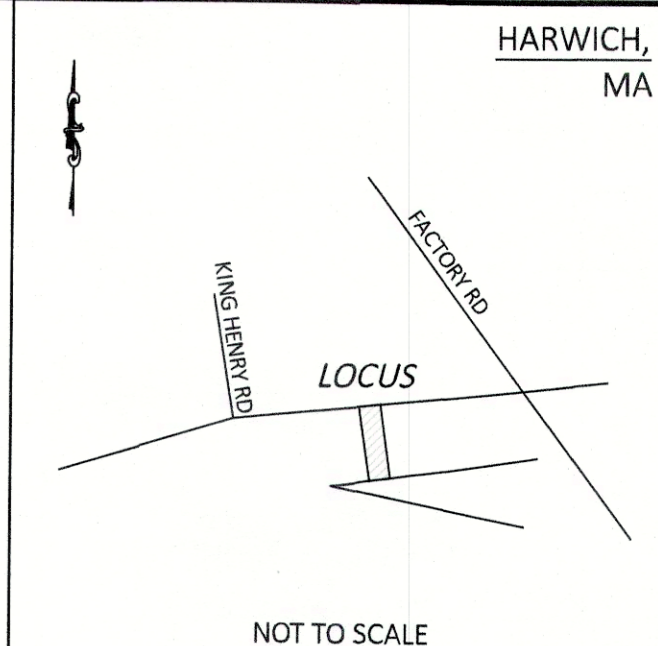
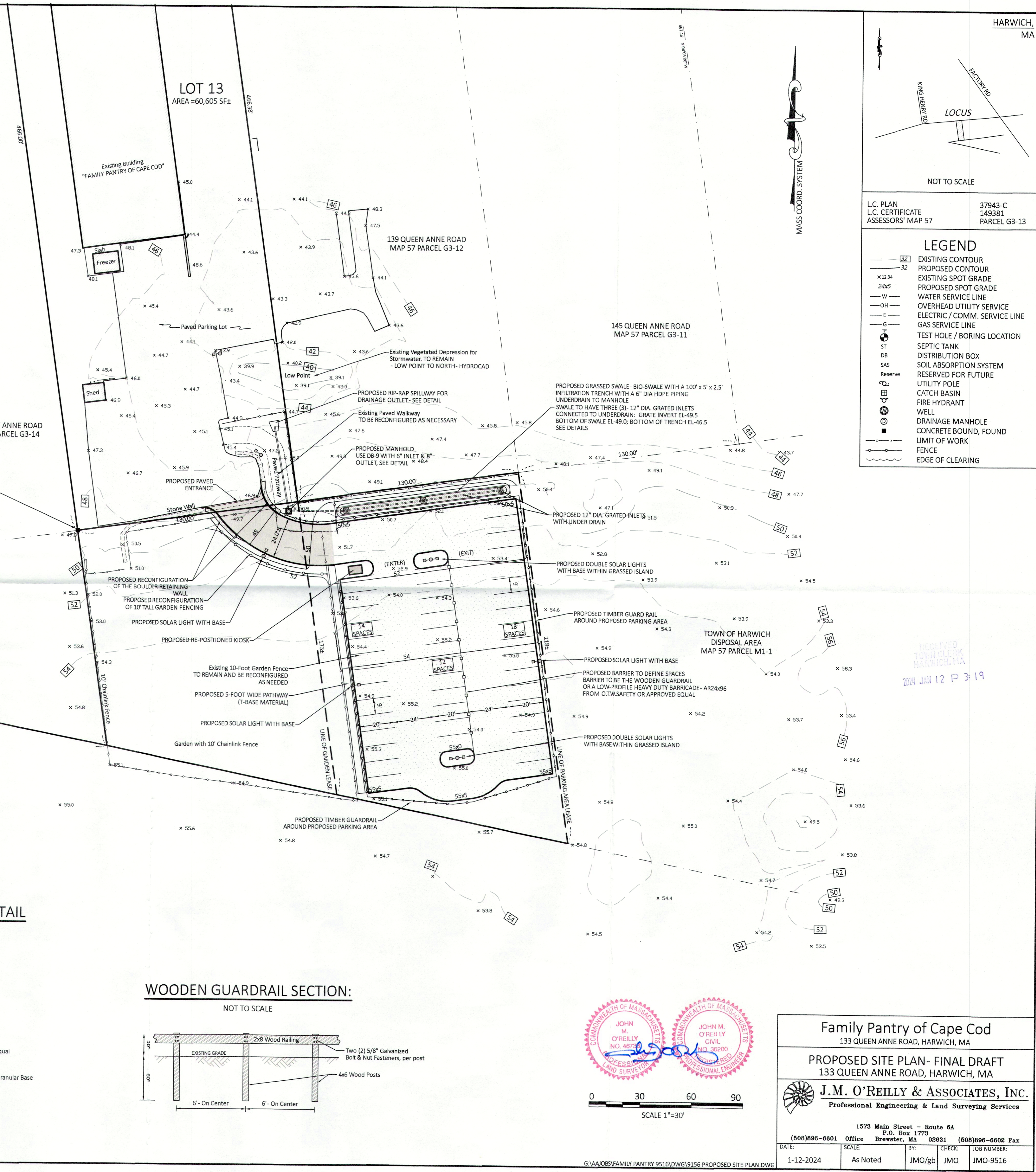
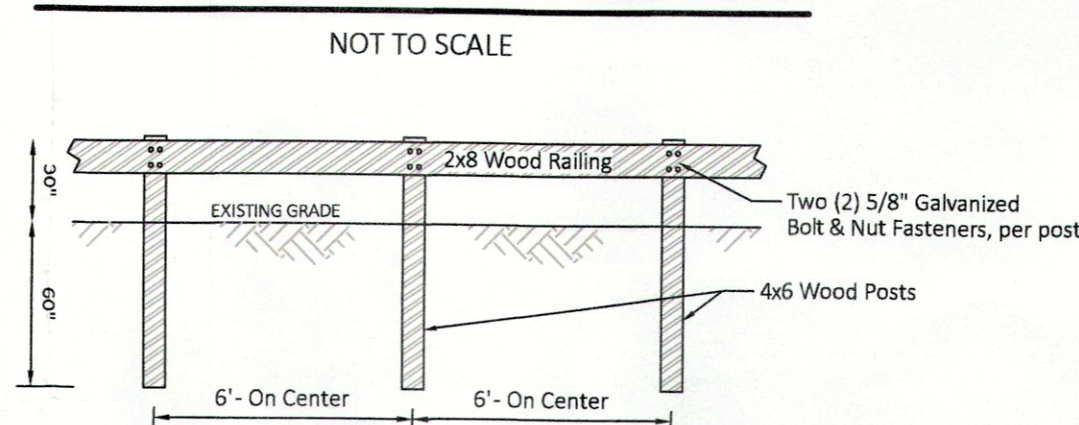

L.C. PLAN 37943-C
L.C. CERTIFICATE 149381
ASSESSORS' MAP 57 PARCEL G3-13

LEGEND

—	EXISTING CONTOUR
—	PROPOSED CONTOUR
—	EXISTING SPOT GRADE
—	PROPOSED SPOT GRADE
—	WATER SERVICE LINE
—	OVERHEAD UTILITY SERVICE
—	ELECTRIC / COMM. SERVICE LINE
—	GAS SERVICE LINE
—	TEST HOLE / BORING LOCATION
—	SEPTIC TANK
—	DISTRIBUTION BOX
—	SOIL ABSORPTION SYSTEM
—	RESERVED FOR FUTURE UTILITY POLE
—	CATCH BASIN
—	FIRE HYDRANT
—	WELL
—	DRAINAGE MANHOLE
—	CONCRETE BOUND, FOUND
—	LIMIT OF WORK
—	FENCE
—	EDGE OF CLEARING

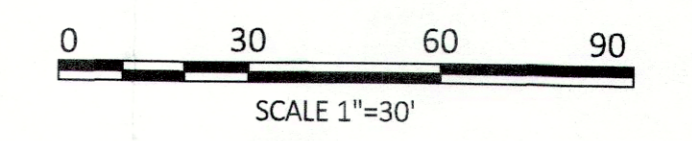
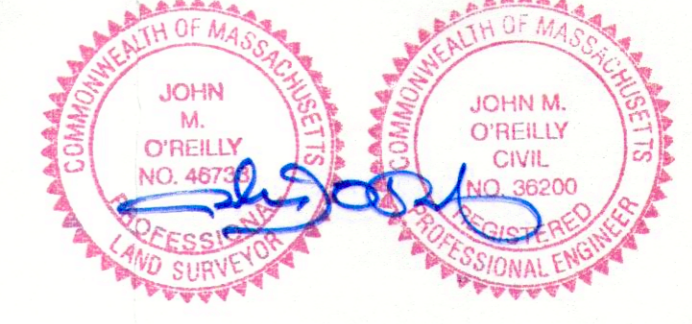

Family Pantry of Cape Cod
133 QUEEN ANNE ROAD, HARWICH, MA

PROPOSED SITE PLAN - FINAL DRAFT
133 QUEEN ANNE ROAD, HARWICH, MA

J.M. O'REILLY & ASSOCIATES, INC.
Professional Engineering & Land Surveying Services

1573 Main Street - Route 6A
P.O. Box 1773
Brewster, MA 02631 (508)896-6601 Fax (508)896-6602

DATE: 1-12-2024	SCALE: As Noted	BY: JMO/gb	CHECK: JMO	JOB NUMBER: JMO-9516
-----------------	-----------------	------------	------------	----------------------