

DRAINAGE FACILITY PROFILE:

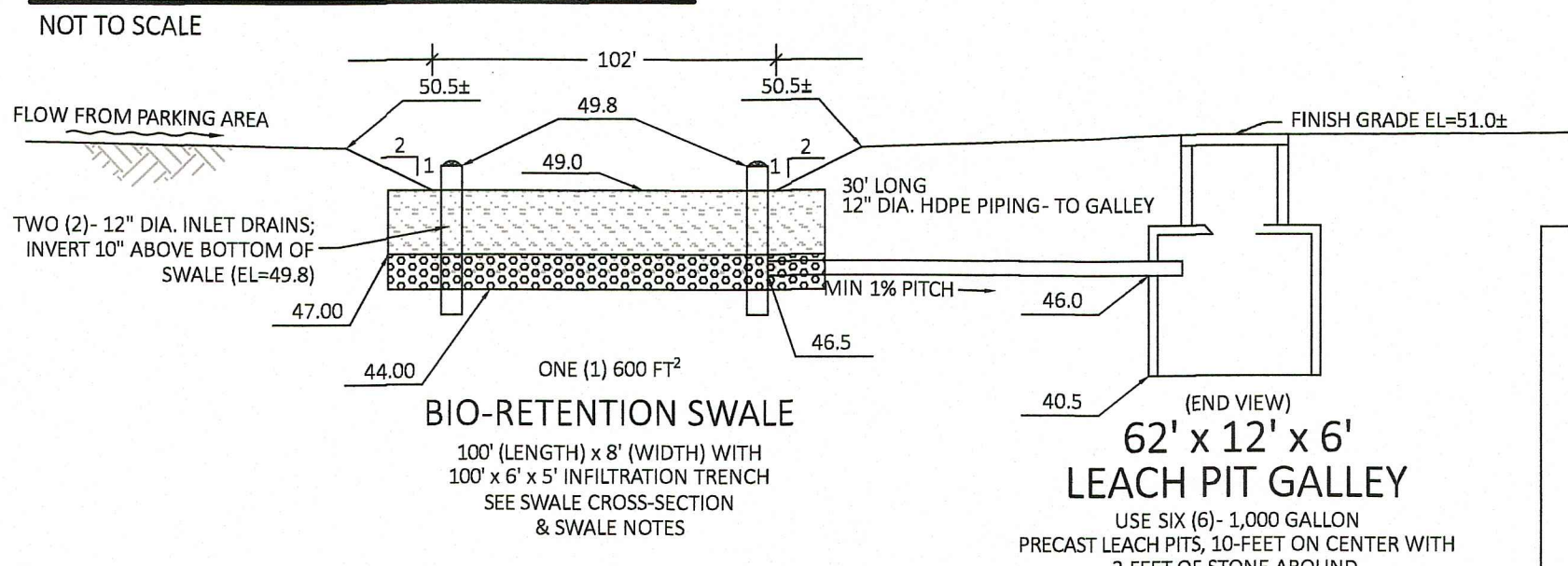

SWALE NOTES:

- 1.) THE SWALE SOIL BEDS AND LOWER SLOPED AREAS SHALL BE 24" DEEP AND COMPOSED OF APPROXIMATELY 50% SAND AND 50% LOAM. UPPER SLOPED SWALE AREAS SHALL BE COVERED WITH A MINIMUM OF 4 INCHES OF LOAM. SEE SWALE DETAIL.
- 2.) ALL SLOPED SWALE AREAS SHALL BE COVERED WITH JUTE NETTING EROSION CLOTH, SECURED IN PLACE. JUTE NETTING SHALL REMAIN IN PLACE UNTIL VEGETATION HAS BEEN ESTABLISHED.
- 3.) NON-WOVEN FILTER FABRIC LAYER SHALL BE INSTALLED IN BETWEEN THE PERMEABLE SOIL AND STONE LAYERS AND ALONG THE SIDES OF THE STONE LAYER.

SWALE CROSS-SECTION

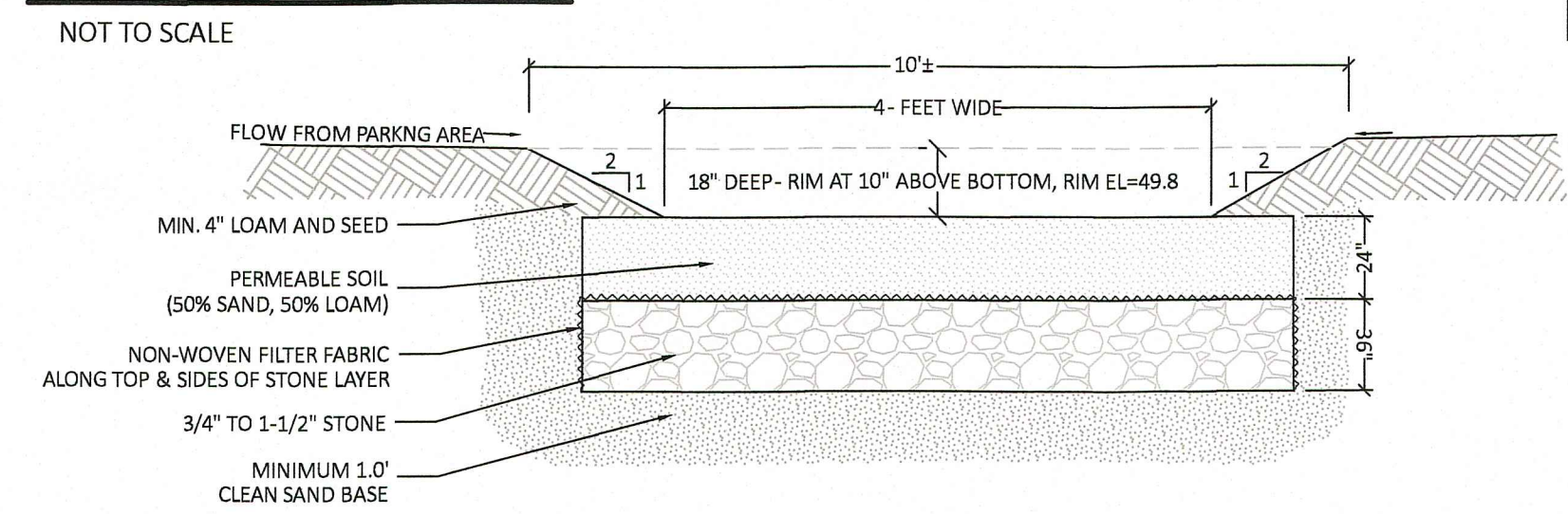

LEACH GALLEY PLAN VIEW DETAIL

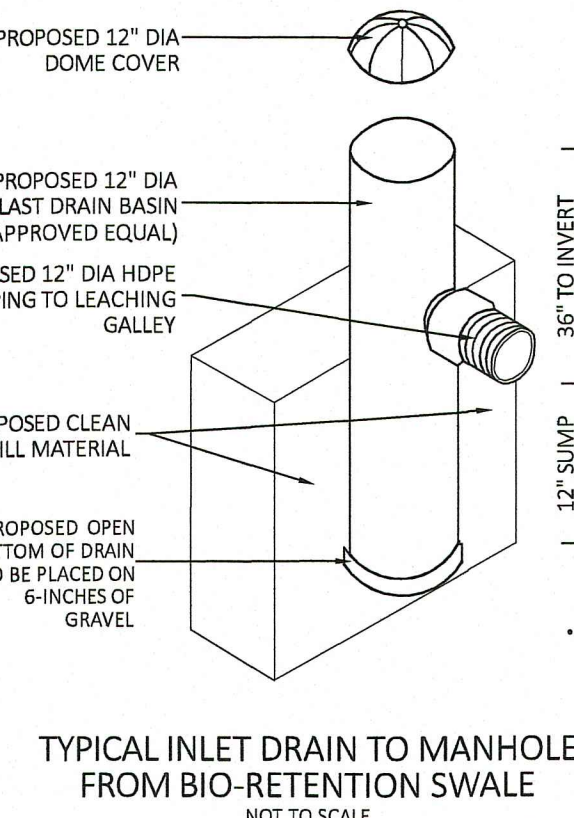
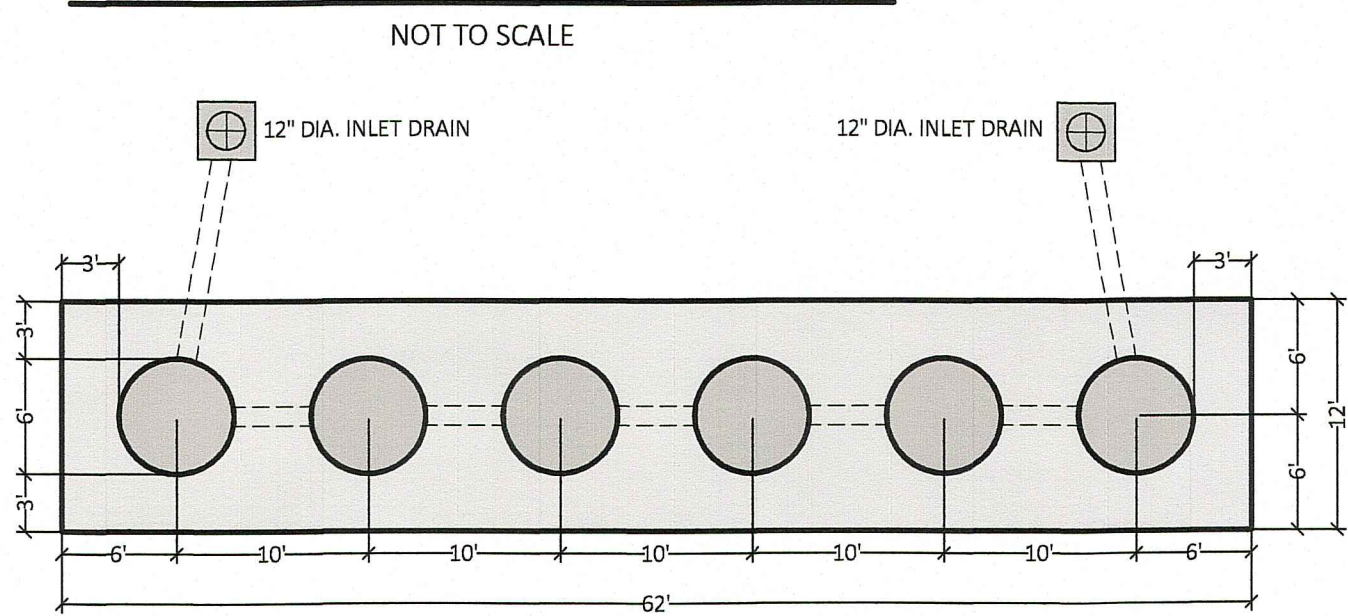

STRAW WATTLE/EROSION CONTROL DETAIL

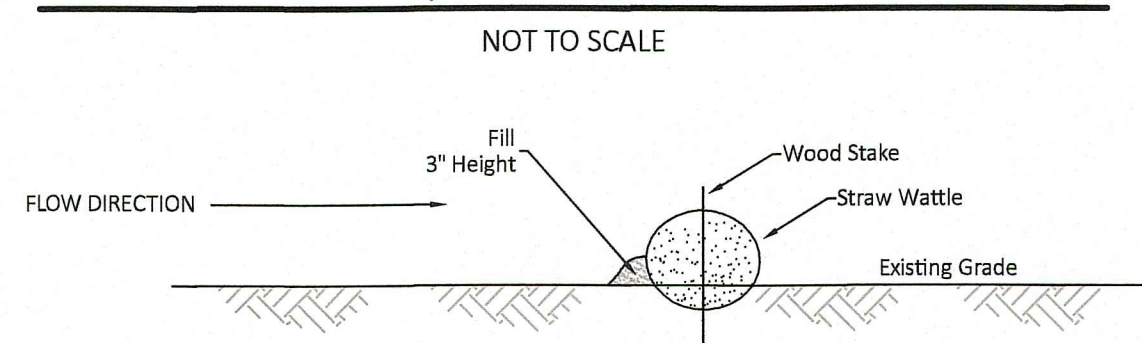

EROSION CONTROL NOTES:

- 1.) LIMIT OF WORK SHALL BE MADE UP OF A 9" DIAMETER STRAW WATTLE INSTALLED PER THE MANUFACTURER'S SPECIFICATIONS. LIMIT OF WORK LINE SHALL BE THE LIMITS OF THE LEASED PERIMETER ON THE EAST SIDE AND THE PROPERTY BOUNDARIES ON THE NORTH AND SOUTH SIDES OF THE PROJECT SITE.
- 2.) CONTRACTOR SHALL BE RESPONSIBLE FOR PREVENTING EROSION/ RUNOFF DURING CONSTRUCTION.
- 3.) LIMIT OF WORK SHALL BE INSTALLED PRIOR TO START OF WORK, AND SHALL BE MAINTAINED IN PLACE FOR THE ENTIRETY OF CONSTRUCTION ACTIVITIES ON SITE, UNTIL ALL DISTURBED AREAS HAVE BEEN REVEGETATED AND/OR STABILIZED.
- 4.) ALL PROPOSED CATCH BASIN RIMS SHALL HAVE FILTER FABRIC INSTALLED UNDER THE RIM AFTER INSTALLATION UNTIL CONSTRUCTION ACTIVITIES ARE COMPLETE. FILTER FABRIC SHALL BE CLEANED OF ANY SEDIMENT AS NEEDED. SEDIMENT MUST BE REMOVED FROM THE AREA OF THE STRAW WATTLE BARRIER IF IT HAS ACCUMULATED TO 1/2 OF THE ABOVE GROUND HEIGHT.
- 5.) ALL PROPOSED STORMWATER SUBSURFACE LEACHING FACILITIES SHALL BE SURROUNDED BY STRAW WATTLES TO PROTECT THE AREA FROM EROSION AND/OR SOIL ACCRETION UNTIL CONSTRUCTION ACTIVITIES ARE COMPLETE.
- 6.) MATERIAL STOCKPILES SHALL BE LOCATED WITHIN LIMIT OF WORK AND SHALL BE PHYSICALLY SEPARATED FROM CONTACT WITH STORMWATER THROUGH THE USE OF STRAW WATTLES. STOCKPILES SHALL BE COVERED OR STABILIZED AS NECESSARY TO PROTECT AGAINST EROSION AND DUST GENERATION.
- 7.) CONTRACTOR SHALL INSPECT THE LIMIT OF WORK DAILY AND IMMEDIATELY REPAIR ANY DAMAGED SECTIONS ON THE STRAW WATTLE. CONTRACTOR SHALL KEEP A MINIMUM OF 25' OF EXTRA STRAW WATTLE ON SITE TO ALLOW FOR QUICK REPAIR OF ANY DAMAGED SECTIONS.

DETAIL OF DRAINAGE CONNECTION TO LEACH GALLEY

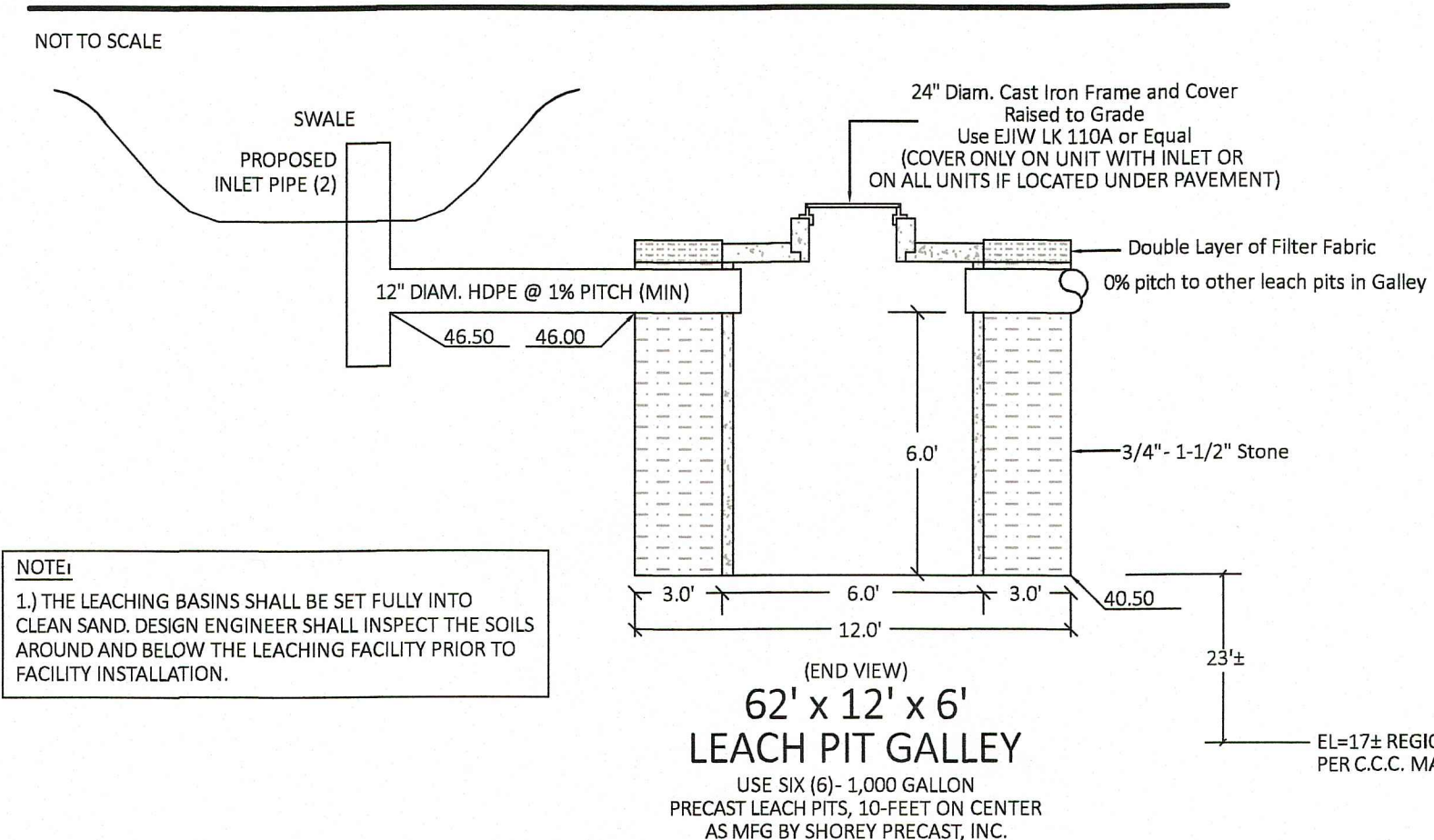

NOTE:
1.) THE LEACHING BASINS SHALL BE SET FULLY INTO CLEAN SAND. DESIGN ENGINEER SHALL INSPECT THE SOILS AROUND AND BELOW THE LEACHING FACILITY PRIOR TO FACILITY INSTALLATION.

BOULDER WALL RELOCATION DETAIL:

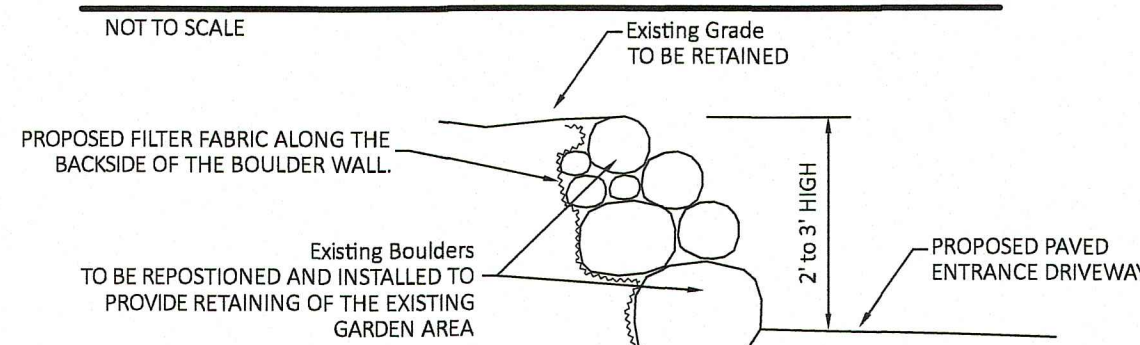

BOULDER WALL NOTES:

- 1.) THE EXISTING BOULDER WALL, AS NOTED, SHALL BE REMOVED TO ALLOW THE PROPOSED PAVED DRIVEWAY ENTRANCE TO THE REAR PARKING AREA.
- 2.) THE BOULDER WALL SHALL BE RECONSTRUCTED TO PROVIDE A GRADE TRANSITION FROM THE EXISTING GARDEN AREA TO THE PARKING & DRIVEWAY.
- 3.) BOULDER WALL SHALL BE MATCH THE HEIGHT OF THE EXISTING WALL AT 2 TO 3 FEET.
- 4.) THE BOULDERS SHALL BE DRY-LAID AND SUPPORTED BY 4 TO 6 INCH CHINK (RIP-RAP) STONE, AS REQUIRED.

GRAVEL & PARKING GUARDRAIL DETAIL

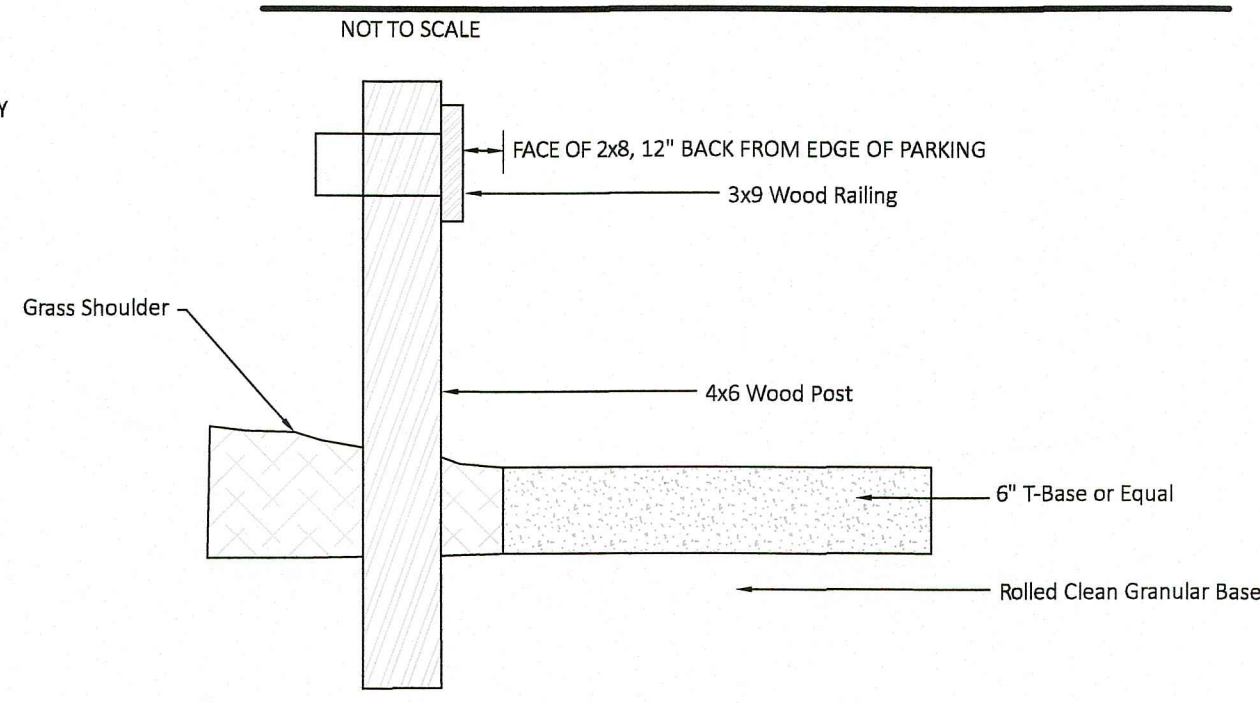

WOODEN GUARDRAIL SECTION:

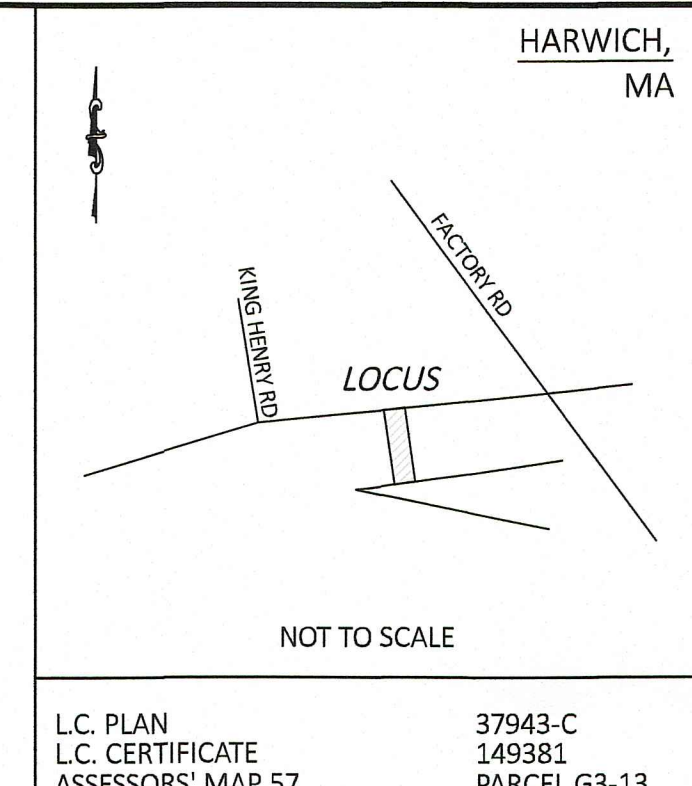
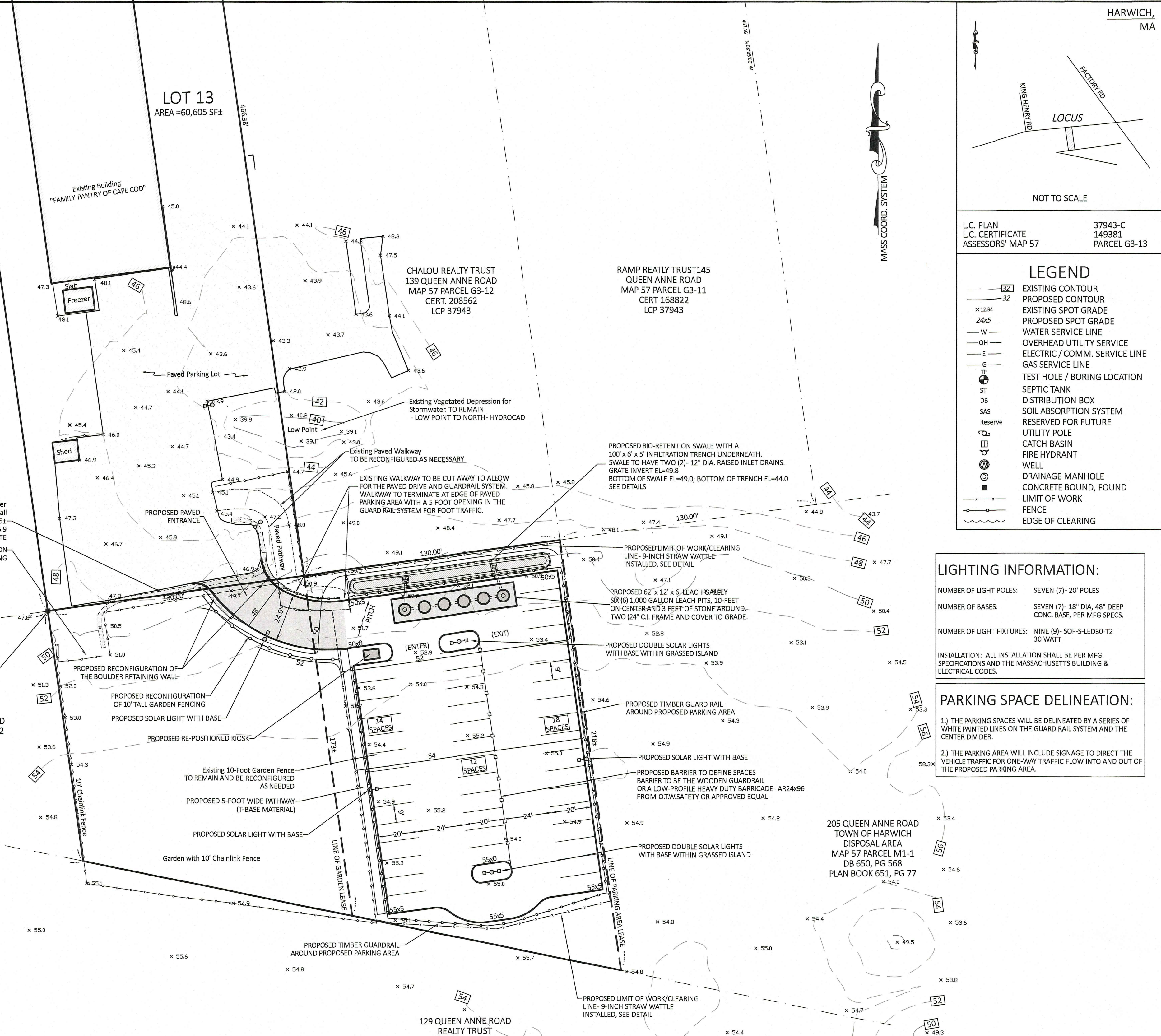
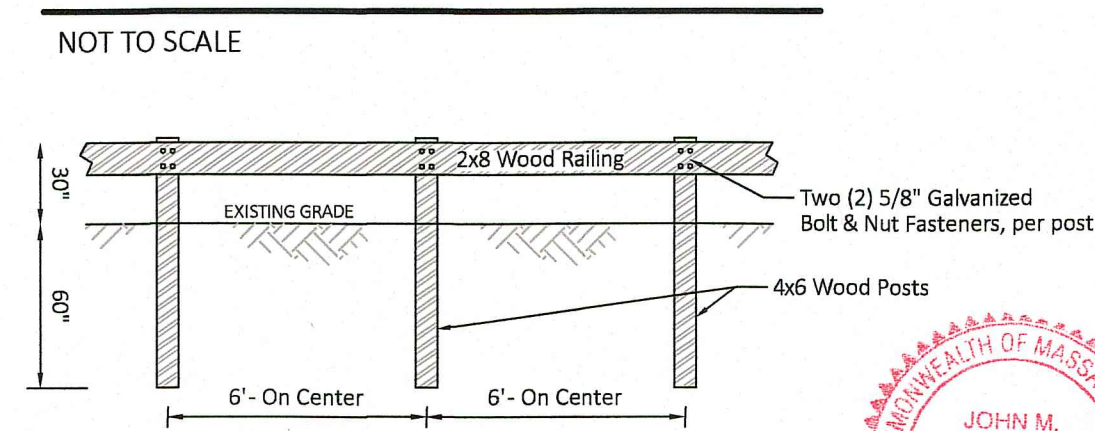

LEGEND

- EXISTING CONTOUR
- PROPOSED CONTOUR
- EXISTING SPOT GRADE
- PROPOSED SPOT GRADE
- WATER SERVICE LINE
- OVERHEAD UTILITY SERVICE
- ELECTRIC / COMM. SERVICE LINE
- GAS SERVICE LINE
- TEST HOLE / BORING LOCATION
- SEPTIC TANK
- DISTRIBUTION BOX
- SOIL ABSORPTION SYSTEM
- RESERVED FOR FUTURE
- UTILITY POLE
- CATCH BASIN
- FIRE HYDRANT
- WELL
- DRAINAGE MANHOLE
- CONCRETE BOUND, FOUND
- LIMIT OF WORK
- FENCE
- EDGE OF CLEARING

LIGHTING INFORMATION:

NUMBER OF LIGHT POLES: SEVEN (7)- 20' POLES
 NUMBER OF BASES: SEVEN (7)- 18" DIA, 48" DEEP CONC. BASE, PER MFG SPECS.
 NUMBER OF LIGHT FIXTURES: NINE (9)- SOF-5-LED30-T2 30 WATT

INSTALLATION: ALL INSTALLATION SHALL BE PER MFG. SPECIFICATIONS AND THE MASSACHUSETTS BUILDING & ELECTRICAL CODES.

PARKING SPACE DELINEATION:

- 1.) THE PARKING SPACES WILL BE DELINEATED BY A SERIES OF WHITE PAINTED LINES ON THE GUARD RAIL SYSTEM AND THE CENTER DIVIDER.
- 2.) THE PARKING AREA WILL INCLUDE SIGNAGE TO DIRECT THE VEHICLE TRAFFIC FOR ONE-WAY TRAFFIC FLOW INTO AND OUT OF THE PROPOSED PARKING AREA.

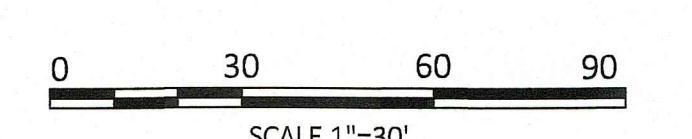

REVISED 2-12-2024: ADDED LIGHTING SPECIFICATIONS; ADDED BOULDER WALL NOTES FOR RECONSTRUCTION; REVISED AND EXPANDED THE STORMWATER FACILITIES; ELIMINATED THE OVERFLOW OUTLET AND ADDED LEACH GALLEY; UPDATED SECTIONS AND DETAILS ACCORDINGLY; ADDED DEED AND PLAN INFO FOR ABUTTERS

Family Pantry of Cape Cod
 133 QUEEN ANNE ROAD, HARWICH, MA

PROPOSED SITE PLAN - FINAL DRAFT
 133 QUEEN ANNE ROAD, HARWICH, MA

J.M. O'REILLY & ASSOCIATES, INC.
 Professional Engineering & Land Surveying Services

1573 Main Street - Route 6A
 P.O. Box 1773
 (508)896-8601 Office Brewster, MA 02631 (508)896-6602 Fax

DATE: 1-12-2024 SCALE: As Noted BY: JMO/gb CHECK: JMO JOB NUMBER: JMO-9516