

The Commonwealth of Massachusetts  
DEPARTMENT OF PUBLIC WORKS  
100 Nashua St., Boston



City or town....HARWICH.....  
Location. Pleasant Bay Road.....  
at Route 28.....  
Date...3/9/66.....Permit No. 10556..

ISOLATED STOP

STATE HIGHWAY

TRAFFIC SIGN PERMIT

Under authority of Chapter..89..Section..8..of the General Laws, Tercentenary Edition, the Department of Public Works hereby approves the following described traffic signs for the above location, provided that a permit for the opening of the road and the placing of structures thereon shall be received from the board or officer in charge of the road.

I LOCATION

Signs shall be located in strict accordance with Official Standards of the Department.

II DESCRIPTION

- (a) Design # (1) Identical with Official Department Standards.
- (2) Different from any sign described in Official Department Standards and in accordance with specifications shown on attached drawing.

DEPARTMENT OF PUBLIC WORKS

By

Commissioner  
D. R. Dwyer  
Anthony C. Fosselli

Robert S. Foster  
Associate Commissioners.

COMMONWEALTH OF MASSACHUSETTS  
DEPT. OF PUBLIC WORKS  
100 NASHUA STREET  
BOSTON, MASS.

TOWN: *Warwick*  
LOCATION: *Pleasant Bay Rd. & Route 28*  
*& Kendrick Road & Route 28*  
DATE: *2/9/76* PLANT NO.:

STATE HIGHWAY

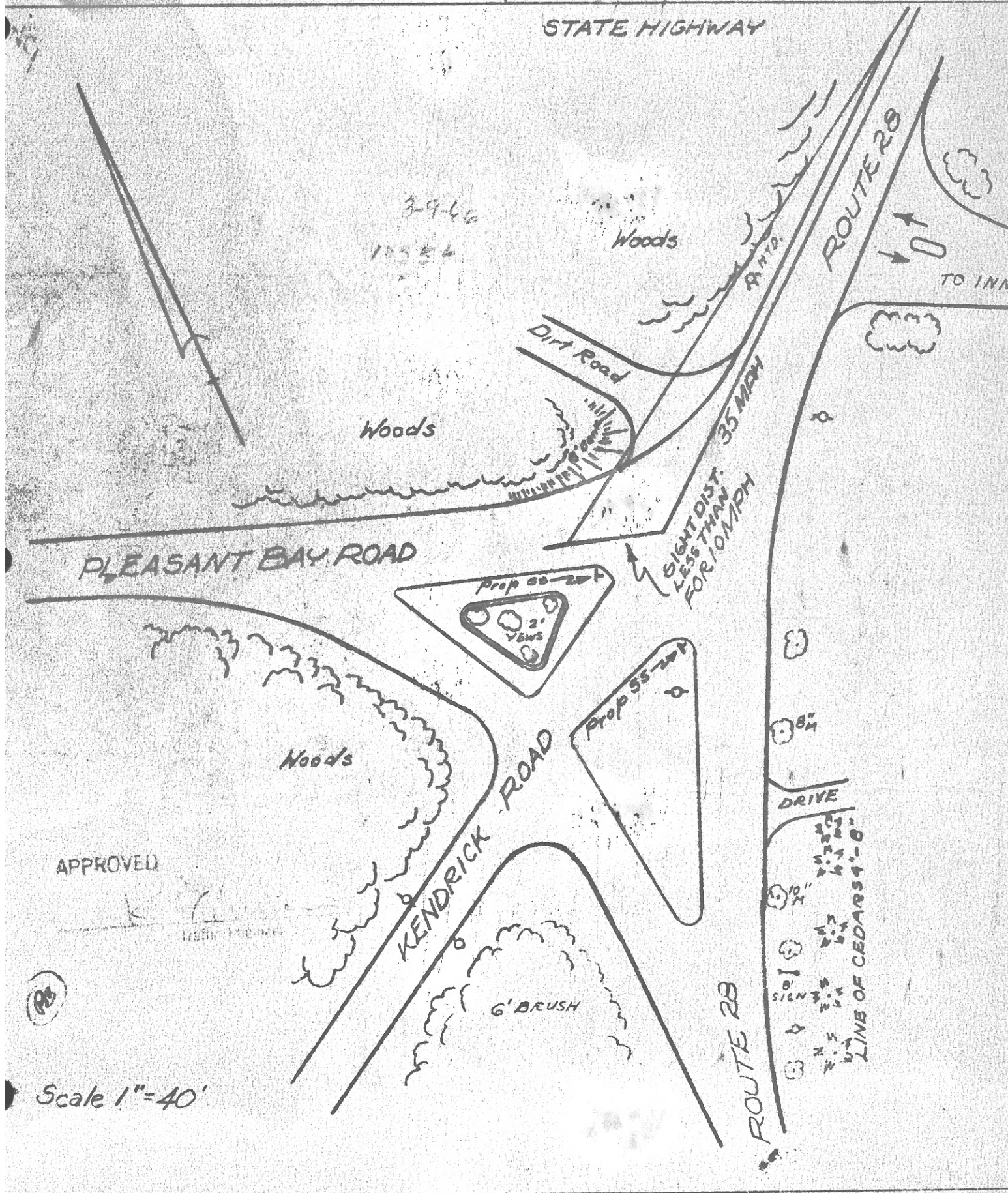





# TOWN OF HARWICH

Office of Selectmen • Assessors • Boards of Health and Public Welfare

Douglas Rockwood • Milton H. Welt • Ralph U. Brett

HARWICH, MASSACHUSETTS

"Voted: That the Traffic Rules and Orders of the Town of Harwich adopted by the Board of Selectmen July 1, 1940 and subsequent amendments thereto, be and are hereby further amended as follows:"

By adding at the end of Article VIII, Section 8, the following new descriptions:

- 9577 West bound drivers on Chatham Road at Route 39
- 9578 North & South bound drivers on Ocean Avenue at Park Street
- 9579 North bound drivers on Ocean Avenue at Lower County Road
- 9570 North bound drivers on Wequasset Road at Lower County Road
- 9571 South bound drivers on Victory Drive at Lower County Road
- 9572 East bound drivers on Shore Road at Grey Neck Road
- 9573 West bound drivers on Willow Street at Division Street
- 9574 North & South bound drivers on Depot Road at Great Western Road
- 9575 East & West bound drivers on Main Street at Depot Road
- 9576 North & South bound drivers on Lothrop Avenue at Great Western Road
- 9577 North bound drivers on South Street at Main Street
- 9578 East & West bound drivers on Queen Anne Road at Pleasant Lake Avenue
- 9579 North bound drivers on Bank Street at Main Street (Route 39)
- 9580 North & South bound drivers on Cross Street at Pleasant Street
- 9581 North bound drivers on Cross Street at Miles Street
- 9582 Northeast bound drivers on Doane Road at South Street
- 9583 East and West bound drivers on Gilbert Lane at Doane Road
- 9584 West bound drivers on Gilbert Lane at Sisson Road
- 9585 East & West bound drivers on Pleasant Bay Road at Route 39
- 9586 East & West bound drivers on Bay Road at Church Street
- 9587 Northeast & Southwest bound drivers on Cemetery Road at Route 137
- 9588 South bound drivers on Pleasant Lake Avenue at Main Street
- 9589 Eastbound drivers on Main Street at Sisson Road
- 9590 North and eastbound drivers on Great Western Road at Old Chatham Road

Date of Passage: July 19, 1963

Douglas Rockwood  
Milton H. Welt  
Ralph U. Brett  
Board of Selectmen

Attest of Town Clerk

Leslie V. Nickerson ."

The Commonwealth of Massachusetts  
DEPARTMENT OF PUBLIC WORKS  
100 NASHUA STREET, BOSTON



City or town..... HARWICH  
Date.. August 20, 1963. Permit No. 11966.

ISOLATED STOP SIGNS

## TRAFFIC REGULATION PERMIT

No. T- 18

Under authority of Chapter..... 85..... Section..... 2..... of the General Laws, Tercentenary Edition, the Department of Public Works, hereby approves the..... Rules and Orders..... made by the ..... Board of Selectmen of..... Harwich..... on..... July 19, 1963..... with such stipulations and exceptions, if any, as are noted herein.

The validity of this permit is contingent upon the conformance of the signs, erected or used in connection with these Rules and Orders  
~~xxx~~....., with the standards prescribed by the Department of Public Works.

This traffic regulation  
covers erection of stop  
signs under traffic sign  
permits nos. 9567-9590  
inclusive.

DEPARTMENT OF PUBLIC WORKS

By.....  
Commissioner.

George C. Thompson  
Associate Commissioners.



The Commonwealth of Massachusetts

DEPARTMENT OF PUBLIC WORKS

100 Nashua St. - BOSTON.



City or Town..... HARWICH

Location..... Pleasant Bay Road

..... at Route 39

Date..... 8/20/63 Permit No. 9585

ISOLATED STOP

## TRAFFIC SIGN PERMIT

Under authority of Chapter 89, Section 8, of the General Laws, Tercentenary Edition, the Department of Public Works hereby approves the following described traffic signs for the above location, provided that a permit for the opening of the road and the placing of structures thereon shall be received from the board or officer in charge of the road.

### I LOCATION

Signs shall be located in strict accordance with Traffic Bulletin No. 3 and the attached drawing.

### II DESCRIPTION

- (a) Design (1) Identical with Figure..... Traffic Bulletin No. 3
- (2) Identical with Figure 12(d)..... Traffic Bulletin No. 3 except that wording shall be as follows. .... STOP ..... \*See below
- (3) Identical with Figure ..... Traffic Bulletin No. 3, except that the wording ..... shall be omitted
- (4) Different from any sign described in Bulletin No. 3 and in accordance with specifications shown on attached drawing.
- \*and that the colors shall be white legend and border on RED background.

Traffic regulation permit  
no. 11966 covers erection  
of stop signs under this  
permit.

DEPARTMENT OF PUBLIC WORKS

By [Signature] Commissioner.

George E. Thompson  
[Signature] Associate Commissioner.